

AGANLAR BOATYARD
N 37° 00' 49.10" - E 27° 27' 04.44"

BODRUM

GÖKOVA KÖRFEZİ

**KOS
(istanköy)**

DATÇA

DATÇA YARIMADASI

NISOS TILOS

since 1961



KAĞANLAR

THE FULL SERVICE BOATYARD

HAKKIMIZDA

Ağanlar; 1961 yılında Erol Ağan tarafından kurulmuş olup bugün şirketimiz Erol Bey'in oğulları Mazlum ve Erdem Ağan tarafından yönetilmektedir. Ağanların mevcut imalat ve tekne çekek alanı Akdeniz kıyılarının en gözde tatil kenti Bodrum'un, İçmeler Mevkii'ndedir.

Ağanlar Tersanesi her tür ve her amaçlı yat tasarımının, mühendisliğinin, imalatının, tamir, bakım ve konaklama hizmetlerinin verilebildiği bir yer olup, özellikle Bodrum ahşap tekne yapım işinde rakipsiz bir üne sahiptir. Bu işlere ilave olarak tersanemiz; Bodrum da ilk kez uygulanan ve üretilen alüminyum tekne yapım projesini devam ettirmekte olup; Kasım 2010 ayı içinde bu teknemiz denize indirilecektir.

Ağanlar Tersanesi olarak 34,000 m² ve 3 parmak iskeleden oluşan kara park alanımızın inşaatı halen devam etmektedir. Ekim-2010 yılında hizmete girecek bu alanda 450 ton kapasitesi ile Türkiye'nin en yüksek taşıma kapasitesine sahip Travel-Lifti hizmet verecektir. Tersanemizde aile şirketi Sunmarin her tür tekne malzemesi temini yapmaktadır. 40'ı aşkın yetişkin ve tecrübeli personel ile Ağanlar yat sahiplerine her tip tekne projelerinde; "anahtar-teslim" bir hizmet sunmaktadır.

Ağanlar'da 50 yılı aşkın vizyon "*Siz hayal edin, biz de hayallerinizi gerçeğe dönüştürelim!*" olduğu için en yüksek standartlarda, ISO belgemiz ve kalite anlayışımız ile giderek önemi artan bu iş kolunda var olmak, şirketimizin yegane misyonudur.

ABOUT US

Aganlar Boatyard was established in 1961 by Erol AGAN and is presently operated by his sons Mazlum and Erdem AGAN. The yard is located in Bodrum, Mugla in Turkey, on the Mediterranean Shore.

Aganlar is a full service yard specializing in design, engineering, construction, repair and maintenance of all type of yachts but especially traditional wooden yachts. Just recently, we have also started to build the 28 meter, one of the most sophisticated aluminum yachts in Turkey and first aluminum yacht ever built in Bodrum.

Our company offers a complete engineering and design, new construction and classic yacht restoration services along with routine storage, dry docking and maintenance services. In addition to these above, we also have an on-site yacht brokerage office.

Our new 450 Ton Travel Lift allows us to haul out and service yachts of considerable size. The 34,000 square meter of drydocking area has become available soon. In addition to our regular carpentry, painting, rigging and mechanical services, we also offer a high standard chandlery shop owned by the family; Sunmarin Company and a modern painting service. With a highly skilled and versatile 40+ man crew, Aganlar Boatyard offers the yacht owner a "one-stop shopping" destination for any project of any size.

16.02.2011

AHŞABI BİR GULET
ŞEKLİNDE İŞLEYEN
USTA:
EROL AĞAN

Gulet tasarlamak hiç bir zaman kolay bir iş olmamıştır. İşe kendini adanmak, çok çalışmak, ve titizlik ister. Çünkü yapılacak tekne yenilmezliği ve güzelliği ile ünlenmiş "Bodrum Tipi Gulettir." Tamamen ahşaptan yapılan bu tekneler uzun yıllara dayalı çalışmalar ve derinlemesine incelemeler sonucunda elde edilen meşakkatli bir bilgi kümesinin eseridir. Namı meşhur Akdeniz dalgalarının gücüne, sert rüzgarlara dayanmalı aynı zamanda insana kendini evinde hissettiren bir rahatlık içinde yeterince rahat ve geniş olmalı, işçiliği insanı çekerken bir gün batımı bir kuğu misali süzülerek ilerlemelidir..

İşte Erol Ağan böylesi dayanıklı, lüks ve konforlu guletlerin mimarı ve yaratıcısıdır. Sorsalar Türkiye yat ve tekne imalat sektöründe kim kimdir; gerçek bir tekne imalatçısı, yenilikçi ve sektöre kattıkları saymakla bitmez Erol Ağan akla ilk gelen isimler arasında olacaktır. 1936 yılında Bodrum'da doğan Erol Ağan olağan üstü iş geçmişi ve uluslararası tanınmışlığıyla hem gulet tasarımı ve hem de yapımı konusunda artık bulunması oldukça ender ustalardan birisi olarak karşımıza çıkmaktadır.

Ağanlar Tersanesinin kurucusu, kökenleri deniz ve gulet olan bir aileden gelmektedir. O, atalarının ayak izlerini titizlikle ama daha çok çalışarak ve yaratarak izlemiştir. Bu başarısını kimi zaman ustası Ziya'ya kimi zaman da işine olan derin sevgisinde ve çalışma disiplininde aramak gerekir.

Erol Ağan görevlerini ikinci kuşak Ağanlara başarıyla teslim etmekle birlikte çocuklarından birisi gördüğü tersanesini ziyaret etmekten hiç bir zaman kendisini alamamaktadır. Bugün hala onun her sabah düzenli işe gelişini, o çok sevdiği Türk kahvesini çalışanlarla konuşarak içişini seyreden bizler, şirkete kattığı vizyonun ne kadar sarsılmaz olduğunu bilerek ve hissederek çalışıyoruz.

THE MAN WHO MADE
THE MOST FAMOUS
GULETS IN TURKEY
EROL AGAN

Gulets designing never easy work, but with dedication, hard work and study the distinctive type of "Bodrum Gulets" have a reputation for being unbeatable and stylish. To build such wooden-crafted yachts requires pure knowledge which can only be obtained by consistent work, profound study and years of experience. The Bodrum Gulets should withstand the buffeting of the famous Mediterranean waves and sail against the strong winds. Whilst at the same time, below deck it must be large enough for ample, comfortable and homey like accommodation for both guests and crew. It must also have space to provide sufficient storage for all requests and eventualities. Above all it must also be a good craft and fast sailor.

Erol Agan is such a designer and builder whose gulets are well-known for their comfort, luxury, durability, swan looking appearance in the yachting industry. He is considered a true renaissance man, with a resumé that looks like a Who's Who of Turkish Yachting history. Born in Bodrum, Mugla in 1936, he has a distinguished and remarkable career in both the gulet design and build, which is rare to find someone who could move easily from one discipline to another.

He is the founder of the biggest boatyard in Bodrum. Having a family naval background, he followed the same footsteps. After completing his military service he commenced his long-standing career as an apprentice, working alongside the equally well-known gulet builder Master Ziya. He then attained the position of Assistant to the Master. He built more than 100 gulets during all these years.

Erol Agan is well respected and highly thought of amongst his contemporaries and by the new generation of boat building craftsman. His legend continues to flourish with great success and although he has handed over the reign of this family company to the next generation of the Agan family, he still takes an active interest in his brainchild. He is still a familiar presence at the boatyard where he takes his early morning walk and enjoys his regular Turkish coffee with his staff. He may have embarked on his well-earned retirement but his vision lives on through Aganlar Boatyard.

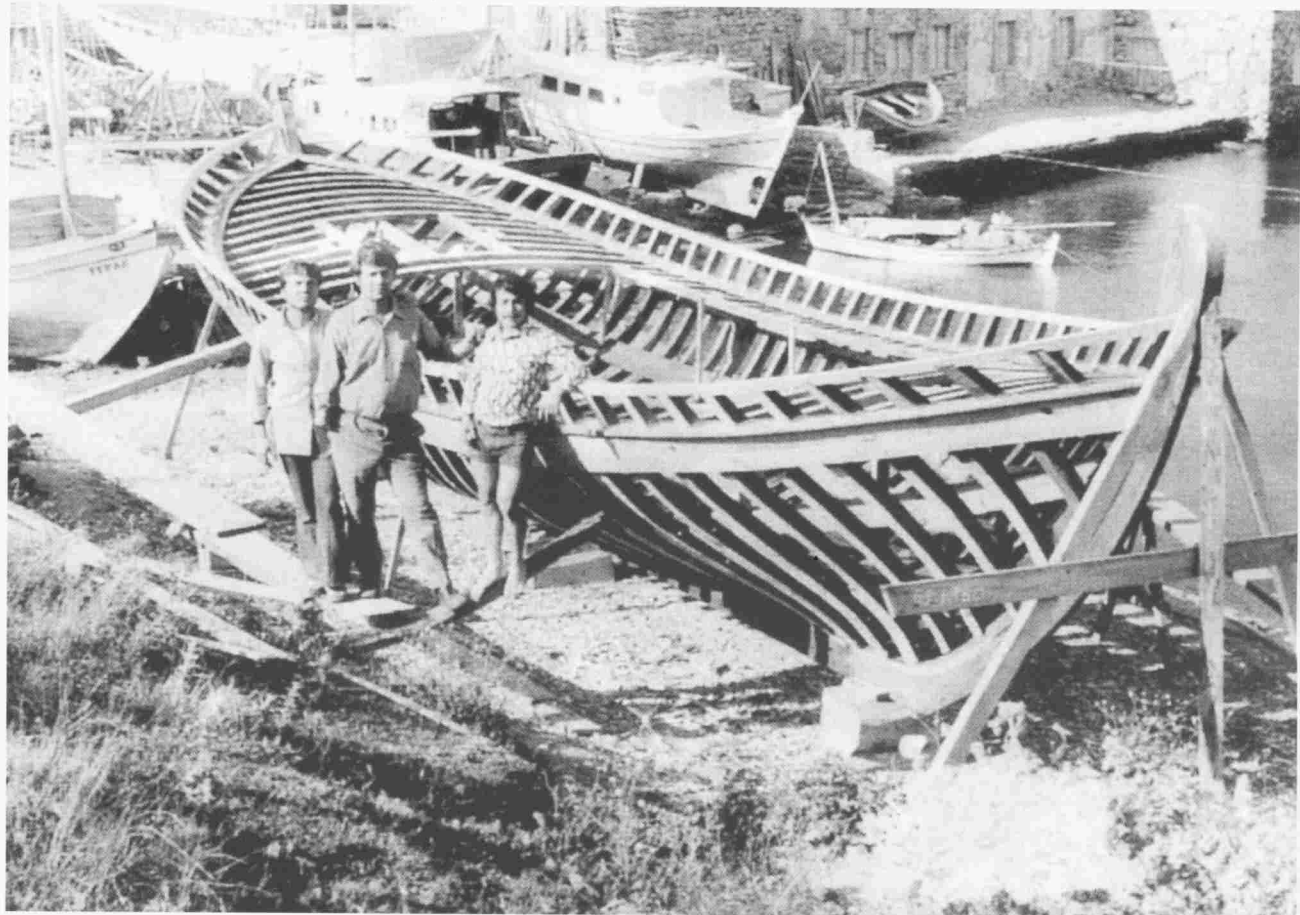

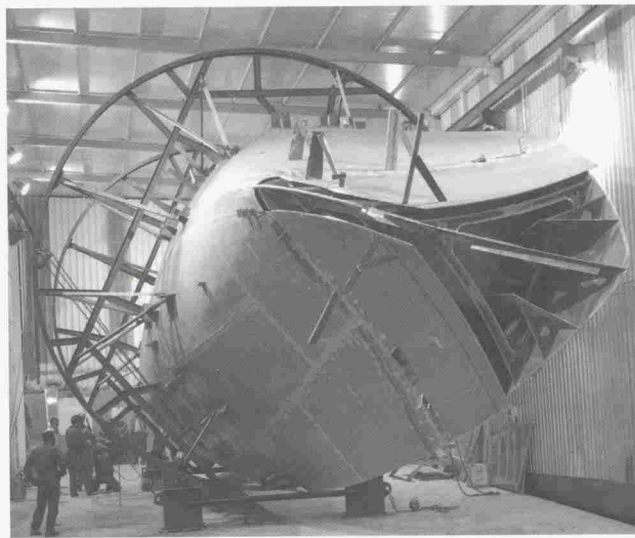
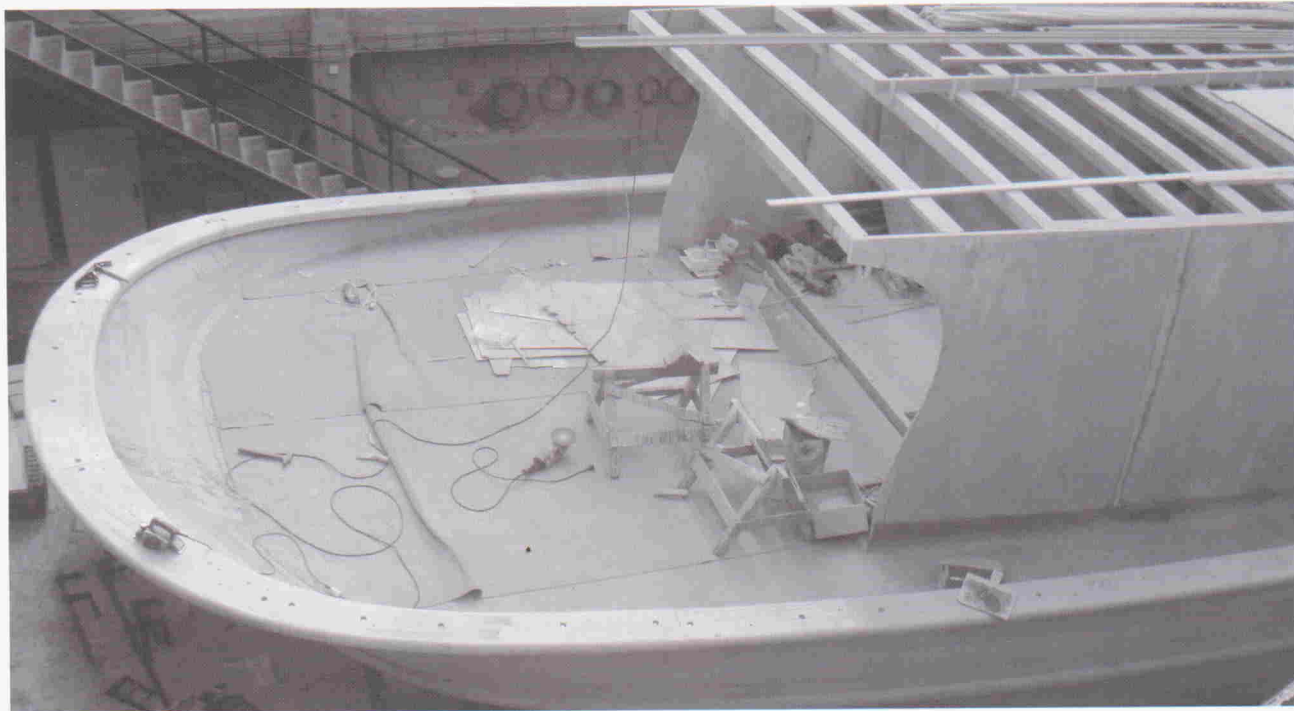

24m Gulet

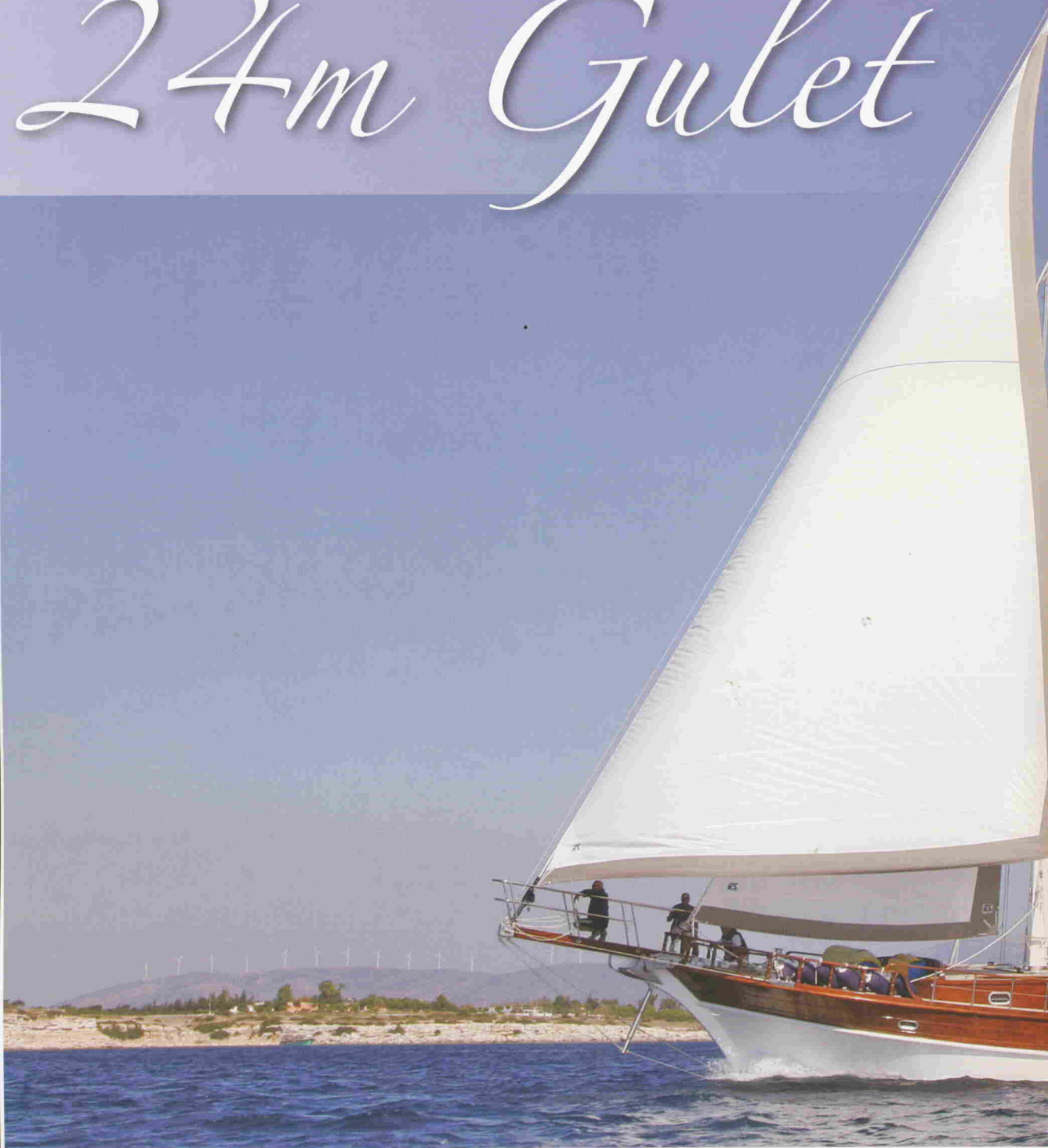



24 M. STANDARD PRODUCTION

TECHNICAL SPECIFICATIONS

General

| | |
|--------------------|-------------------------|
| Designer | Erdem Ağan & Ağanlar |
| Builder | Ağanlar |
| Naval Architecture | A-Marin |
| Type | Motor Sailing Yacht |
| Interior Designer | Aleks Banakis & Ağanlar |
| Year of Delivery | 2010 |

Principal Dimensions

Hull

| | |
|-------------------------|-------------------|
| LOA (inc. Bowspirit) | 26,60 m / 87 ft |
| LOD | 23,90 m / 78 ft |
| BOA | 6,45 m / 21 ft |
| Draft, T | 2,40 m / 8 ft |
| Displacement | 85 tons / 187 lbs |
| Hull Speed | 10 knots |
| Range | 1040 knm |

Sail Area

| | |
|--------|---|
| Main | 108 m ² / 1163 ft ² |
| Genoa | 67 m ² / 721 ft ² |
| Jib | 50 m ² / 538 ft ² |
| Mizzen | 47 m ² / 506 ft ² |

Classification

RINA C+HULLMACH Y

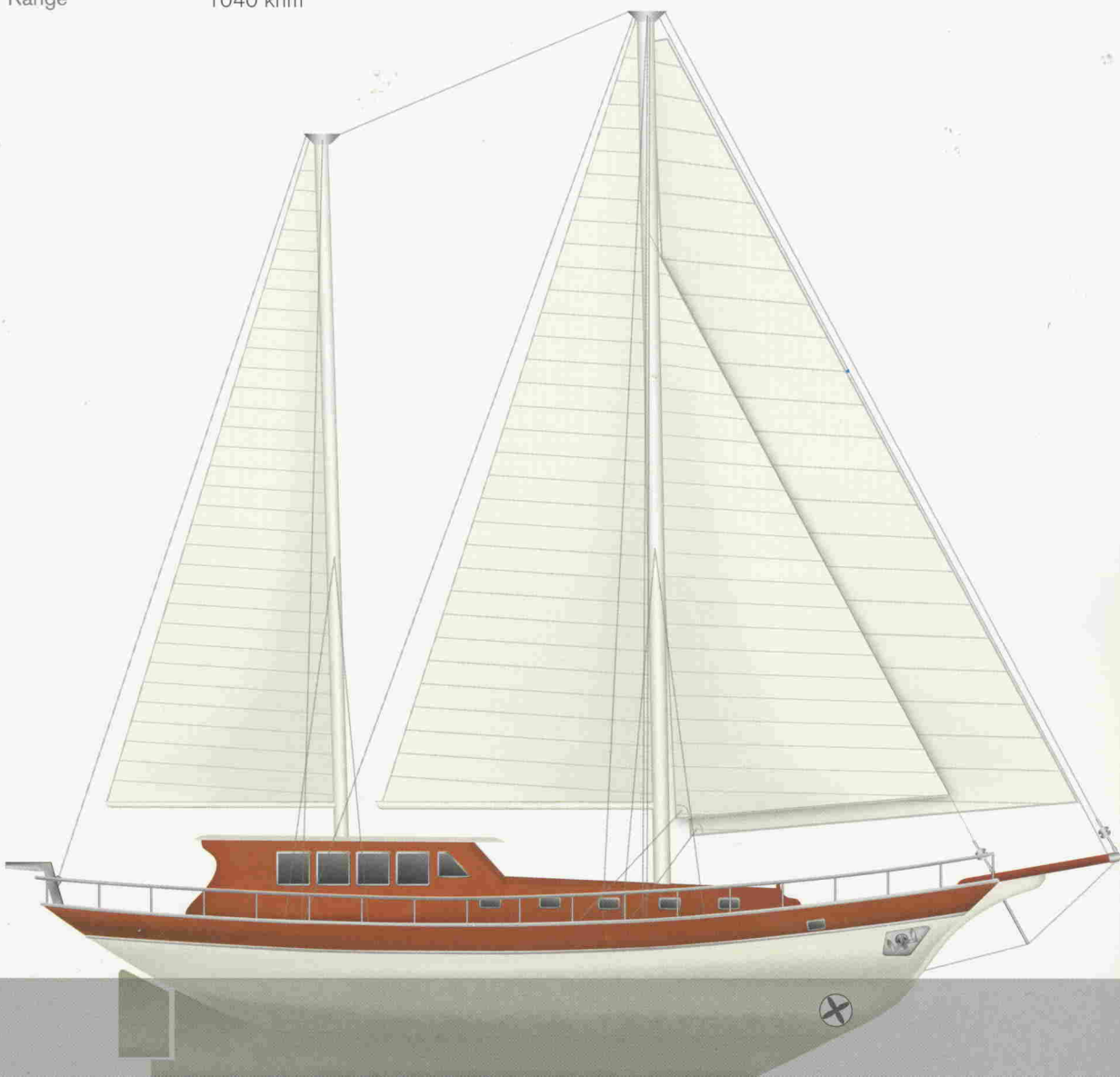

Annabella

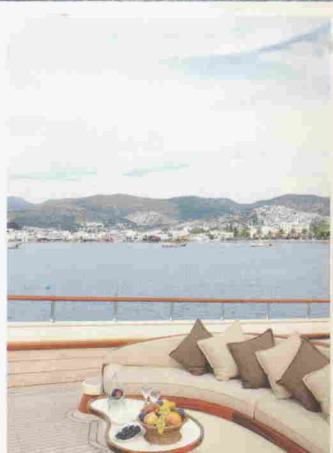
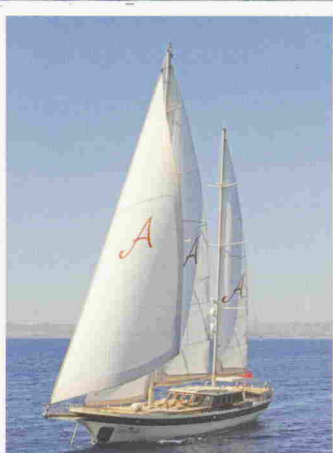

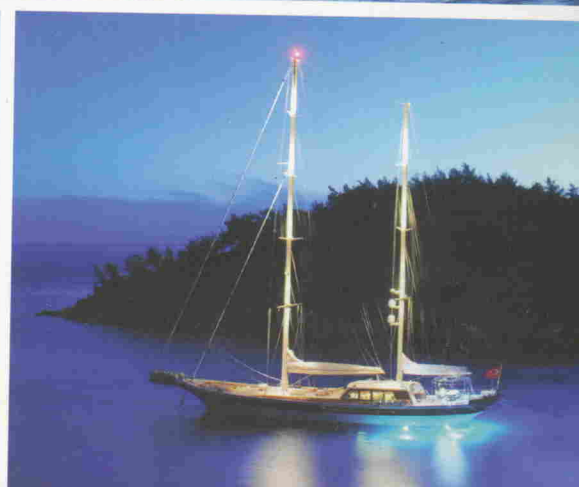
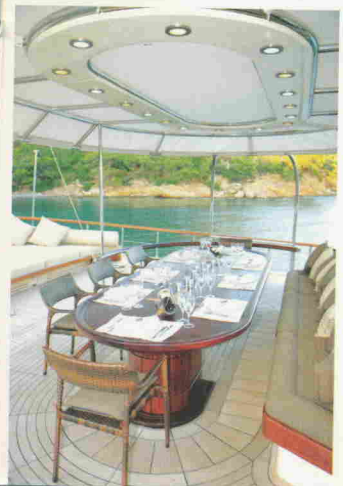
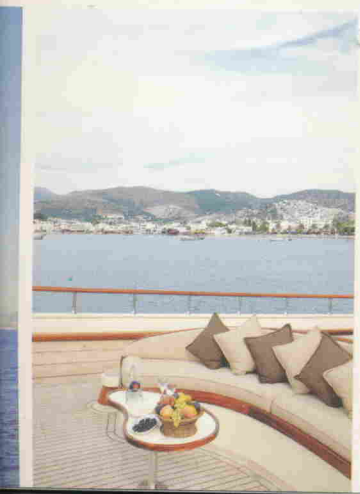

ANNABELLA - TECHNICAL SPECIFICATIONS

General

| | |
|--------------------|-----------------------|
| Designer | Mazlum Ağan & Ağanlar |
| Builder | Ağanlar |
| Naval Architecture | KYD |
| Type | Motor Sailing Yacht |
| Interior Designer | Modus |
| Year of Delivery | 2008 |

| | |
|---------------|--|
| Winches | Harken Hydraulic |
| Furlers | Harken Hydraulic |
| Hatches | Bofor |
| Anchor System | 2 x Damfort 250 kg |
| Spars | Aluminum Spars & Park Ave Booms |
| Paint System | Jotun Paint Systems |
| Pasarelle | Manually operated Stainless Steel |
| Alarm System | Fire Alarm System Epirb |
| Entertainment | Bose Lifestyle Sound System 32" Sony LCD TV TV/Satellite Antenna |

Principal Dimensions

Hull

| | |
|----------------------|--------------------------|
| LOA (inc. Bowspirit) | 45,10 m / 148 ft |
| LOD | 41,00 m / 134 ft |
| BOA | 9,00 m / 30 ft |
| Draft, T | 3,60 m / 12 ft |
| Displacement | 237 tons / 522 lbs |
| Hull Speed | 12 knots - 14 knots max. |

Acomodation

| | |
|--------------------|----------------------------|
| Cabin Arrangement | 1 Owner's Suite + 4 Guests |
| Passanger Capacity | 10 Guests |
| Crew | 7 |

Sail Area

| | |
|--------|---|
| Main | 200 m ² / 2153 ft ² |
| Genoa | 274 m ² / 2949 ft ² |
| Jib | 140 m ² / 1507 ft ² |
| Mizzen | 104 m ² / 1120 ft ² |

Classification RINA C+HULL.MACH Y

Technical Information

| | |
|-------------------|--|
| Construction | Cold Moulded Wood / Epoxy |
| Engine | 2 x 600 hp MAN |
| Gearbox | 2 x 3,5:1 ratio ZF |
| Generators | 2 x 40 + 17,5kW Kohler |
| AC | Marine Air 240,000 Btu Chiller Unit |
| Fridge/Freezer | Local Manufacturer |
| Helm Stations | Outside + Inside Helm Station |
| Watermaker | SR AquaWhisper 12000 lt / day |
| Sewage Treatment | OmniPure 2640 lt / day |
| Navigation & Comm | Raymarine |
| Bow Thruster | 2 x SidePower SP 255 Hydraulic |
| Electrical System | 230V/400 - 50Hz Electrical System 24V/5000W/120A Inverter-Charger Mastervolt Stational Batteries |
| Steering System | Data Autopilot System |
| Windlass | 2 x Data Hydraulic |
| Fuel Tanks | 10,000 lt - Stainless Steel |
| Fresh Water Tank | 8,000 lt - Polyethylene |
| Dirty Water Tank | 10,500 lt - Polyethylene |
| Safety Equipment | 2 x 10 persons life rafts Embarkation Ladder 20 Life Jackets |
| Fire Fighting | Seawater Firefighting System CO2 System - Engine Room Portable Fire Extinguishers |
| Insulation | Class Approved Insulation Package |
| Deckware | Harken |

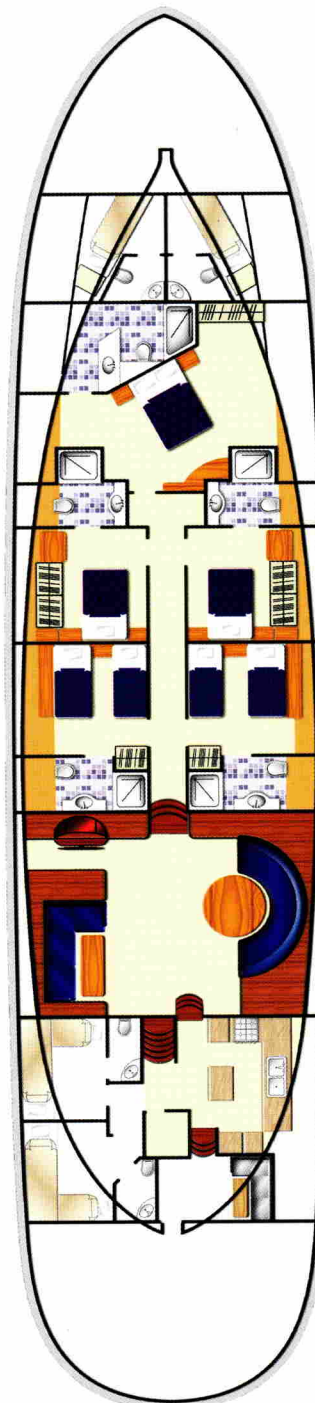

Technical Information

| | | | |
|-------------------|---|------------------|---|
| Construction | Cold Moulded Wood / Epoxy | Safety Equipment | Plastimo 12 person life raft Embarkation Ladder 12 Life Jackets |
| Engine | 2 x 265hp Volvo Penta | Fire Fighting | Seawater Firefighting System Novac 1230 Engine Room Portable Fire Extinguishers |
| Gearbox | 2 x 2,5:1 ratio TwinDisc | Insulation | Class Approved Insulation Package |
| Generators | 2 x 17,5kW Kohler | Deckware | Lewmar / Harken |
| AC | Condaria 72,000 Btu | Winches | Lewmar / Harken |
| Fridge/Freezer | Gaggenau / Siemens 220V | Furlers | Harken / Profurl / Admiral |
| Helm Stations | 1 Outside Helm Station 1 Inside Helm Station | Hatches | Bofor |
| Watermaker | SR AquaWhisper 1700 lt/day | Anchor System | 2 x CQR Galvanized |
| Sewage Treatment | 2 x Raritan 1200 lt/day | Spars | Aluminum Spar Set |
| Navigation & Comm | Simrad / Raymarine | Paint System | International Paint Systems |
| Bow Thruster | SidePower SP 285 48V | Pasarelle | Manually operated Stainless Steel |
| Electrical System | 230V - 50Hz Electrical System 24V/5000W/120A Inverter-Charger Victron 1050A Stational Batteries | Alarm System | Fire Alarm System Epirb |
| Steering System | Data Autopilot System | Entertainment | Bose Lifestyle Sound System 32" LCD TV TV/Satellite Antenna |
| Windlass | Lofrans 3500W 24V Electrical | | |
| Fuel Tanks | 3500 lt - Stainless Steel | | |
| Fresh Water Tank | 3500 lt - Polyethylene | | |
| Dirty Water Tank | 2000 lt - Polyethylene | | |

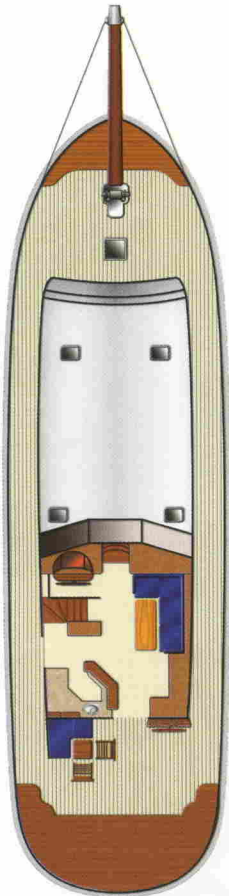

OPTION A 3 CABINS

Passenger Capacity : 6 guests
Guest Quarters : 1 Owner's Suite,
2 Double Staterooms

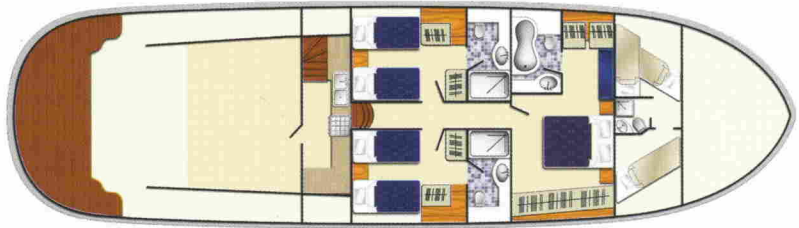

OPTION B 4 CABINS

Passenger Capacity : 8 guests
Guest Quarters : 2 Owner's Suites,
2 Double Staterooms

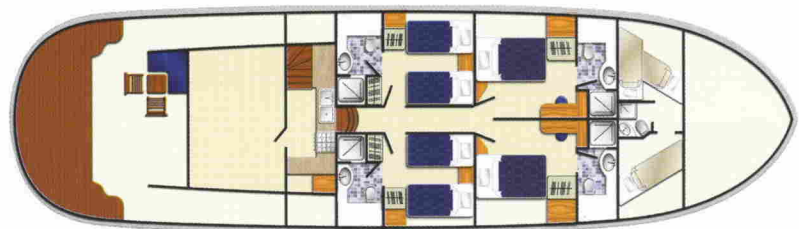



Kestrel



Ron Holland Design



KESTREL - TECHNICAL SPECIFICATIONS

General

| | |
|--------------------|------------------------------------|
| Yard No | 005 |
| Designer | Ron Holland Design |
| Builder | Aganlar Boatyard |
| Naval Architecture | Aganlar & Kerim Acar YD |
| Type | Motor Sailing Yacht |
| Interior Designer | Ron Holland Design & Aleks Banakis |
| Year of Delivery | 2011 |

Principal Dimensions

Hull

| | |
|----------------------|-------------------|
| LOA (inc. Bowspirit) | 32,40 m / 107 ft |
| LOD | 28,50 m / 78 ft |
| BOA | 6,74 m / 22 ft |
| Draft, T | 2,90 m / 9 ft |
| Displacement | 85 tons / 187 lbs |
| Hull Speed | 9,5 knots |
| Range | 1600 kn.m |

Accomodation

| | |
|--------------------|----------------------|
| Cabin Arrangement | 1 Owner's + 3 Guests |
| Passanger Capacity | 8 Guests |
| Crew | 4 |

Sail Area

| | |
|--------|---|
| Main | 120 m ² / 1292 ft ² |
| Genoa | 230 m ² / 2476 ft ² |
| Jib | 80 m ² / 861 ft ² |
| Mizzen | 140 m ² / 1507 ft ² |

Classification

RINA C+HULL.MACHYch
MCA LY2

Technical Information

| | |
|-------------------|--|
| Construction | Complete Aluminum |
| Engine | 350 hp Scania |
| Gearbox | 2,04:1 ratio TwinDisc |
| Generators | 2 x 28kW Kohler |
| AC | Marine Air 96,000 Btu Chiller Unit |
| Fridge/Freezer | Gaggenau / Miele 220V |
| Helm Stations | 1 Outside Helm Station 1 Inside Helm Station |
| Watermaker | SR AquaWhisper 1700 lt/day |
| Sewage Treatment | OmniPure |
| Navigation & Comm | Simrad |
| Bow Thruster | Lewmar |
| Electrical System | 230V - 50Hz Electrical System 24V/5000W/120A Inverter-Charger Mastervolt 1200A Stational Batteries |
| Steering System | Mamba Whitlock |
| Windlass | Data Hydraulic |
| Fuel Tanks | 7,400 lt |
| Fresh Water Tank | 3,200 lt |
| Dirty Water Tank | 3,650 lt |
| Safety Equipment | Plastimo 12personlife raft Embarcation Ladder 16 Life Jackets |
| Fire Fighting | Seawater Firefighting System CO2 System - Engine Room Portable Fire Extungishers |
| Insulation | Class Approved Insulation Package |
| Deckware | Lewmar |
| Winches | Lewmar |
| Furlers | Harken |
| Hatches | Bofor |
| Anchor System | 2 x CQR Galvanized |
| Spars | Aluminum Spar Set |
| Paint System | International Paint Systems |
| Pasarelle | Manually operated Stainless Steel |
| Alarm System | Fire Alarm System Epirb |
| Entertainment | Bose Lifestyle Sound System 32" LCD TV TV/Satellite Antenna |





HİZMETLERİMİZ

FACILITIES

- 450 ton kapasiteli Travel Lift
- 34.000 m² Çekme Alanı
- Refit
- Bakım - Onarım
- Marina Hizmetleri

- 450 tons capacity TravelLift
- 34.000 m² Drydocking Area
- Refit
- Maintenance
- Marina Services



