



FARMONT  
YACHTS



Modern yacht building in the explorer category has a name: FARMONT. The German company is in the process of making its mark on the future of ocean-going yacht building. For the first time in Europe, explorers are now being semi-custom built. The new FARMONT shipyard is capable of building up to eight high-tech quality yachts per year with lengths to 38 meters / 124' 67".

The innovative FARMONT explorers with hulls made of epoxy fibreglass are light and durable - ideal for adventurous seafarers. Equipped for all the oceans of the world, including Arctic waters, they outwardly display a clarity of line, with interiors of visible class. This is where beauty, functionalism and seaworthiness are combined in a yacht strategy that sets new standards.

FARMONT yachts are dependable, timeless and designed for extreme ranges. They offer the owner every conceivable convenience and maximum safety. And plenty of power for voyages into uncharted waters.



YACHTS OF A NEW DIMENSION:  
FLAWLESS AND TIMELESS







A strong engineering team with decades of experience develops yachts that combine aesthetics and ergonomics, efficiency and comfort. Renowned naval architects have given FARMONT yachts their characteristic form. The engineers have succeeded in reconciling extreme stability, safety and straightforward handling.

The international design team is committed to absolute perfection, down to the finest detail. The designers are only satisfied when the optimum solution has been found for each detail of the interior and for all ergonomic and technical components. So that the owner and his guests can enjoy their grand ocean adventure in comfort and safety.

27. 01. 2009





The interior of the illustrated FARMONT yacht embodies many years of experience of metrica interior's professionals. The supreme craftsmanship melds with a wealth of accumulated skill in all aspects of ship's interiors, particularly when it comes to making effective use and attractively designing every nook and cranny aboard ship - with mahogany, cherry, teak and other woods.

FARMONT yachts are distinguished by their inviting atmosphere, plenty of space and comfort. All these are important essentials for long ocean voyages during which the deck saloon, main deck and cabins will become home to the owner and his guests for months at a stretch. So that everyone can keep a clear head at all times, all the rooms of FARMONT yachts are designed accordingly.



## FARMONT 70 - Main Characteristics

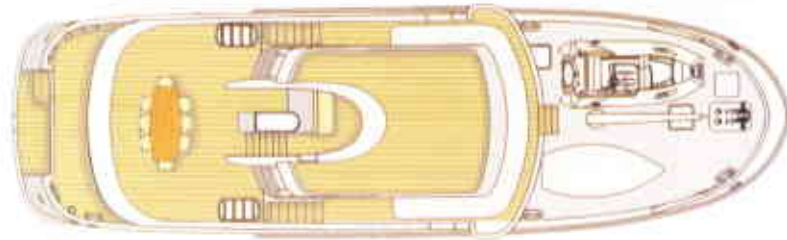

sundeck



upperdeck

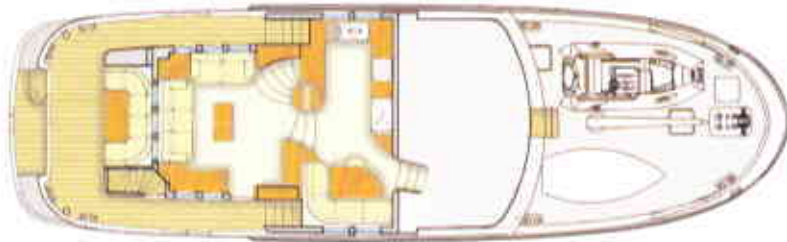

maindeck

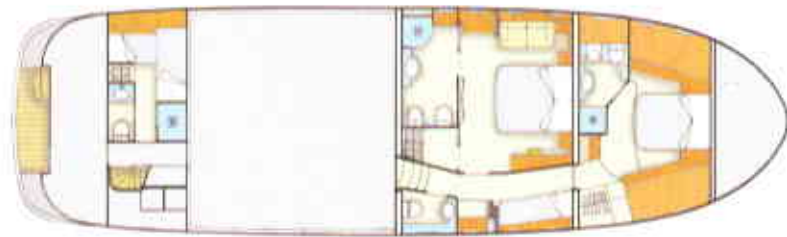

lowerdeck

Builder:	Farmont Yachts GmbH & Co KG
Naval Architect:	Kerwin Naval Architects, Inc.
Exterior Stylist:	René van der Velden
Interior Designer:	Joachim Kinder
Length overall:	21.32 m - 70'0"
Length waterline:	20.50 m - 67'3"
Beam:	6.20 m - 20'3"
Draft (half load):	1.50 m - 4'9"
Displacement:	80 t full load
Construction material:	GRP epoxy / E-glass composite
Berths / cabins:	7 in 4 + 1
Main engines:	2 Cummins QSM11, each 300 hp / 224 kW @ 2,100 rpm/h or 2 CAT 3406C, each 300 hp / 224 kW @ 1,800 rpm/h
Propeller:	4 blades
Speed:	12 kn max., 11.5 kn cruising
Fuel:	22,000 l / 5,812.40 US gal.
Fresh water:	1,900 l / 501.98 US gal.
Grey water:	1,900 l / 501.98 US gal.
Black water:	1,900 l / 501.98 US gal.
Range:	approx. 4,000 nm at 10 knots with 10% reserve

*subject to changes*





## FARMONT 85 - Main Characteristics

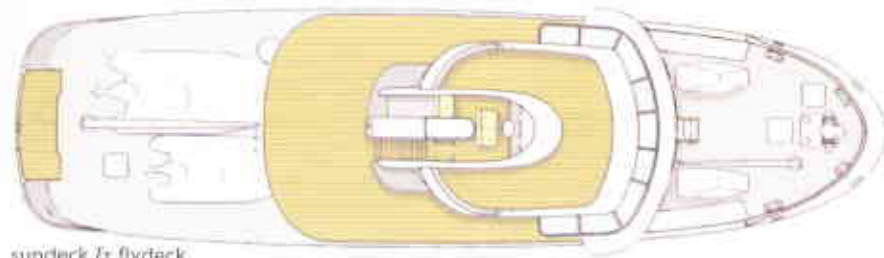

sundeck & flydeck

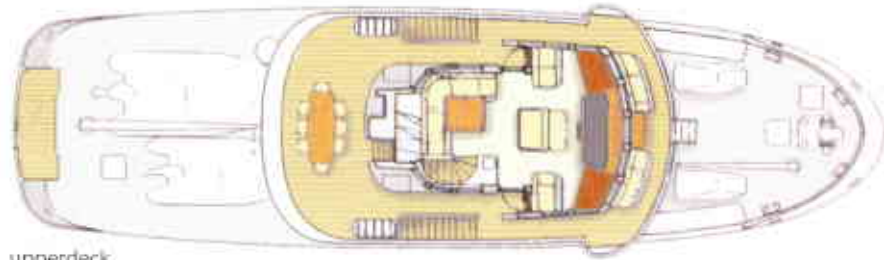

upperdeck

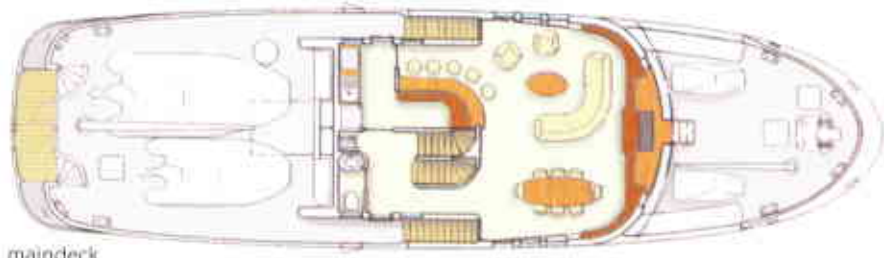

maindeck



lowerdeck

Builder:	Farmont Yachts GmbH & Co KG
Naval Architect:	Kerwin Naval Architects, Inc.
Designer:	René van der Velden
Length overall:	25.91 m / 85'0"
Length waterline:	24.44 m / 80'2"
Beam:	7.00 m / 23'0"
Draft (half load):	2.00 m / 6'7"
Displacement:	150 t full load
Construction material:	GRP epoxy / E-glass composite
Berths / cabins:	10 in 5
Main engines:	2 Caterpillar 3406C, each 480 hp / 358kW @ 2,100 rpm/h
Propeller:	4 blades
Speed:	12.8 kn max., 12 kn cruising
Fuel:	27,000 l / 7,133.40 US gal.
Fresh water:	2,000 l / 528.40 US gal.
Grey water:	1,900 l / 501.98 US gal.
Black water:	1,900 l / 501.98 US gal.
Range:	approx. 4,600 nm with 10% reserve

*subject to changes*





sundeck & flydeck

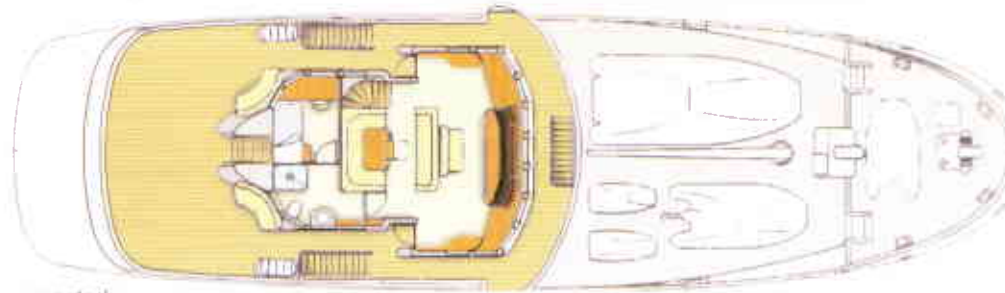

upperdeck



maindeck



lowerdeck



Naval Architect: Kerwin Naval Architects, Inc.  
 Designer: René van der Velden  
 Length overall: 32.30 m / 106'0"  
 Length waterline: 31.00 m / 101'8"  
 Beam: 8.00 m / 26'3"  
 Draft (half load): 2.00 m / 6'7"  
 Displacement: 218 t full load  
 Construction material: GRP epoxy / E-glass composite  
 Berths / cabins: 12 in 6



alternative maindeck

Main engines: 2 Caterpillar 3406C, each 480 hp / 358 kW @ 2,100 rpm/h or  
 2 Caterpillar 3406C, each 540 hp / 403 kW @ 2,100 rpm/h  
 Propeller: 4 blades  
 Speed: 14 kn max., 12.5 kn cruising  
 Fuel: 49,000 l / 12,945.80 US gal.  
 Fresh water: 10,000 l / 2,642.00 US gal.  
 Grey water: 2,000 l / 528.40 US gal.  
 Black water: 2,000 l / 528.40 US gal.  
 Range: approx. 5,000 nm with 10% reserve

*subject to changes*

Interior designer: J. KINDER

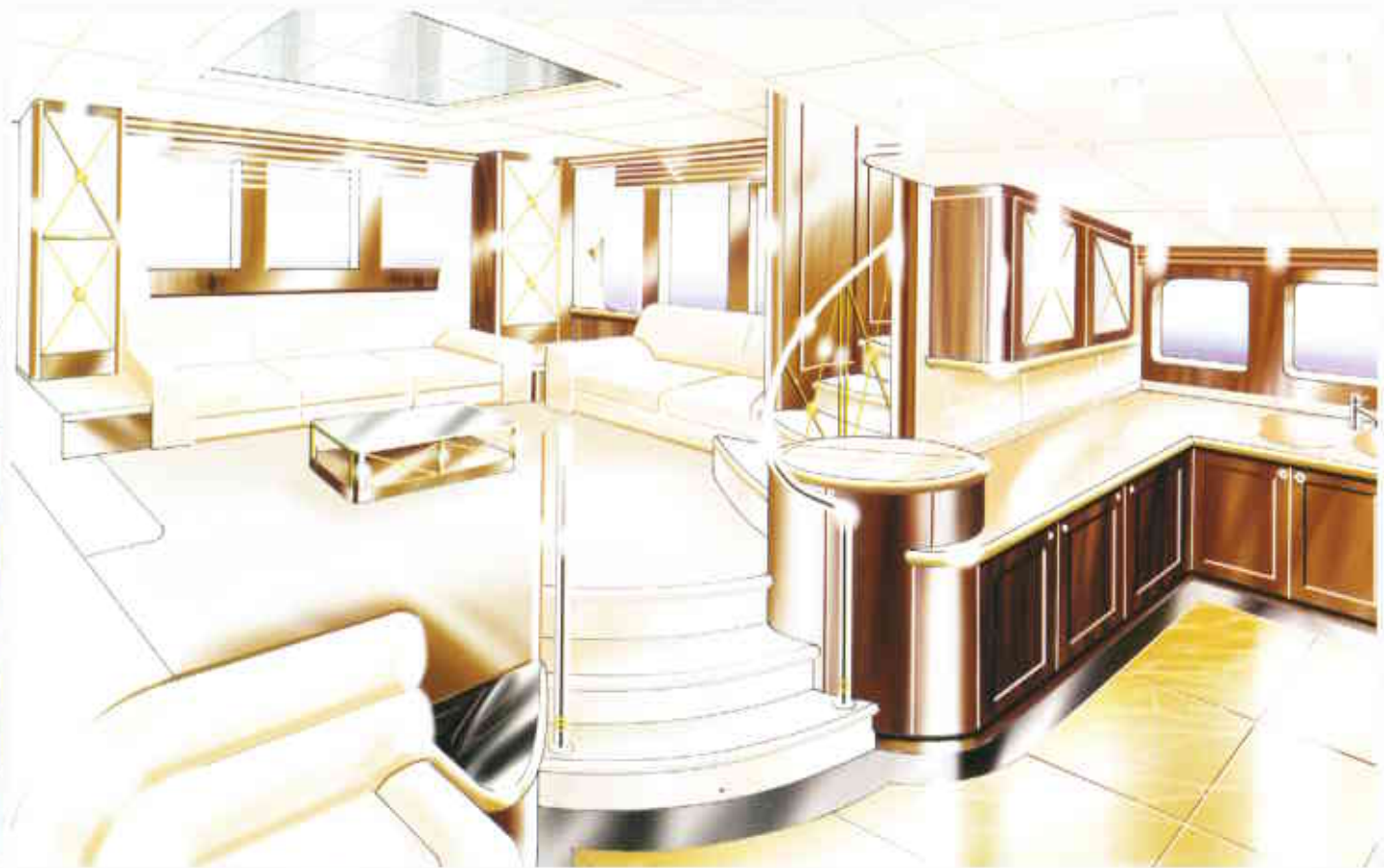





Plenty of living space. This is what the ocean-going seafarer expects also of his cabins. A sensible layout is an important factor, particularly if the yacht is to be chartered. The FARMONT 85, for example, accommodates six guests in three cabins, each with its own bathroom, as well as providing a separate crew area with a bathroom and dinette for four. However, the modular strategy also envisages a guest area for eight and a cabin for a crew of two. Because, thanks to their straightforward handling, FARMONT yachts require only the smallest crew and are even suitable for single-handed sailing.

The semi-custom principle offers the owner many solutions based on tried-and-tested designs from renowned naval architects. The hull design and equipment, for instance, are adopted from successful FARMONT yacht types. Personal requests, not only concerning layout and interior finish, are incorporated as long as they comply with classifications. This strategy assures the owner of all the quality features and advantages of a FARMONT yacht - a stylish ambience to suit his personal taste, and savings of expense in the planning, design and building of his yacht.

Whether semi-custom or custom built: Quality design, maximum economy and extreme safety are always top priority - along with highly satisfied owners who take pleasure in the quality and value of their yachts.



## PLENTY OF LIVING SPACE

## INDIVIDUALISM AND CLASS RIGHT DOWN THE LINE



What you do see is the clarity of line of FARMONT yachts. What you don't see are the many advantages that become apparent during a long sea voyage. First of all, there is the hull made of epoxy fibreglass, a material with an impressive record in aerospace. It makes FARMONT yachts lighter, more durable, stronger and safer. Epoxy fibreglass also means a shallower draught and trouble-free lifting of the yacht for work in the dry dock. Another benefit is the easy cleaning of the attractive surface.





## FULL SPEED AHEAD INTO THE FUTURE

FARMONT explorer yachts have all the modern electronics and navigation gear on board that make a high-tech vessel dependable and safe. They also have the requisite muscle in the shape of two powerful diesel engines fuelled by an up to 50,000-litre tank for rapid progress and long ranges.

“Full Speed Ahead” is hence the motto of the international team at the FARMONT shipyard in Antalya, Turkey, with its 22,000 square metre site, pier and direct access to the water. Setting trends in international yacht building, these out-and-out professionals go about their work with experience and enthusiasm and a commitment to the special quality of FARMONT yachts. Building classics that people will be just as enthusiastic about in 20 years time as they are today.







Building prestige yachts is our passion,  
satisfying clients our motivation.  
Always there for you:

Your FARMONT YACHT team



FARMONT



YACHTS