

SARIBEY

MARITIME

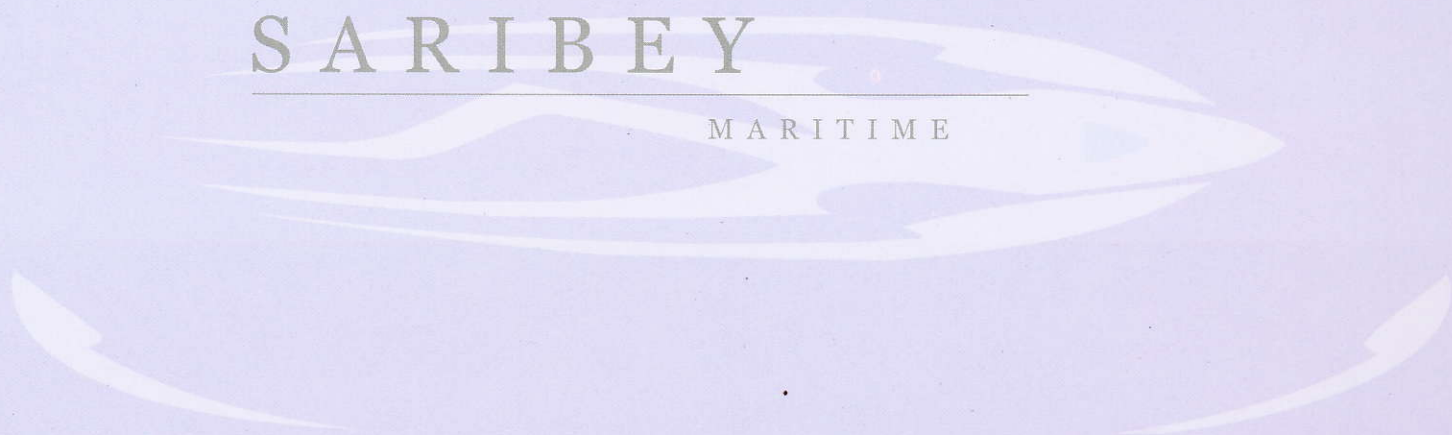

SRB 33 F CANAL BOAT

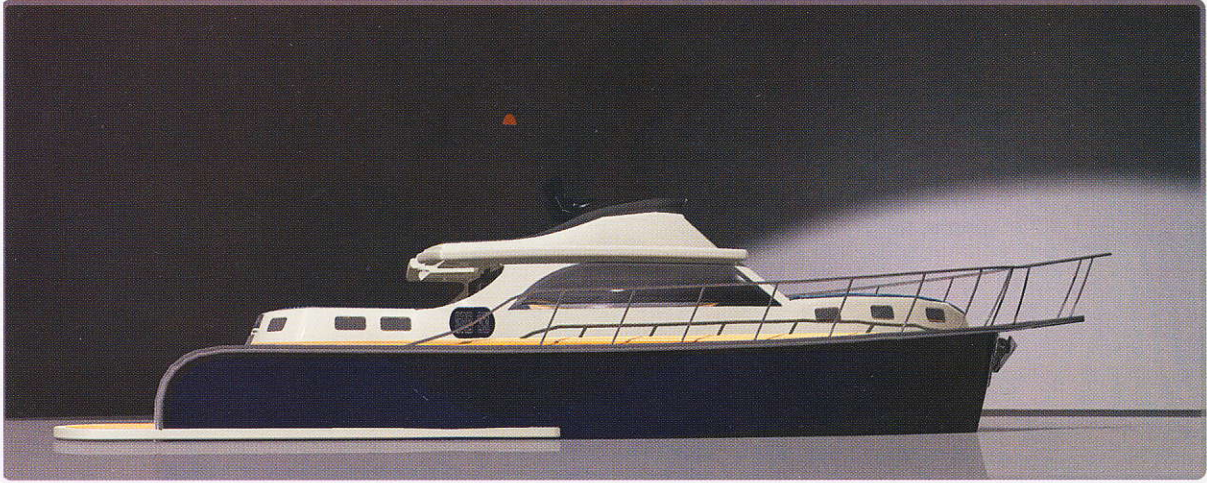

E SRB33 is a full functional luxury yacht . She was developed using latest GRP material and in accordance with our nautical know how based on 20 years of experience in the industry.

W SRB33 has a unique and spectacular design for channel and shore usage.

C SRB33 is suitable for 4 guests with 2 superior cabins.

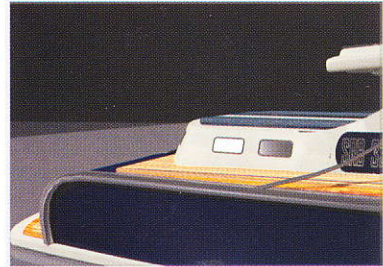

I SRB33 's interior is designed to fulfil your high comfort necessities. Cabins amenities makes you feel no different than your residence. Horizontal lines concept used, deepens both cabins and gives you extra space feeling for your relaxing times. Equipments used in her are chosen with an elegant eye for your cruising pleasure.

Our difference is relevant to your imagination. You imagine and we accomplish.

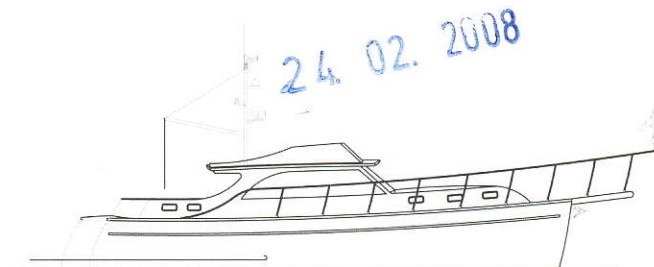

PROFILE

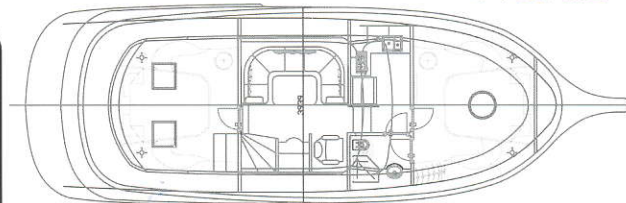

MAIN DECK

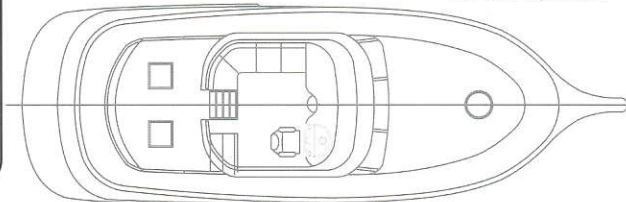

UPPER DECK

Length of overall	LOA : 10,80 meters
Length water line	LWL : 9,78 meters
Beam	B : 3,62 meters
Height	H : 3,39 meters
Deep	D : 1,40 meters
Draft	T : 1,05 meters
Displacement	V : 12,00 tones
Fuel tank capacity	: 1200 liters
Water tank capacity	: 1000 liters
Max number of people	: 4+1
Engine	: 2 X YANMAR 115 HP
Speed	: 14 Knots Max and 11 Knots Cruise

Designed By



www.saribey.com



NO	ITEM / DESCRIPTION	REMARK
1	GENERAL DESIGN & MANAGEMENT	
2	DESIGN	Montana Design One Ship Building Engineer As Project Manager, Two Engineers For Site Surveys And Class Following
3	PROJECT MANAGING	
4		
5	CLASSIFICATION	
6	CLASSIFICATION	CE
7	SURVEY, TEST & CERTIFICATE	Germannischare Lloyd
8		
9	HULL / DECK CONSTRUCTION	
10	MATERIAL	GRP, 14 Coats For Underwater And 10 Coats For Hull, Epoxy
11	WINDOWS	Wood Composite Superstructure Tempered Glass And Mahogany Frames
12	DOORS AND OPENINGS	Wooden Doors And Aluminium Hatches
13		
14	PAINT & FAIRING	
15	HULL INSIDE PAINT, PRIMER, EPOXY FAIRING 5 MM AVERAGE THICKNESS, TOP COAT PRIMER, TOP COAT PU	International products
16	UNDERWATER COATING	International
17	INTERIOR	
18	PLYWOOD	Mahogany
19	SOLID WOOD	Mahogany
20	STUDWORKS & TEMPORARY MATERIALS	HAFELE
21	INSULATION BULKHEADS	30 MM Rockwool- A 80 Class
22	GLUE, SCREW, BOLTS DOOR HANDLES, DOOR STOPS, LOCKS, GRILLS, TEFLON STRIPS, GENERAL FINISH ACCESSORY FITTINGS, LOCKER HANDLES, BARS, RAILS, SNAP ON FITTINGS	Stainless Steel And Sikaflex
23	FLOATING FLOOR MATERIALS & ELASTIC CUSHIONS	HAFELE door handles and connection accessories Sani Foam
24		
25		
26	GENERAL MANUFACTURED OUTFITTING	
27	ALUMINUM FRAMED, SLIDING OPENING WINDOWS	6 OF 500X300
28	PORTHOLES - CUSTOM MAKE 400X250 OVAL	CIRCULAR- 316 SS
29	DECK HATCHES	700x700 Mm
30	STANCHIONS, 800 MM INTERVAL, DIA 32 316 SS	
31	BOLLARDS	4, 600X250X300H, Stainless Steel
32	FAIRLEADS	4, Of Double Sheave And Chafing
33	SWIMMING LADDERS, SHIPTYPE WITH CONTROL PC	2, 1of Each Side
34	AFT TRANSOM WINDOWS	In stainless steel
35	ANCHOR POCKETS & HAWSE PIPES IN SS316	To be inserted in hull shell
36	FLAG POLE SS IN AFT DIA 60 MM	Stainless steel
37	TABLE BASES	1 Fix in and out
38	BIMINI TOP	Bimini top at flybridge
39	BAR EQUIPMENT	1 in saloon and 1 in flybridge in the stack
40	ENGINE ROOM	
41	MAIN ENGINE	YANMAR 115 Hp with ZF reduction gear
42		
43	PROPULSION SYSTEM FOR ENGINE	Shaft 70MM, Rubber bearings - Brass Propeller
44	EXHAUST SYSTEM	Silencer, Hoses, -clamps, expansion, insulation, hull fittings
45	SEA WATER SYSTEM	Sea chest, water filter, fittings, hoses & clamps
46	ENGINE CONTROL SYSTEM	Morse Single Control Handle With Conduit Wiring
47	ENGINE CONTROL SYSTEM	Electronic, Morse Remote Shut Off Valve, Fuel Filter Racor Twin Cartridge Fuel Hoses And Crimping, Valves & Fittings, Return Hoses And Crimping With Ss Fittings, Twin Filling Stations, Air Vent With Wire Mesh, Inspection Hatches, Paralel Line Outlets, Mechanical Level Gauges
48	FUEL SYSTEM	Fire Batt Rockwool, Sound Proofing Layer Insulation & Perforated Aluminum Surface Treatment
49	FUEL TANKS, INTEGRATED TO HULL STRUCTURE	One On Bow Bulkhead, one emergency to saloon.
50	ENGINE ROOM INSULATION	
51	ENGINE ROOM WATERTIGHT DOORS	
52		
53		
54	PLUMBING	
55	FIRE & BILGE SYSTEM PIPING AND VALVES	Pvc- U
56	DISCHARGE LINE FITTINGS AND PIPING	REINFORCED PLASTIC HOSE & SS CLAMPS
57	FRESH & HOT WATER PIPING	Pe Piping With Brass Fittings
58	TANK LEVEL GAUGES - VEMA SYSTEM	Fw, Gw, Bw, Fuel
59	TANK LEVEL ALARMS	AYVAZ - LOW - HIGH
60	BILGE ALARMS	Jabsco / Rule
61	GENERAL CONSUMABLES	Sikaflex, Glue, Teflon Band Etc
62	DECK WASH OUTLETS DECK SHOWER OUTLETS	
63	ELASTIC HOSES AND SERVICE VALVES	
64	UV FILTERING	
65	WATER TANKS FILLERS, SERVICE HATCHES, AIR VENTS, FITTINGS, SUCTION HEADS INTEGRAL FRESH AND DIRTY WATER TANKS, WITH SPECIAL EPOXY COATINGS	2 Tons Of Water, 0.5 Tons Of Grey, 1.0 Tons Of Black Water
66	CHAIN WASHING OUTLET & CONTROLS	
67		
68		
69	ELECTRICAL	
70	GENERATOR SET	1 Of Onan 8 kva
71	FUEL, EXHAUST & SEA WATER SYS. FOR GEN SETS	(water & gas separation)
72	BATTERY BANKS	Stationary Batteries 4x200ah
73	START BATTERIES FOR MAIN ENGINE AND GENSET	2 OF 165 Ah
74	24V/100 AH BATTERY CHARGER, 2500 W INVERTER, 24/12 CONVERTER, 12 V BATTERY CHARGER 50 A	
75	DISTRIBUTION PANELS	24v/220 V At Console Main In E/R -3
76	CABLE TRAYS & CABLES	Marine Grade
77	SHORE CONNECTIONS	Marinco
78	SWITCHES & PLUGS - VIMAR	
79	MAIN CONSOLE PANELS	Aluminum / Wood With Switches
80	CEILING LIGHTS, DECORATIVE LAMPS, NAVIGATION LAMPS WITH DIMMERS	
81	ENGINE ROOM AND BILGE LIGHTS	
82		
83	GENERAL OUTFITTING	

84	WINDLASS	Electrical Lofranz, 1500 w
85	ANCHOR & CHAIN	1'45 Kg, Dia 12 Chain 100m
86	STEERING CYLINDER AND PUMPS	2 Station And Single Cylinder
87	ELECTRICAL TOILET HEADS	Teema 2 pieces
88	FIXED FIRE FIGHTING SYSTEM WITH REMOTE CONTROL & ALARMS	CO2 System
89	AIR CONDITIONING SYSTEM WITH ELECTRONIC CONTROLS AND CONSISTENT AIR GRILLS AND HOSES (OPTIONAL)	3 units Cruise air, toally 14,000 BTU
90	SEARCH LIGHT	JABSCO 1000 W
91	HORN	Marco - Dual
92	HELMSMAN SEATS IN CONSOLE	1 Stool Outside
93		
94	BATHROOM EQUIPMENT	
95	BATHROOM CLADDING	Natural stones and laquering
96	BATHROOM WORKTOPS AND GALLEY WORKTOP IN MARBLE	Night Sky natural stones
97	ACCESSORIES (TOWEL RACKS, PAPER HOLDER, SOAP DISH, BRUSH HOLDER, GRIP HANDLE, GLASS HOLDER)	HAFELE equipments
98	MIRRORS	Crystal
99	SHOWER TRAY & BATH TUB, SINKS CERAMIC	Ceramic sink and GRP tray
100	SHOWER PANELS WITH CLEAR GLASS	Alu Framing
101		
102	GALLEY EQUIPMENT	
103	MICROWAVE OVEN	Bosch
104	ELECTRICAL OVEN	Bosch
105	REFRIGERATOR	Bosch
106	EXTRACTOR FAN - INDUSTRIAL TYPE	Bosch
107	STAINLESS OR ACRYLIC SINK & TAP	
108	WINE COOLER	For 6 bottles
109		
110	ELECTRONICS & NAVIGATION - 2 STATION	
111	AUTOPILOT (OPTIONAL)	Simrad
112	RADAR, DEPTH SOUNDER, CHART PLOTTER	Garmin compact unit
113	RADAR ANTENNA 24 NM (OPTIONAL)	Garmin
114	VHF - DUAL STATION	Simrad
115	MAGNETIC COMPASS -2	Ritchie Or Equivalent
116	CHART LIGHT	
117	SART & EPIRB (LIFE SAVING ELECTRONICS)	
118		
119	SALOON	
120	SOFA	Anegre and Vakko Cruise for 4 persons
121	TABLE	Anegre and palesenk with riseble stainless leg
122	CEILING	Vakko Cruise with hand made marcutary art cottonpierre.
123	FLOORS	Varnished wood and decorative nonslipperycarpets
124	FRIDGE	Bosch, 50 lt
125	TV	Sony, 32" plasma
126	DVD PLAYER	Sony
127	AMPLIFIER	Bose
128	SPEAKERS	5+subwoofer, home theatre system - BOSE
129	CD PLAYERS WITH RADIO IN EACH CABIN	Sony
130		
131	MASTER CABIN	
132	BED	King Size Latex
133	TABLE	Mahogany with riseble stainless leg
134	MAKE UP TABLE	Mahogany
135	WARDROPES	Mahogany
136	CUPBOARDS	Mahogany
137	SAFE	1 Pc, electronic and mechanic
138	CEILING	Vakko Cruise
139	FLOORS	Varnished wood and decorative nonslipperycarpets
140	FRIDGE	Bosch, 35 lt
141	TV	Sony, 21" plasma with hideble automatic mechanism.
142	DVD PLAYER	Sony
143	AMPLIFIER	Bose
144	SPEAKERS	4+subwoofer, surround system - BOSE
145	CD PLAYERS WITH RADIO	Sony
146	BATHROOM CLADDING	Natural stones and laquering
147	BATHROOM WORKTOPS AND GALLEY WORKTOP IN MARBLE	Night Sky natural stones
148	ACCESSORIES (TOWEL RACKS, PAPER HOLDER, SOAP DISH, BRUSH HOLDER, GRIP HANDLE, GLASS HOLDER)	HAFELE equipments
149	MIRRORS	Crystal
150	SHOWER TRAY & BATH TUB, SINKS CERAMIC	Ceramic sink and GRP tray
151	SHOWER PANELS WITH CLEAR GLASS	Alu Framing
152		
153		
154	QUEST CABIN	
155	BEDS	2 X Single Latex
156	WARDROPES	Anegre and palesenk with marcutary art studies on them Anegre wood with palesenk decorated and HAFELE acceories
157	CUPBOARDS	Vakko Cruise
158	CEILING	Varnished wood and decorative nonslipperycarpets
159	FLOORS	Varnished wood and decorative nonslipperycarpets
160	TV	Sony, 16" plasma
161	DVD PLAYER	Sony
162	AMPLIFIER	Bose
163	SPEAKERS	2+subwoofer, surround system - BOSE
164	CD PLAYERS WITH RADIO IN EACH CABIN	Sony
165	PLAYSTATION	playstation 3
166	BATHROOM CLADDING	Natural stones and laquering
167	BATHROOM WORKTOPS AND GALLEY WORKTOP IN MARBLE	Night Sky natural stones.
168	ACCESSORIES (TOWEL RACKS, PAPER HOLDER, SOAP DISH, BRUSH HOLDER, GRIP HANDLE, GLASS HOLDER)	HAFELE equipments
169	MIRRORS	Crystal
170	SHOWER TRAY & BATH TUB, SINK	Ceramic sink and GRP tray
171	SHOWER PANELS WITH CLEAR GLASS	Alu Framing

SRB 40 F LOBSTER YACHT

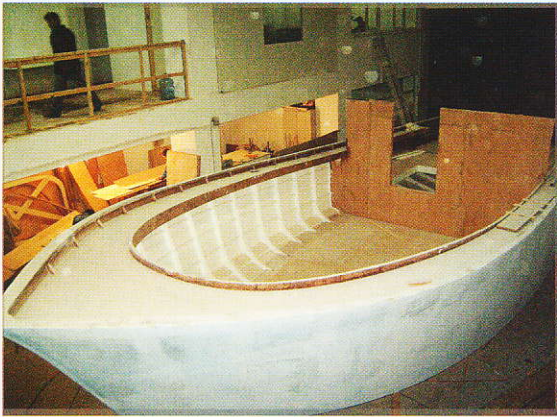

E SRB40 F is a full functional lobster yacht. Her design is classical and ideal for coast cruises.

W SRB40 F is perfect for families with her modern and safe design.

C SRB40 F has 2 luxury cabins for 4 guests to accomodate.

I SRB40 F 's interior has a warm and cozy atmosphere for your cruising pleasure.

Our difference is relevant to your imagination. You imagine and we accomplish.

24.02.2008

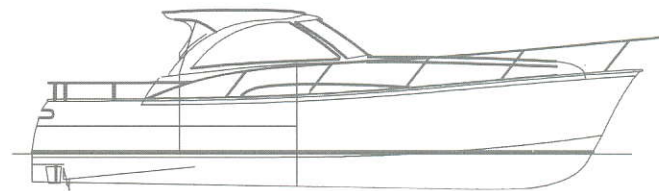

PROFILE

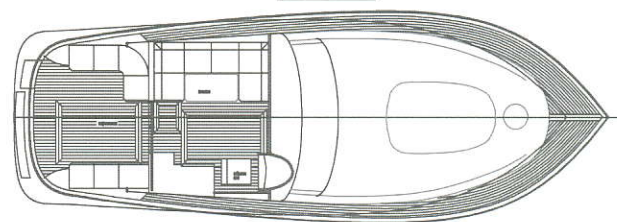

MAIN DECK

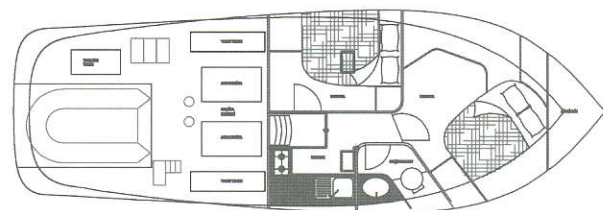

LOWER DECK

Length of overall	L _{OA} : 11,95 meters
Length water line	L _{WL} : 9,46 meters
Beam	B : 4,12 meters
Height	H : 3,25 meters
Deep	D : 2,85 meters
Draft	T : 1,17 meters
Displacement	V : 10,50 tones
Fuel tank capacity	: 650 liters
Water tank capacity	: 600 liters
Max number of people	: 4+1
Engine	: 2X YANMAR 4JH4-HTE, 260 HP
Speed	: 26 knots max and 22 knots cruise

Designed By
HÜR FIRTINA



www.saribey.com



ISO 9001 : 2000

ISO 14001

OHSAS 18001

NO	ITEM / DESCRIPTION	REMARK
1	GENERAL DESIGN & MANAGEMENT	
2	DESIGN	Designed By Hur FIRTINA
3	PROJECT MANAGING	Project is been managing by Nav. Arc. Hur FIRTINA
5		
6	CLASSIFICATION	
7	CLASSIFICATION	CE
8	SURVEY, TEST & CERTIFICATE	Turkish Lloyd
9		
10	HULL / DECK CONSTRUCTION	
11	MATERIAL	GRP, 16 Coats For Underwater And 11 Coats For Hull, Epoxy-Wood
12	WINDOWS	Composite Superstructure
13	DOORS AND OPENINGS	Tempered Glass And Mahogany Frames Wooden Doors And Aluminium Hatches
14		
15	PAINT & FAIRING	
16	HULL INSIDE PAINT - PRIMER, EPOXY FAIRING 5 MM	
16	AVERAGE THICKNESS, TOP COAT PRIMER, TOP COAT PU	International products
16	UNDERWATER COATING	International
19	INTERIOR	
20	PLYWOOD	3 M3 TOTAL 4-6-8-10-12 -18 MM THICK Anegre And Mahogany
22	SOLID WOOD	Anegre
25	STUDWORKS & TEMPORARY MATERIALS	HAFELE
26	INSULATION BULKHEADS	30 MM Rockwool- A 60 Class
27	GLUE, SCREW, BOLTS	Stainless Steel And Sikaflex
28	DOOR HANDLES, DOOR STOPS, LOCKS, GRILLS, TEFLON STRIPS, GENERAL FINISH ACCESSORY FITTINGS, LOCKER	
29	HANDLES, BARS, RAILS, SNAP ON FITTINGS	HAFELE door handles and connection accessories
30	FLOATING FLOOR MATERIALS & ELASTIC CUSHIONS	Sani Foam
37		
38	TEAK DECK	
39	CAPPING RAILS	40 Mm Thick
40	DECKING	15 Mm Thick
42	SIKAFLEX, BONDING	Sikaflex
44		
45	GENERAL MANUFACTURED OUTFITTING	
46	ALUMINUM FRAMED, SLIDING OPENING WINDOWS	6 OF 700X400
48	PORTHOLES - CUSTOM MAKE 400X250 OVAL	4 CIRCULAR- 316 SS
49	DECK HATCHES	700X700 Mm
50	STANCHIONS	800 MM INTERVAL, DIA 32 316 SS
51	DAVIT WITH MANUAL WINCH	Stainless Steel
52	BOLLARDS	6, 600X250X300H, Stainless Steel
53	FAIRLEADS	6, Of Double Sheave And Chafing
54	SWIMMING LADDERS, SHIPTYPE WITH CONTROL POLE	2, 1of Each Side SS Framing,hydraulic, self pump Teak grating, 2.5M Long - folding in hull, telescopic
55	PASARELLA (OPTIONAL)	
58	ANCHOR POCKETS & HAWSE PIPES IN SS316	To be inserted in hull shell
60	FLAG POLE SS IN AFT DIA 60 MM	Stainless steel
61	TABLE BASES	1 Fix in and out
62	BIMINI TOP	Bimini top at aft deck
63	BAR EQUIPMENT	1 in saloon
64	ENGINE ROOM	
65	MAIN ENGINE	2X YANMAR 4JH4-HTE, 260 HP with ZF reduction gear
73		
74	PROPULSION SYSTEM FOR ENGINES	Shafts 50MM, Rubber bearings - Brass Propeller
77	EXHAUST SYSTEM	Silencer, Hoses, -clamps, expansion, insulation, hull fittings
79	SEA WATER SYSTEM	Sea chest, water filter, fittings, hoses & clamps
82	ENGINE CONTROL SYSTEM FOR DUAL STATION	Morse Single Control Handle With Conduit Wiring
84	ENGINE CONTROL SYSTEM	Electronic, Morse Remote Shut Off Valve, Fuel Filter Racor Twin Cartridge, Fuel Hoses And Crimping, Valves & Fittings, Return Hoses And Crimping With Ss Fittings, Twin Filling Stations, Air Vent With Wire Mesh, Inspection Hatches, Parallel Line Outlets, Mechanical Level Gauges Fire Batt Rockwool, Sound Proofing Layer Insulation & Perforated Aluminum Surface Treatment
85	FUEL SYSTEM	One On Bow Bulkhead, one emergency to saloon
88	FUEL TANKS, INTEGRATED TO HULL STRUCTURE	
89	ENGINE ROOM INSULATION	
90	ENGINE ROOM WATERTIGHT DOORS	
91		
92		
102	PLUMBING	
103	FIRE & BILGE SYSTEM PIPING AND VALVES	Pvc- U
104	DISCHARGE LINE FITTINGS AND PIPING	REINFORCED PLACTIC HOSE & SS CLAMPS
105	FRESH & HOT WATER PIPING	Pe Piping With Brass Fittings
106	TANK LEVEL GAUGES - VEMA SYSTEM	Fw, Gw, Bw, Fuel
107	TANK LEVEL ALARMS	AYVAZ - LOW - HIGH
108	BILGE ALARMS	Jabco / Rule
109	GENERAL CONSUMABLES	Sikaflex, Glue, Teflon Band Etc
110	DECK WASH OUTLETS, DECK SHOWER OUTLETS	
111	ELASTIC HOSES AND SERVICE VALVES	
112	UV FILTERING	
113	WATER TANKS FILLERS, SERVICE HATCHES, AIR VENTS, FITTINGS, SUCTION HEADS	
114	INTEGRAL FRESH AND DIRTY WATER TANKS, WITH SPECIAL EPOXY COATINGS	2 Tons Of Water, 0.5 Tons Of Grey, 1.0 Tons Of Black Water
115	CHAIN WASHING OUTLET & CONTROLS	
116		
120	ELECTRICAL	
121	GENERATOR SET (OPTIONAL)	1 Of Onan 8 kva
122	FUEL, EXHAUST & SEA WATER SYS. FOR GEN SETS (water & gas seperation)	
123	BATTERY BANKS	Stationary Batteries 4x200ah
124	START BATTERIES FOR MAIN ENGINE AND GENSET	2 OF 165 Ah
126	24V/100 Ah BATTERY CHARGER, 2500 W INVERTER, 24/12 CONVERTER, 12 V BATTERY CHARGER 50 A	
127	DISTRIBUTION PANELS	24v /220 V At Console Main In ER -3
128	CABLE TRAYS & CABLES	Marine Grade
129	SHORE CONNECTIONS	Marrico
130	SWITCHES & PLUGS - VIMAR	
131	MAIN CONSOLE PANELS	Aluminum / Wood With Switches
133	CEILING LIGHTS, DECORATIVE LAMPS, NAVIGATION LAMPS WITH DIMMERS	
134	ENGINE ROOM AND BILGE LIGHTS	
135		
136	GENERAL OUTFITTING	
141	BOW THRUSTER (OPTIONAL)	Electrical, Side Power, 8 hp.
142	WINDLASS	Electrical, 700 w
143	ANCHOR & CHAIN	*35 Kg, Dia 12 Chain 100m

144	STEERING CYLINDER AND PUMPS	2 Station And Single Cylinder
147	ELECTRICAL TOILET HEADS	Tecma 2 pieces
148	FIXED FIRE FIGHTING SYSTEM WITH REMOTE CONTROL & ALARMS	CO2 System
149	LIFERAFTS & LIFE BUOYS AND RINGS	Suitable For Ocean Crossing
150	AIR CONDITIONING SYSTEM WITH ELECTRONIC CONTROLS AND CONSISTENT AIR GRILLS AND HOSES (OPTIONAL)	3 units Cruise air, totally 12,000 BTU
152	SEARCH LIGHT	JABSCO 1000 W
153	HORN	Marco - Dual
155	INTERCOM AND INTERNAL TELEPHONE NETWORK (OPTIONAL)	Karel
156	TELEPHONES IN CABINS(OPTIONAL)	Siemens(Console+Galley+Master Cabin+ Guest Cabins)
157	HELMSMAN SEATS IN MAIN CONSOLE	1 Inside +1 Stool Outside
158		
	BATHROOM EQUIPMENT	
163	BATHROOM CLADDING	Natural stones and laquering
164	BATHROOM WORKTOPS AND GALLEY WORKTOP IN MARBLE ACCESORIES (TOWEL RACKS, PAPER HOLDER, SOAP DISH, BRUSH HOLDER, GRIP HANDLE, GLASS HOLDER)	Night Sky natural stones
165	MIRRORS	HAFELE equipments
166	SHOWER TRAY & BATH TUB, SINKS	Including Wardrobe Full Height Mirrors
168	SHOWER PANELS WITH CLEAR GLASS	Ceramic sink and GRP tray
169		Alu Framing
	GALLEY EQUIPMENT	
172	MICROWAVE OVEN	Bosch
173	ELECTRICAL OVEN	Bosch
174	REFRIGERATOR	Bosch
175	EXTRACTOR FAN - INDUSTRIAL TYPE	Bosch
176	DISHWASHER	Bosch
177	WASHING MACHINE WIYH DRYER	Bosch
179	STAINLESS OR ACRYLIC SINK & TAP	
181	ICEMAKER	Bosch
	WINE COOLER	For 6 bottles
184		
	ELECTRONICS & NAVIGATION - 2 STATION	
186	AUTOPILOT (OPTIONAL)	Simrad
187	RADAR, DEPTH SOUNDER, CHART PLOTTER	Garmin compact unit
188	RADAR ANTENNA 24 NM	Garmin
189	VHF - DUAL STATION	Simrad
192	MAGNETIC COMPASS -2	Ritche Or Equivalent
193	CHART LIGHT	
195	ICOM SSB FOR OCEAN CROSSING	Option
197	SART & EPIRB (LIFE SAVING ELECTRONICS)	
199		
	SALOON	
186	SOFA	Anegre and Vakko Cruise for 4 persons
187	TABLE	Anegre and palestenk with risible stainless leg
188	CEILING	Vakko Cruise with hand made marcutary art cotonpierre
189	FLOORS	Varnished wood and decorative nonslipperycarpet
192	FRIDGE (OPTIONAL)	Bosch, 50 lt.
193	TV (OPTIONAL)	Sony, 32 " plasma
195	DVD PLAYER (OPTIONAL)	Sony
196	AMPLIFIER (OPTIONAL)	Bose
197	SPEAKERS (OPTIONAL)	5+subwoofer, home theatre system - BOSE
	CD PLAYERS WITH RADIO IN EACH CABIN (OPTIONAL)	Sony
185	MASTER CABIN	
186	BED	King Size ,Latex, round anegre and palestenk wood study with marcutary art head board
187	TABLE	Anegre and palestenk with risible stainless leg
	MAKE UP TABLE	Anegre and palestenk with marcutary art studies on them
	WARDROPEs	Anegre and palestenk with marcutary art studies on them
	CUPBOARDS	Anegre wood with palestenk decorated and HAFELE accesories
	SAFE (OPTIONAL)	1 Pc., electronic and mechanic
	Vakko Cruise with hand made marcutary art cartonpierre and marcutary art central in the middle.	
188	CEILING	Varnished wood and decorative nonslipperycarpet
189	FLOORS	Varnished wood and decorative nonslipperycarpet
192	FRIDGE (OPTIONAL)	Bosch, 35 lt.
193	TV (OPTIONAL)	Sony, 21 " plasma with hidible automatic mechanism
195	DVD PLAYER (OPTIONAL)	Sony
196	AMPLIFIER (OPTIONAL)	Bose
197	SPEAKERS (OPTIONAL)	4+subwoofer, surround system - BOSE
	CD PLAYERS WITH RADIO (OPTIONAL)	Sony
163	BATHROOM CLADDING	Natural stones and laquering
164	BATHROOM WORKTOPS AND GALLEY WORKTOP IN MARBLE ACCESORIES (TOWEL RACKS, PAPER HOLDER, SOAP DISH, BRUSH HOLDER, GRIP HANDLE, GLASS HOLDER)	Night Sky natural stones
165	MIRRORS	HAFELE equipments
166	SHOWER TRAY & BATH TUB, SINKS CERAMIC	Cyrstal
167	SHOWER PANELS WITH CLEAR GLASS	Ceramic sink and GRP tray
168		Alu Framing
	GUEST CABIN	
186	BEDS	2 X Single ,Latex
	WARDROPEs	Anegre and palestenk with marcutary art studies on them
	CUPBOARDS	Anegre wood with palestenk decorated and HAFELE accesories
188	CEILING	Vakko Cruise
189	FLOORS	Varnished wood and decorative nonslipperycarpet
193	TV (OPTIONAL)	Sony, 16 " plasma
195	DVD PLAYER (OPTIONAL)	Sony
196	AMPLIFIER (OPTIONAL)	Bose
197	SPEAKERS (OPTIONAL)	2+subwoofer, surround system - BOSE
	CD PLAYERS WITH RADIO (OPTIONAL)	Sony
	PLAYSTATION (OPTIONAL)	playstation 3
163	BATHROOM CLADDING	Natural stones and laquering
164	BATHROOM WORKTOPS AND GALLEY WORKTOP IN MARBLE ACCESORIES (TOWEL RACKS, PAPER HOLDER, SOAP DISH, BRUSH HOLDER, GRIP HANDLE, GLASS HOLDER)	Night Sky natural stones
165	MIRRORS	HAFELE equipments
166	SHOWER TRAY & BATH TUB, SINKS CERAMIC	Cyrstal
167	SHOWER PANELS WITH CLEAR GLASS	Ceramic sink and GRP tray
168		Alu Framing

SRB 40 F TRAWLER YACHT

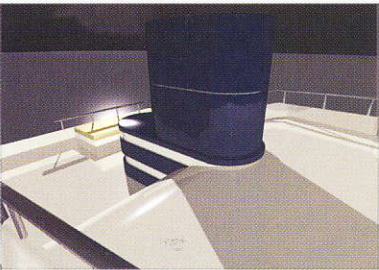
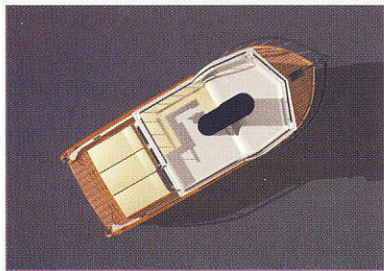

E SRB40 T is a full functional trawler yacht. She has the classical trawler look combining it with nostalgic bosphorous boat accesories on body.

W SRB40 T is perfect for cruisers with an exclusive taste.

C SRB40 T has VIP cabin with parent bathroom, bar and a large saloon. 1 crew cabin.

I SRB40 T 's interior has a top of the line luxury and comfort design. Extended free spaces gives you a relaxing and ease cruising pleasure.

Our difference is relevant to your imagination. You imagine and we accomplish.

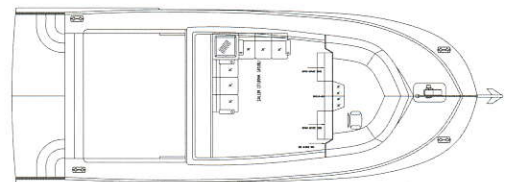
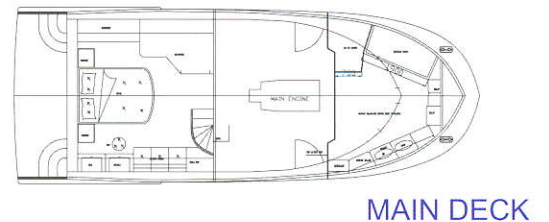
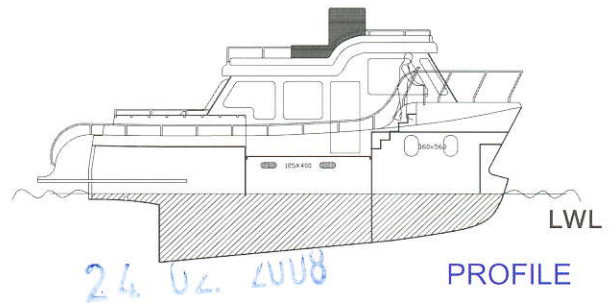

Length of overall	L _{OA} : 12,33 meters
Length water line	L _{WL} : 10,55 meters
Beam	B : 4,60 meters
Height	H : 6,07 meters
Deep	D : 4,28 meters
Draft	T : 1,85 meters
Displacement	V : 19,00 tones
Fuel tank capacity	: 1500 liters
Water tank capacity	: 1200 liters
Max number of people	: 4+1
Engine	: DAEWOO 360 HP

Designed By
SARIBEY
MARITIME



Ka^hitest  Ka^hitest  Ka^hitest 
ISO 9001 : 2000 ISO 14001 OHSAS 18001

NO	ITEM / DESCRIPTION	REMARK
1	GENERAL DESIGN & MANAGEMENT	
2	DESIGN	Designed By Saribey Maritime
3	PROJECT MANAGING	One Ship Building Engineer As Project Manager , Two Engineers For Site Surveys And Class Following
4		
5	CLASSIFICATION	
6	CLASSIFICATION	CE
7	SURVEY, TEST & CERTIFICATE	Germannischare Lloyd
8		
9	HULL / DECK CONSTRUCTION	
10	MATERIAL	GRP, 18 Coats For Underwater And 13 Coats For Hull,
11	WINDOWS	Epoxy- Wood Composite Superstructure
12	DOORS AND OPENINGS	Tempered Glass And Mahogany Frames Wooden Doors And Aluminium Hatches
13		
14	PAINT & FAIRING	
15	HULL INSIDE PAINT , PRIMER, EPOXY FAIRING 5 MM AVERAGE THICKNESS, TOP COAT PRIMER, TOP COAT PU	Avlgrip Fairing And Awircraft 2000 Paint
16	UNDERWATER COATING	International
17	INTERIOR	
18	PLYWOOD	3 M3 TOTAL 4-6-8-10-12 -18 MM THICK Anegre And
19	SOLID WOOD	Palesenk
20	STUDWORKS & TEMPORARY MATERIALS	Anegre
21	INSULATION BULKHEADS	HAFELE
22	GLUE, SCREW, BOLTS	70 M2, 30 MM Rockwool- A 60 Class
23	DOOR HANDLES, DOOR STOPS, LOCKS, GRILLS, TEFLON STRIPS, GENERAL FINISH ACCESSORY FITTINGS, LOCKER HANDLES, BARS, RAILS, SNAP ON FITTINGS	Stainless Steel And Sikaflex HAFELE door handles and connection accessories.
24	FLOATING FLOOR MATERIALS & ELASTIC CUSHION	Sani Foam
25		
26		
27	TEAK DECK	
28	CAPPING RAILS	40 Mm Thick
29	DECKING	15 Mm Thick
30	SIKAFLEX, BONDING	Sikaflex
31		
32	GENERAL MANUFACTURED OUTFITTING	
33	ALUMINUM FRAMED, SLIDING OPENING WINDOWS	6 OF 700X400
34	PORTHOLES - CUSTOM MAKE 400X250 OVAL	24 + 2 CIRCULAR- 316 SS
35	DECK HATCHES,	700x700 Mm
36	STANCHIONS , 800 MM INTERVAL, DIA 32 316 SS	
37	DAVIT WITH MANUAL WINCH	Stainless Steel
38	BOLLARDS	6, 600X250X300H, Stainless Steel
39	FAIRLEADS	6, Of Double Sheave And Chafing
40	SWIMMING LADDERS, SHIPTYPE WITH CONTROL P	2, 1of Each Side SS Framing hydraulic, self pump Teak grating, 2.5M Long - folding in half, telescopic
41	PASARELLA,	In stainless steel
42	AFT TRANSOM WINDOWS	To be inserted in hull shell
43	ANCHOR POCKETS & HAWSE PIPES IN SS316	Stainless steel
44	FLAG POLE SS IN AFT DIA 60 MM	1 Fix in and out
45	TABLE BASES	Bimini top at flybridge
46	BIMINI TOP	1 in saloon and 1 in flybridge in the stack.
47	BAR EQUIPMENT	
48	ENGINE ROOM	
49	MAIN ENGINE	Marine 360 hp DAEWOO with ZF reduction gear
50		
51	PROPULSION SYSTEM FOR ENGINE	Shaft 70MM, Rubber bearings - Brass Propeller
52	EXHAUST SYSTEM	Silencer, Hoses, -clamps, expansion, insulation, hull fittings
53	SEA WATER SYSTEM	Sea chest, water filter, fittings, hoses & clamps
54	ENGINE CONTROL SYSTEM FOR DUAL STATION	Morse Single Control Handle With Conduit Wiring
55	ENGINE CONTROL SYSTEM	Electronic, Morse Remote Shut Off Valve, Fuel Filter Racor Twin Cartridge, Fuel Hoses And Crimping, Valves & Fittings, Return Hoses And Crimping
56	FUEL SYSTEM	With Ss Fittings, Twin Filling Stations, Air Vent With Wire Mesh, Inspection Hatches, Parallel Line Outlets, Mechanical Level Gauges
57	FUEL TANKS, INTEGRATED TO HULL STRUCTURE	Fire Batt Rockwool, Sound Proofing Layer Insulation & Perforated Aluminum Surface Treatment
58	ENGINE ROOM INSULATION	One On Bow Bulkhead, one emergency to saloon.
59	ENGINE ROOM WATERTIGHT DOORS	
60		
61		
62	PLUMBING	
63	FIRE & BILGE SYSTEM PIPING AND VALVES	Pvc- U
64	DISCHARGE LINE FITTINGS AND PIPING	REINFORCED PLASTIC HOSE & SS CLAMPS
65	FRESH & HOT WATER PIPING	Pe Piping With Brass Fittings
66	TANK LEVEL GAUGES - VEMA SYSTEM	Fw, Gw, Bw, Fuel
67	TANK LEVEL ALARMS	A'VAZ - LOW - HIGH
68	BILGE ALARMS	Jabsco / Rule
69	GENERAL CONSUMABLES	Sikaflex, Glue, Teflon Band Etc
70	DECK WASH OUTLETS, DECK SHOWER OUTLETS	
71	ELASTIC HOSES AND SERVICE VALVES	
72	UV FILTERING	
73	WATER TANKS FILLERS, SERVICE HATCHES, AIR VENTS, FITTINGS, SUCTION HEADS	
74	INTEGRAL FRESH AND DIRTY WATER TANKS, WITH SPECIAL EPOXY COATINGS	2 Tons Of Water, 0.5 Tons Of Grey, 1.0 Tons Of Black Water
75	CHAIN WASHING OUTLET & CONTROLS	
76		
77	ELECTRICAL	
78	GENERATOR SETS	1 Of Onan 8 kva
79	FUEL EXHAUST & SEA WATER SYS. FOR GEN SETS (water & gas separation)	
80	BATTERY BANKS	Stationary Batteries 4x200ah
81	START BATTERIES FOR MAIN ENGINE AND GENSET	2 OF 165 Ah
82	24V/100 Ah BATTERY CHARGER, 2500 W INVERTER, 24/12 CONVERTER, 12 V BATTERY CHARGER 50 A	
83	DISTRIBUTION PANELS	24v /220 V At Console Main In E/R -3
84	CABLE TRAYS & CABLES	Marine Grade
85	SHORE CONNECTIONS	Marinco
86	SWITCHES & PLUGS - VIMAR	
87	MAIN CONSOLE PANELS	Aluminum / Wood With Switches
88	CEILING LIGHTS, DECORATIVE LAMPS, NAVIGATION LAMPS WITH DIMMERS	
89	ENGINE ROOM AND BILGE LIGHTS	
90		

91	GENERAL OUTFITTING	
92	BOW THRUSTER	Electrical Side Power, 8 hp
93	WINDLASS	Electrical Lofranz, 1500 w
94	ANCHOR & CHAIN	1*45 Kg, Dia 12 Chain 100m
95	STEERING CYLINDER AND PUMPS	2 Station And Single Cylinder
96	ELECTRICAL TOILET HEADS FIXED FIRE FIGHTING SYSTEM WITH REMOTE CONTROL & ALARMS	Tecoma 2 pieces CO2 System
97	LIFERAFTS & LIFE BUOYS AND RINGS	Suitable For Ocean Crossing
98	AIR CONDITIONING SYSTEM WITH ELECTRONIC CONTROLS AND CONSISTENT AIR GRILLS AND HOSES	3 units Cruise air, toally 54.000 BTU
99	SEARCH LIGHT	JABSCO 1000 W
100	HORN	Marco - Dual
101	INTERCOM AND INTERNAL TELEPHONE NETWORK	Karel
102		
103	TELEPHONES IN CABINS	Siemens (Console+Galley+Master Cabin+ Guest Cabins)
104	HELMSMAN SEATS IN MAIN CONSOLE	1 Inside +1 Stool Outside
105		
106	BATHROOM EQUIPMENT	
107	BATHROOM CLADDING BATHROOM WORKTOPS AND GALLEY WORKTOP	Natural stones and laquering
108	IN MARBLE ACCESSORIES (TOWEL RACKS, PAPER HOLDER, SOAP DISH, BRUSH HOLDER, GRIP HANDLE, GLASS HOLDER)	Night Sky natural stones HAFELE equipments.
109	MIRRORS	Including Wardrobe Full Height Mirrors
110	SHOWER TRAY & BATH TUB, SINKS CERAMIC	Ceramic sink and GRP tray
111	SHOWER PANELS WITH CLEAR GLASS	Alu Framing
112		
113		
114	GALLEY EQUIPMENT	
115	MICROWAVE OVEN	Bosch
116	ELECTRICAL OVEN	Bosch
117	FULL HEIGHT REFRIGERATOR	Bosch
118	EXTRACTOR FAN - INDUSTRIAL TYPE	Bosch
119	DISHWASHER	Bosch
120	WASHING MACHINE WITH DRYER	Bosch
121	STAINLESS OR ACRYLIC SINK & TAP	
122	ICEMAKER	Bosch
123	WINE COOLER	For 6 bottles
124		
125	ELECTRONICS & NAVIGATION - 2 STATION	
126	AUTOPILOT	Simrad
127	RADAR, DEPTH SOUNDER, CHART PLOTTER	Garmin compact unit
128	RADAR ANTENNA 24 NM	Garmin
129	VHF - DUAL STATION	Simrad
130	MAGNETIC COMPASS -2	Ritche Or Equivalent
131	CHART LIGHT	
132	ICOM SSB FOR OCEAN CROSSING	Option
133	INMARSAT -M MINI M	Option
134	SART & EPIRB (LIFE SAVING ELECTRONICS)	
135		
136	SALOON	
137	SOFA	Anegre and Vakkro Cruise for 4 persons
138	TABLE	Anegre and palesenk with riseble stainless leg
139	CEILING	Vakkro Cruise with hand made marcurtary art cartonpiere.
140	FLOORS	Varnished wood and decorative nonslipperycarpets
141	FRIDGE	Bosch, 50 lt.
142	TV	Sony, 32 " plasma
143	DVD PLAYER	Sony
144	AMPLIFIER	Bose
145	SPEAKERS	5+subwoofer, home theatre system - BOSE
146	CD PLAYERS WITH RADIO IN EACH CABIN	Sony
147		
148	MASTER CABIN	
149	BED	King Size, Latex, round anegre and palesenk wood study with marcurtary art head board.
150	TABLE	Anegre and palesenk with riseble stainless leg
151	MAKE UP TABLE	Anegre and palesenk with marcurtary art studies on them
152	WARDROPES	Anegre and palesenk with marcurtary art studies on them Anegre wood with palesenk decorated and HAFELE accessories
153	CUPBOARDS	1 Pc., electronic and mechanic
154	SAFE	Vakkro Cruise with hand made marcurtary art cartonpiere and marcurtary art central in the middle.
155	CEILING	Varnished wood and decorative nonslipperycarpets
156	FLOORS	Bosch, 35 lt.
157	FRIDGE	Sony, 21 " plasma with hidetble automatic mechanism.
158	TV	Sony
159	DVD PLAYER	Sony
160	AMPLIFIER	Bose
161	SPEAKERS	4+subwoofer, surround system - BOSE
162	CD PLAYERS WITH RADIO	Sony
163	BATHROOM CLADDING BATHROOM WORKTOPS AND GALLEY WORKTOP	Natural stones and laquering
164	IN MARBLE ACCESSORIES (TOWEL RACKS, PAPER HOLDER, SOAP DISH, BRUSH HOLDER, GRIP HANDLE, GLASS HOLDER)	Night Sky natural stones HAFELE equipments.
165	MIRRORS	Cyrstal
166	SHOWER TRAY & BATH TUB, SINKS CERAMIC	Ceramic sink and GRP tray
167	SHOWER PANELS WITH CLEAR GLASS	Alu Framing
168		
169		
170		
171	QUEST CABIN	
172	BEDS	2 X Single, Latex
173	WARDROPES	Anegre and palesenk with marcurtary art studies on them Anegre wood with palesenk decorated and HAFELE accessories
174	CUPBOARDS	Vakkro Cruise
175	CEILING	Varnished wood and decorative nonslipperycarpets
176	FLOORS	Sony, 16 " plasma
177	TV	Sony
178	DVD PLAYER	Sony
179	AMPLIFIER	Bose
180	SPEAKERS	2+subwoofer, surround system - BOSE
181	CD PLAYERS WITH RADIO IN EACH CABIN	Sony
182	PLAYSTATION	playstation 3
183	BATHROOM CLADDING BATHROOM WORKTOPS AND GALLEY WORKTOP	Natural stones and laquering
184	IN MARBLE ACCESSORIES (TOWEL RACKS, PAPER HOLDER, SOAP DISH, BRUSH HOLDER, GRIP HANDLE, GLASS HOLDER)	Night Sky natural stones HAFELE equipments.
185	MIRRORS	Cyrstal
186	SHOWER TRAY & BATH TUB, SINK	Ceramic sink and GRP tray
187	SHOWER PANELS WITH CLEAR GLASS	Alu Framing
188		

SRB 65 F DIVING BOAT



E SRB65 DB is a full functional diving boat. Her design is inspired from a motor yacht and it has all the necessities for a diving boat.

W SRB65 DB is perfect for diving schools giving service for both non-disabled and disabled trainees .

C SRB65 DB has kitchen, 2 bathrooms and a storage space.

I SRB65 DB's interior has utilities for disabled trainees.

Our difference is relevant to your imagination. You imagine and we accomplish.

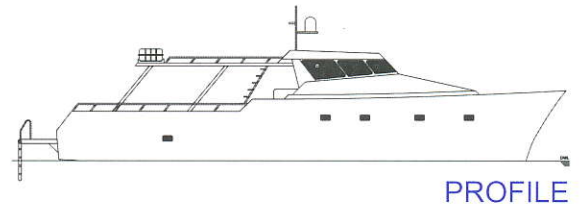

PROFILE

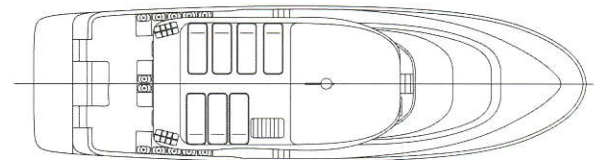

FLY DECK

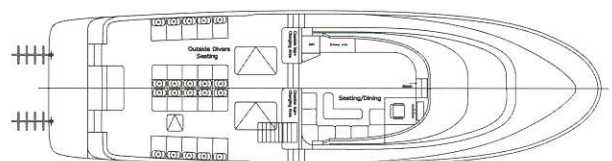

MAIN DECK

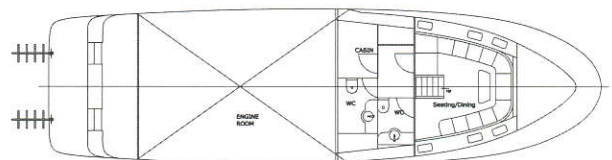

LOWER DECK

Length of overall	LOA : 19,77 meters
Length water line	LWL : 15,49 meters
Beam	B : 5,61 meters
Height	H : 5,53 meters
Deep	D : 3,78 meters
Draft	T : 1,65 meters
Displacement	V : 25,00 tones
Fuel tank capacity	: 2500 liters
Water tank capacity	: 1000 liters
Max number of people	: 20 + 3
Engine	: 2 X CUMMINS 430 HP
Speed	: 25 Knots Max and 22 Knots Cruise

Designed By
SARIBEY
MARITIME



Kahtest  Kahtest  Kahtest
ISO 9001 : 2000 ISO 14001 OHSAS 18001

NO	ITEM / DESCRIPTION	REMARK		
1	GENERAL DESIGN & MANAGEMENT			
2	DESIGN	Designed By Saribey Maritime	108	BILGE ALARMS
3	PROJECT MANAGING	One Ship Building Engineer As Project Manager , Two Engineers For Site Surveys And Class Following	109	GENERAL CONSUMABLES
5			110	DECK WASH OUTLETS, DECK SHOWER OUTLETS
6	CLASSIFICATION			
7	CLASSIFICATION	CE	111	ELASTIC HOSES AND SERVICE VALVES
8	SURVEY, TEST & CERTIFICATE	Germannischare Lloyd	112	UV FILTERING
9			113	WATER TANKS FILLERS, SERVICE HATCHES, AIR VENTS, FITTINGS, SUCTION HEADS
10	HULL / DECK CONSTRUCTION			
11	MATERIAL	GRP: 18 Coats For Underwater And 13 Coats For Hull, Epoxy-Wood Composite Superstructure	114	INTEGRAL FRESH AND DIRTY WATER TANKS, WITH SPECIAL EPOXY COATINGS
12	WINDOWS	Tempered Glass And Aluminium Frames	115	CHAIN WASHING OUTLET & CONTROLS
13	DOORS AND OPENINGS	Wooden Doors And Aluminium Hatches	116	
14			120	ELECTRICAL
15	PAINT & FAIRING			
16	MM AVERAGE THICKNESS, TOP COAT PRIMER, UNDERWATER COATING	Awlgrip Fairing And Awlcraft 2000 Paint International	121	GENERATOR SET
19	INTERIOR			
20	PLYWOOD	Marine plywood	122	FUEL, EXHAUST & SEA WATER SYS. FOR GEN SETS (water & gas separation)
25	STUDWORKS & TEMPORARY MATERIALS	HAFELE	123	BATTERY BANKS
26	INSULATION BULKHEADS	70 M2, 30 MM Rockwool- A 60 Class	124	START BATTERIES FOR MAIN ENGINE AND GENSE12 OF 165 Ah
27	GLUE, SCREW, BOLTS	Stainless Steel And Sikaflex	126	24V/100 Ah BATTERY CHARGER, 2500 W INVERTER, 24/12 CONVERTER, 12 V BATTERY CHARGER 50 A
	DOOR HANDLES, DOOR STOPS, LOCKS, GRILLS, TEFLON STRIPS, GENERAL FINISH ACCESSORY FITTINGS, LOCKER HANDLES, BARS, RAILS, SNAP ON FITTINGS	HAFELE door handles and connection accessories.	127	DISTRIBUTION PANELS
28			128	CABLE TRAYS & CABLES
31			129	SHORE CONNECTIONS
32			130	SWITCHES & PLUGS - VIMAR
33	DECK			
39	CAPPING RAILS	40 Mm Thick	131	MAIN CONSOLE PANELS
40	DECKING	15 Mm Thick	133	CEILING LIGHTS, DECORATIVE LAMPS, NAVIGATION LAMPS WITH DIMMERS
42	SIKAFLEX, BONDING	Sikaflex	134	ENGINE ROOM AND BILGE LIGHTS
	QUEST SEATS	20 Seats with 2 tube holds and bag storages under the seats	135	
	SPARE TUBE STORAGES	25 Spare tube storages	136	GENERAL OUTFITTING
	SUN DECK STORAGES	10 sun beds with 2 stainless steel stairs to sundeck from main deck	142	WINDLASS
	SWIMMING PLATFORM	1.80 M Swimming platform with two stairs at each side and two leathers to the sea	143	ANCHOR & CHAIN
	SWIMMING LADDERS, SHIPTYPE WITH CONTROL P 2, 1of Each Side		144	STEERING CYLINDER AND PUMPS
45	GENERAL MANUFACTURED OUTFITTING			
46	ALUMINUM FRAMED WINDOWS	6 OF 700X400	147	TOILETS
48	PORHOLE - CUSTOM MAKE 400X250 OVAL	8x 2 CIRCULAR- 316 SS	148	FIXED FIRE FIGHTING SYSTEM WITH REMOTE CONTROL & ALARMS
49	DECK HATCHES,	700x700 Mm	149	LIFERAFTS & LIFE BUOYS AND RINGS
50	STANCHIONS ,	800 MM Height, DIA 32 316 SS	150	AIR CONDITIONING SYSTEM WITH ELECTRONIC CONTROLS AND CONSISTENT AIR GRILLS AND
52	BOLLARDS	6, 600X250X300H, Stainless Steel	152	HOSES
53	FAIRLEADS	6, Of Double Sheave And Chafing	153	SEARCH LIGHT
58	ANCHOR POCKETS & HAWSE PIPES IN SS316	To be inserted in hull shell	155	HORN
60	FLAG POLE SS IN AFT DIA 60 MM	Stainless steel	157	HELMSMAN SEATS IN MAIN CONSOLE
61	TABLE BASES	1 Fix in and out	158	
62	BIMINI TOP	Bimini top at flybridge	162	BATHROOM EQUIPMENT
64	ENGINE ROOM			
65	MAIN ENGINE	2x Marine 430 hp CUMMINS with ZF reduction gear	163	BATHROOM CLADDING
74	PROPULSION SYSTEM FOR ENGINE	Shafts 70MM, Rubber bearings - Brass Propeller	164	BATHROOM WORKTOPS AND GALLEY WORKTOP IN MARBLE
77	EXHAUST SYSTEM	Silencer, Hoses, -clamps, expansion, insulation, hull fittings	165	ACCESSORIES (TOWEL RACKS, PAPER HOLDER, SOAP DISH, BRUSH HOLDER, GRIP HANDLE, GLASS HOLDER)
79	SEA WATER SYSTEM	Sea chest, water filter, fittings, hoses & clamps	166	MIRRORS
84	ENGINE CONTROL SYSTEM	Electronic, Morse Remote Shut Off Valve, Fuel Filter Racor Twin Cartridge And Crimping	167	SHOWER TRAY & BATH TUB, SINKS CERAMIC
	FUEL SYSTEM	Fuel Hoses And Crimping, Valves & Fittings, Return Hoses With Ss Fittings, Twin Filling Stations, Air Vent With Wire Mesh, Inspection Hatches, Paralel Line Outlets, Mechanical Level Gauges	168	SHOWER PANELS WITH CLEAR GLASS
	FUEL TANKS, INTEGRATED TO HULL STRUCTURE	Fire Batt Rockwool, Sound Proofing Layer Insulation & Perforated Aluminium Surface Treatment	169	
89	ENGINE ROOM INSULATION	One On Bow Bulkhead, one emergency to deck.	170	GALLEY EQUIPMENT
90	ENGINE ROOM WATERTIGHT DOORS		172	MICROWAVE OVEN
91			173	ELECTRICAL OVEN
92			174	REFRIGERATOR
102	PLUMBING			
103	FIRE & BILGE SYSTEM PIPING AND VALVES	Pvc- U REINFORCED PLACTIC HOSE & SS CLAMPS	175	EXTRACTOR FAN - INDUSTRIAL TYPE
104	DISCHARGE LINE FITTINGS AND PIPING	Pe Piping With Brass Fittings	184	
105	FRESH WATER PIPING	Fw, Gw, Bw, Fuel	185	ELECTRONICS & NAVIGATION - 2 STATION
106	TANK LEVEL GAUGES - VEMA SYSTEM	AYVAZ - LOW - HIGH	186	AUTOPLOT (OPTIONAL)
107	TANK LEVEL ALARMS		187	RADAR, DEPTH SOUNDER, CHART PLOTTER
			188	RADAR ANTENNA 24 NM (OPTIONAL)
			189	VHF - DUAL STATION
			192	MAGNETIC COMPASS -2
			193	CHART LIGHT
			195	ICOM SSB FOR OCEAN CROSSING
			197	SART & EPIRB (LIFE SAVING ELECTRONICS)
			199	
			185	SALOON
			186	SOFA
			187	TABLE
			189	FLOORS
			197	SPEAKERS
				CD PLAYERS WITH RADIO IN EACH CABIN
				Enough for 20 persons
				Anegre and palesenk with riseble stainless leg
				Water resistance carpet
				For deck, wheel house and down rest room.
				Sony



SRB 70 F TRAWLER YACHT

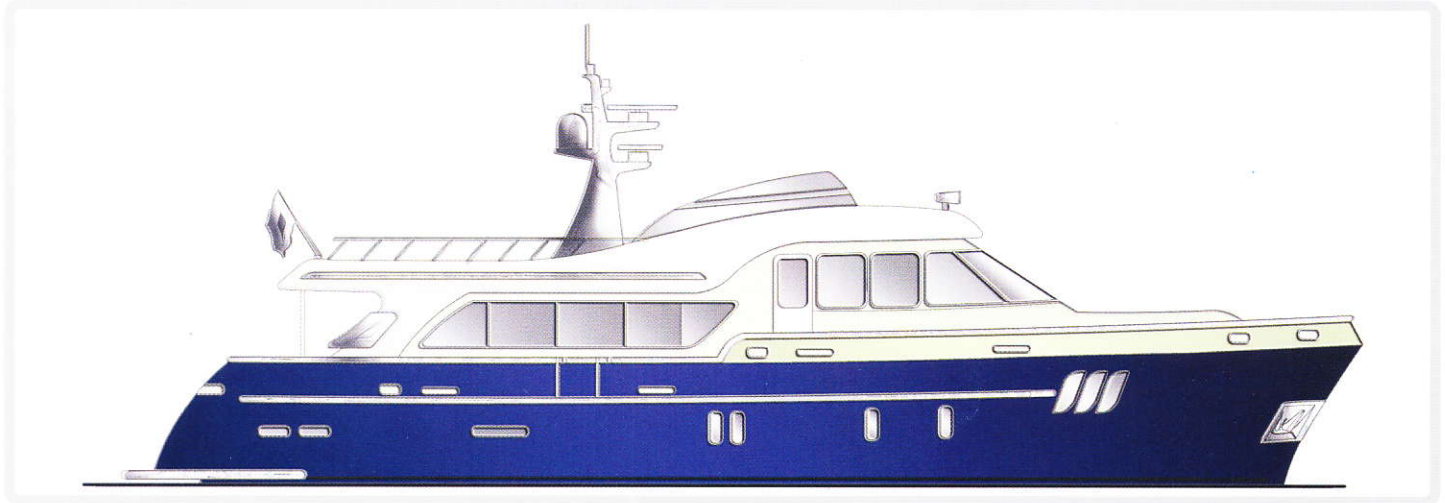

E SRB70 F is a full functional luxury trawler yacht with reforming modernized body lines. Her design combines fine lines and strong body in an absolute match.

W SRB70 F is perfect for a conforting and economic yacht.

C SRB70 F has 4 cabins for 6 guest and 2 crew accomodadtion.

I SRB70 F's interior has marks from her strong body with horizontal lines deepening cabin space . Unlike a classical trawler, luxury ammenities in cabins will provide you the comfort of a motor yacht in every weather and sea condition.

Our difference is relevant to your imagination. You imagine and we accomplish.

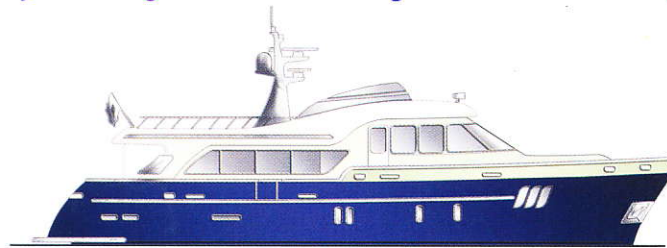

24.02.2008

PROFILE

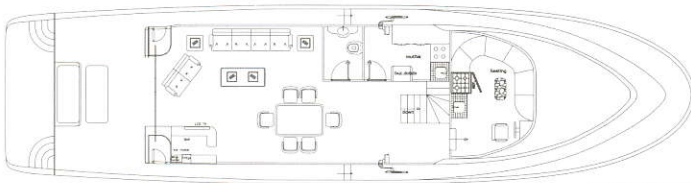

MAIN DECK

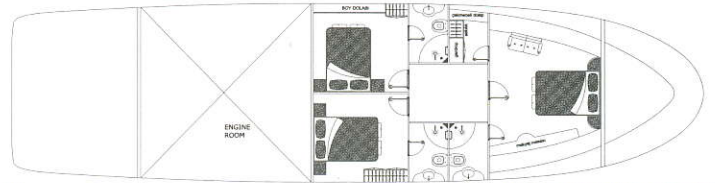

INTERIOR DECK

Length of overall	L _{OA} : 21,60 meters
Length water line	L _{WL} : 18,85 meters
Beam	B : 5,61 meters
Height	H : 7,22 meters
Deep	D : 3,85 meters
Draft	T : 1,70 meters
Displacement	V : 42,00 tones
Fuel tank capacity	: 4500 liters
Water tank capacity	: 1800 liters
Max number of people	: 6+2
Engine	: 2 X CUMMINS 550 HP
Speed	: 25 Knots Max and 21 Knots Cruise

Designed By

montana
DESIGN



Kahtest TÜRKİYE
ISO 9001 : 2000

Kahtest TÜRKİYE
ISO 14001

Kahtest TÜRKİYE
OHSAS 18001

NO	ITEM / DESCRIPTION	REMARK
1	GENERAL DESIGN & MANAGEMENT	
2	DESIGN	Montana Design One Ship Building Engineer As Project Manager , Two Engineers For Site Surveys And Class Following
3	PROJECT MANAGING	
4		
5	CLASSIFICATION	
6	CLASSIFICATION	CE
7	SURVEY, TEST & CERTIFICATE	Germanischere Lloyd
8		
9	HULL / DECK CONSTRUCTION	
10	MATERIAL	GRP
11	WINDOWS	Tempered Glass And Marine Aluminium Frames
12	DOORS AND OPENINGS	Composite and aluminium Doors And Aluminium Hatches
13		
14	PAINT & FAIRING	
15	HULL INSIDE PAINT , PRIMER, EPOXY FAIRING 5 MM AVERAGE THICKNESS, TOP COAT PRIMER, TOP COAT PU	Jotun Paint Systems
16	UNDERWATER COATING	Jotun Paint Systems
17	INTERIOR	
18	PLYWOOD	Anegre and mahogany
19	SOLID WOOD	Anegre
20	STUDWORKS & TEMPORARY MATERIALS	HAFELE
21	INSULATION BULKHEADS	30 MM Rockwool- A 60 Class
22	GLUE, SCREW, BOLTS	Stainless Steel And Sikaflex
23	DOOR HANDLES, DOOR STOPS, LOCKS, GRILLS, TEFLON STRIPS, GENERAL FINISH ACCESSORY FITTINGS, LOCKER HANDLES, BARS, RAILS, SNAP ON FITTINGS	HAFELE door handles and connection accessories
24	FLOATING FLOOR MATERIALS & ELASTIC CUSHION	Sani Foam
25		
26	TEAK DECK	
27	CAPPING RAILS	40 Mm Thick
28	DECKING	15 Mm Thick birmania teak
29	SIKAFLEX, BONDING	Sikaflex
30		
31	GENERAL MANUFACTURED OUTFITTING	
32	ALUMINUM FRAMED, SLIDING OPENING WINDOWS	6 OF 700X400
33	PORTHOLES - CUSTOM MAKE 400X250 OVAL	24 + 2 CIRCULAR- 316 SS
34	DECK HATCHES	700x700 Mm
35	STANCHIONS	800 MM interval, DIA 32 316 SS
36	DAVIT WITH MANUAL WINCH	Stainless Steel
37	BOLLARDS	6, 600X250X300H, Stainless Steel
38	FAIRLEADS	6, Of Double Sheave And Chafing
39	SWIMMING LADDERS, SHIPTYE WITH CONTROL P 2, 1 of Each Side	
40	PASARELLA	SS Framing,hydraulic, self pump Teak grating, 3.5M Long- folding in half, telescopic and 16degree vertical movement
41	AFT TRANSOM WINDOWS	In stainless steel
42	ANCHOR POCKETS & HAWSE PIPES IN SS316	To be inserted in hull shell
43	FLAG POLE SS IN AFT DIA 60 MM	Stainless steel
44	TABLE BASES	1 Fix in and out
45	BIMINI TOP	Bimini top at flybridge
46	BAR EQUIPMENT	1 in saloon and 1 in flybridge in the stack
47	ENGINE ROOM	
48	MAIN ENGINE	2x 560 hp IVECO with ZF reduction gears
49		
50	PROPULSION SYSTEM FOR ENGINE	Shafts 70MM, Rubber bearings - Brass Propeller
51	EXHAUST SYSTEM	Silencer, Hoses, -clamps, expansion, insulation, hull fittings
52	SEA WATER SYSTEM	Sea chest, water filter, fittings, hoses & clamps
53	ENGINE CONTROL SYSTEM FOR DUAL STATION	Morse Single Control Handle With Conduit Wiring
54	ENGINE CONTROL SYSTEM	Electronic, Morse Remote Shut Off Valve, Fuel Filter Racor Twin Cartridge, Fuel Hoses And Crimping, Valves & Fittings, Return Hoses And Crimping With Ss Fittings, Twin Filling Stations, Air Vent With Wire Mesh Inspection Hatches, Parallel Line Outlets, Mechanical Level Gauges
55	FUEL SYSTEM	Fire Batt Rockwool, Sound Proofing Layer Insulation & Perforated Aluminum Surface Treatment
56	FUEL TANKS, INTEGRATED TO HULL STRUCTURE	One On Bow Bulkhead, one emergency to saloon.
57	ENGINE ROOM INSULATION	
58	ENGINE ROOM WATERTIGHT DOORS	
59		
60	PLUMBING	
61	FIRE & BILGE SYSTEM PIPING AND VALVES	Pvc- U
62	DISCHARGE LINE FITTINGS AND PIPING	Reinforced plastic hoses & SS clamps
63	FRESH & HOT WATER PIPING	Pe Piping With Brass Fittings
64	TANK LEVEL GAUGES - VEMA SYSTEM	Fw, Gw, Bw, Fuel
65	TANK LEVEL ALARMS	AYVAZ - LOW - HIGH
66	BILGE ALARMS	Jabsco / Rule
67	GENERAL CONSUMABLES	Sikaflex, Glue, Teflon Band Etc
68	DECK WASH OUTLETS, DECK SHOWER OUTLETS	
69	ELASTIC HOSES AND SERVICE VALVES	
70	UV FILTERING	
71	WATER TANKS FILLERS, SERVICE HATCHES, AIR VENTS, FITTINGS, SUCTION HEADS	
72	INTEGRAL FRESH AND DIRTY WATER TANKS, WITH SPECIAL EPOXY COATINGS	2 Tons Of Water, 0.5 Tons Of Grey, 1.0 Tons Of Black Water
73	CHAIN WASHING OUTLET & CONTROLS	
74		
75	ELECTRICAL	
76	GENERATOR SETS	2x Of Onan 22.5 kva
77	FUEL, EXHAUST & SEA WATER SYS. FOR GEN SETS (water & gas separation)	
78	BATTERY BANKS	Stationary Batteries 6x200ah
79	START BATTERIES FOR MAIN ENGINE AND GENSET	4 OF 165 Ah
80	24V/100 Ah BATTERY CHARGER, 2500 W	
81	INVERTER, 24/12 CONVERTER, 12 V BATTERY CHARGER 50 A	Victron
82	DISTRIBUTION PANELS	24v /220 V At Console Main In E/R -3
83	CABLE TRAYS & CABLES	Marine Grade
84	SHORE CONNECTIONS	Marinco
85	SWITCHES & PLUGS	VIMAR
86	MAIN CONSOLE PANELS	Aluminum / Wood With Switches
87	CEILING LIGHTS, DECORATIVE LAMPS, NAVIGATION LAMPS WITH DIMMERS	BCM and Centaluppi
88	ENGINE ROOM AND BILGE LIGHTS	

89	GENERAL OUTFITTING	
90	BOW THRUSTER	Electrical, Side Power, 20 hp
91	WINDLASS	Electrical,Data, 2500 w
92	ANCHOR & CHAIN	2x45 Kg, Dia 12 Chain, 100m
93	STEERING CYLINDER AND PUMPS	2 Station And Single Cylinder
94	ELECTRICAL TOILET HEADS	Teema 4 pieces
95	FIXED FIRE FIGHTING SYSTEM WITH REMOTE CONTROL & ALARMS	CO2 System
96	LIFERAFTS & LIFE BUOYS AND RINGS	Suitable For Ocean Crossing
97	AIR CONDITIONING SYSTEM WITH ELECTRONIC CONTROLS AND CONSISTENT AIR GRILLS AND HOSES	3 units Marinair, totally 60,000 BTU
98	SEARCH LIGHT	JABSCO 1000 W
99	HORN	Marco - Dual
100	HELMSMAN SEATS IN MAIN CONSOLE	1 Inside +1 Stool Outside
101		
102	BATHROOM EQUIPMENT	
103	BATHROOM CLADDING	Natural stones and laquering
104	BATHROOM WORKTOPS AND GALLEY WORKTOP IN MARBLE	Night Sky natural stones
105	ACCESORIES (TOWEL RACKS, PAPER HOLDER, SOAP DISH, BRUSH HOLDER, GRIP HANDLE, GLASS HOLDER)	HAFELE equipments
106	MIRRORS	Including Wardrobe Full Height Mirrors
107	SHOWER TRAY & BATH TUB, SINKS CERAMIC	Ceramic sink and GRP tray
108	SHOWER PANELS WITH CLEAR GLASS	Alu Framing
109		
110	GALLEY EQUIPMENT	
111	MICROWAVE OVEN	Bosch
112	ELECTRICAL OVEN	Bosch
113	FULL HEIGHT REFRIGERATOR	Bosch
114	EXTRACTOR FAN - INDUSTRIAL TYPE	Bosch
115	DISHWASHER	Bosch
116	WASHING MACHINE WITH DRYER	Bosch
117	STAINLESS OR ACRYLIC SINK & TAP	
118	ICEMAKER	Bosch
119	WINE COOLER	For 6 bottles
120		
121	ELECTRONICS & NAVIGATION - 2 STATION	
122	AUTOPILOT	Simrad
123	RADAR, DEPTH SOUNDER, CHART PLOTTER	Simrad
124	RADAR ANTENNA 24 NM	Simrad
125	VHF - DUAL STATION	Simrad
126	MAGNETIC COMPASS -2	Ritchie Or Equivalent
127	CHART LIGHT	
128	ICOM SSB FOR OCEAN CROSSING	Option
129	INMARSAT -M MINI M	Option
130	SART & EPIRB (LIFE SAVING ELECTRONICS)	
131		
132	SALOON	
133	SOFA	Anegre and Vakko Cruise for 4 persons
134	TABLE	Anegre and mahogany with risible stainless leg
135	CEILING	Vakko Cruise with aluminium frame
136	FLOORS	Varnished wood and decorative nonslipperycarpets
137	FRIDGE	Bosch, 50 lt.
138	TV	Sony, 42 " plasma
139	DVD PLAYER	Sony
140	AMPLIFIER	Bose
141	SPEAKERS	5+subwoofer, home theatre system - BOSE
142	CD PLAYERS WITH RADIO IN EACH CABIN	Sony
143		
144	MASTER CABIN	
145	BED	King Size, Latex, round anegre and mahogany, electrical bed shaping mechanism.
146	TABLE	Anegre and mahogany with risible stainless leg
147	MAKE UP TABLE	Anegre and mahogany
148	WARDROPES	Anegre and mahogany
149	CUPBOARDS	Anegre wood with mahogany decorated and HAFELE accessories.
150	SAFE	1 Pc., electronic and mechanic
151	CEILING	Vakko Cruise with hand made marcutary art cartonpierre and marcutary art central in the middle.
152	FLOORS	Varnished wood and decorative nonslipperycarpets
153	FRIDGE	Bosch, 35 lt.
154	TV	Sony, 21 " plasma with hideble automatic mechanism.
155	DVD PLAYER	Sony
156	AMPLIFIER	Bose
157	SPEAKERS	4+subwoofer, surround system - BOSE
158	CD PLAYERS WITH RADIO	Sony
159	BATHROOM CLADDING	Natural stones and laquering
160	BATHROOM WORKTOPS AND GALLEY WORKTOP IN MARBLE	Night Sky natural stones
161	ACCESORIES (TOWEL RACKS, PAPER HOLDER, SOAP DISH, BRUSH HOLDER, GRIP HANDLE, GLASS HOLDER)	HAFELE equipments
162	MIRRORS	Cystal
163	SHOWER TRAY & BATH TUB, SINKS CERAMIC	Ceramic sink and GRP tray
164	SHOWER PANELS WITH CLEAR GLASS	Alu Framing
165		
166		
167	QUEST CABINS	
168	BEDS	Latex, round corners with mahogany
169	WARDROPES	Anegre and mahogany
170	CUPBOARDS	Anegre wood with mahogany decorated and HAFELE accessories
171	CEILING	Vakko Cruise
172	FLOORS	Varnished wood and decorative nonslipperycarpets
173	TV	Sony, 16 " plasma
174	DVD PLAYER	Sony
175	AMPLIFIER	Bose
176	SPEAKERS	2+subwoofer, surround system - BOSE
177	CD PLAYERS WITH RADIO IN EACH CABIN	Sony
178	BATHROOM CLADDING	Natural stones and laquering
179	BATHROOM WORKTOPS AND GALLEY WORKTOP IN MARBLE	Night Sky natural stones
180	ACCESORIES (TOWEL RACKS, PAPER HOLDER, SOAP DISH, BRUSH HOLDER, GRIP HANDLE, GLASS HOLDER)	HAFELE equipments.
181	MIRRORS	Cystal
182	SHOWER TRAY & BATH TUB, SINK	Ceramic sink and GRP tray
183	SHOWER PANELS WITH CLEAR GLASS	Alu Framing

SRB 95 F MOTOR YACHT

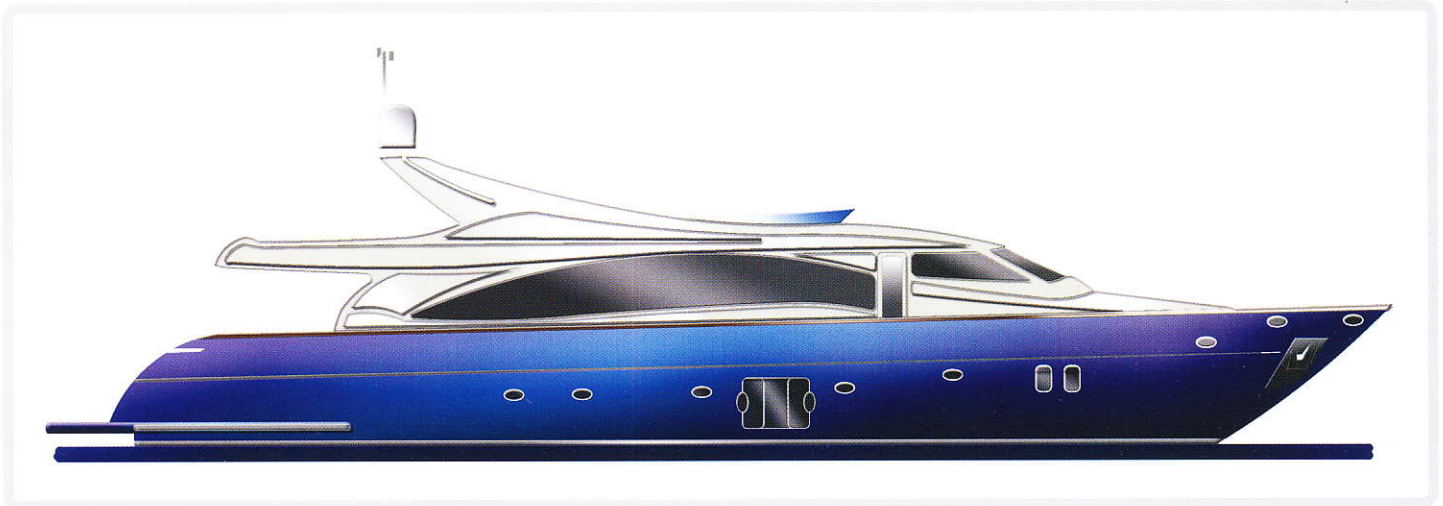

E SRB95 F is a full functional de-lux motor yacht .Her aerodynamic body is a state of art modern design.

W SRB95 F is an elegant and prestigious motor yacht for cruisers.

C SRB95 F has 4 luxury guest cabins for 8 guests and 3 cabins for 5 crew members.

I SRB95 F's interior is designed for luxury and conforting cruising experiences. Guest cabins amenities are high-end modern equipment for best possible accomodaditon.

Our difference is relevant to your imagination. You imagine and we accomplish.



24.02.2008



PROFILE

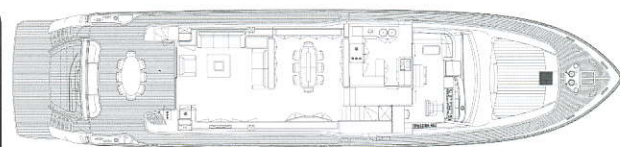

MAIN DECK

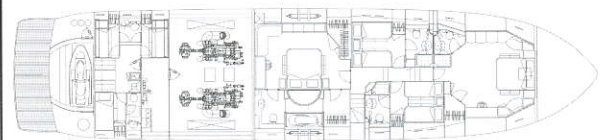

INTERIOR DECK

Length of overall	LOA : 28,96 meters
Length water line	LWL : 26,93 meters
Beam	B : 7,05 meters
Height	H : 8,70 meters
Deep	D : 3,23 meters
Draft	T : 1,55 meters
Displacement	V : 82,00 tones
Fuel tank capacity	: 9000 liters
Water tank capacity	: 1200 liters
Max number of people	: 10 + 4
Engine	: 2 X MAN 1550 HP
Speed	: 25 Knots Max and 22 Knots Cruise

Designed By



NO	ITEM / DESCRIPTION	REMARK
1	GENERAL DESIGN & MANAGEMENT	
2	DESIGN	Designed By Sanbey Maritime One Ship Building Engineer As Project Manager, Two Engineers For Site Surveys And Class Following
3	PROJECT MANAGING	
4		
5	CLASSIFICATION	
6	CLASSIFICATION	Lloyd
7	SURVEY, TEST & CERTIFICATE	Riha
8		
9	HULL / DECK CONSTRUCTION	
10	MATERIAL	GRP; 18 Coats For Underwater And 13 Coats For Hull.
11	WINDOWS	Epoxy- Wood Composite Superstructure
12	DOORS AND OPENINGS	Tempered Glass And Mahogany Frames Wooden Doors And Aluminium Hatches
13		
14	PAINT & FAIRING	
15	MM AVERAGE THICKNESS, TOP COAT PRIMER, UNDERWATER COATING	Awlgrip Fairing And Awlcraft 2000 Paint International
17	INTERIOR	
18	PLYWOOD	3 M3 TOTAL 4-6-8-10-12 -18 MM THICK Anegre And Palesenk
19	SOLID WOOD	Anegre
20	STUDWORKS & TEMPORARY MATERIALS	HAFELE
21	INSULATION BULKHEADS	70 M2, 30 MM Rockwool- A 60 Class
22	GLUE, SCREW, BOLTS	Stainless Steel And Sikaflex
23	DOOR HANDLES, DOOR STOPS, LOCKS, GRILLS, TEFLON STRIPS, GENERAL FINISH ACCESSORY FITTINGS, LOCKER HANDLES, BARS, RAILS, SNAP ON FITTINGS	HAFELE door handles and connection accessories.
24	FLOATING FLOOR MATERIALS & ELASTIC CUSHION	Sani Foam
25		
26		
27	TEAK DECK	
28	CAPPING RAILS	40 Mm Thick
29	DECKING	15 Mm Thick
30	SIKAFLEX, BONDING	Sikaflex.
31		
32	GENERAL MANUFACTURED OUTFITTING	
33	ALUMINUM FRAMED, SLIDING OPENING WINDOWS	6 OF 700X400
34	PORHOLE - CUSTOM MAKE 400X250 OVAL	24 + 2 CIRCULAR- 316 SS
35	DECK HATCHES	700x700 Mm
36	STANCHIONS - 800 MM INTERVAL, DIA 32 316 SS	
37	DAVIT WITH MANUAL WINCH	Stainless Steel
38	BOLLARDS	6 600X250X300H, Stainless Steel
39	FAIRLEADS	6 Of Double Sheave And Chafing
40	SWIMMING LADDERS, SHIPTYPE WITH CONTROL P	2, 1of Each Side SS Framing,hydraulic, self pump Teak grating, 2.5M Long - folding in half, telescopic
41	PASARELLA,	In stainless steel
42	AFT TRANSOM WINDOWS	To be inserted in hull shell
43	ANCHOR POCKETS & HAWSE PIPES IN SS316	Stainless steel
44	FLAG POLE SS IN AFT DIA 60 MM	1 Fix in and out
45	TABLE BASES	Bimini top at flybridge
46	BIMINI TOP	1 in saloon and 1 in flybridge in the stack
47	BAR EQUIPMENT	
48	ENGINE ROOM	
49	MAIN ENGINE	Marine 360 hp DAEWOO with ZF reduction gear
50		
51	PROPULSION SYSTEM FOR ENGINE	Shaft 70MM, Rubber bearings - Brass Propeller
52	EXHAUST SYSTEM	Silencer, Hoses, -clamps, expansion, insulation, hull fittings
53	SEA WATER SYSTEM	Sea chest, water filter, fittings, hoses & clamps
54	ENGINE CONTROL SYSTEM FOR DUAL STATION	Morse Single Control Handle With Conduit Wiring
55	ENGINE CONTROL SYSTEM	Electronic, Morse Remote Shut Off Valve, Fuel Filter Racor Twin Cartridge, Fuel Hoses And Crimping, Valves & Fittings, Return Hoses And Crimping With Ss Fittings, Twin Filling Stations, Air Vent With Wire Mesh, Inspection Hatches, Paralel Line Outlets, Mechanical Level Gauges Fire Batt Rockwool, Sound Proofing Layer insulation & Perforated Aluminum Surface Treatment
56	FUEL SYSTEM	One On Bow Bulkhead, one emergency to saloon.
57	FUEL TANKS, INTEGRATED TO HULL STRUCTURE	
58	ENGINE ROOM INSULATION	
59	ENGINE ROOM WATERTIGHT DOORS	
60		
61	PLUMBING	
62	FIRE & BILGE SYSTEM PIPING AND VALVES	Pvc- U
63	DISCHARGE LINE FITTINGS AND PIPING	REINFORCED PLACTIC HOSE & SS CLAMPS
64	FRESH & HOT WATER PIPING	Pe Piping With Brass Fittings
65	TANK LEVEL GAUGES - VEMA SYSTEM	Fw, Gw, Bw, Fuel
66	TANK LEVEL ALARMS	AYVAZ - LOW - HIGH
67	BILGE ALARMS	Jabscro / Rule
68	GENERAL CONSUMABLES	Sikaflex, Glue, Teflon Band Etc
69	DECK WASH OUTLETS, DECK SHOWER OUTLETS	
70	ELASTIC HOSES AND SERVICE VALVES	
71	UV FILTERING	
72	WATER TANKS FILLERS, SERVICE HATCHES, AIR VENTS, FITTINGS, SUCTION HEADS	
73	INTEGRAL FRESH AND DIRTY WATER TANKS, WITH SPECIAL EPOXY COATINGS	2 Tons Of Water, 0.5 Tons Of Grey, 1.0 Tons Of Black Water
74	CHAIN WASHING OUTLET & CONTROLS	
75		
76	ELECTRICAL	
77	GENERATOR SETS	1 Of Onan 8 kva
78	FUEL EXHAUST & SEA WATER SYS. FOR GEN SETS	(water & gas seperation)
79	BATTERY BANKS	Stationary Batteries 4x200ah
80	START BATTERIES FOR MAIN ENGINE AND GENSET	2 OF 165 Ah
81	24V/100 Ah BATTERY CHARGER, 2500 W INVERTER, 24/12 CONVERTER, 12 V BATTERY CHARGER 50 A	24V /220 V At Console Main In E/R -3
82	DISTRIBUTION PANELS	Marine Grade
83	CABLE TRAYS & CABLES	Marinco
84	SHORE CONNECTIONS	
85	SWITCHES & PLUGS - VIMAR	
86	MAIN CONSOLE PANELS	Aluminum / Wood With Switches
87	CEILING LIGHTS, DECORATIVE LAMPS, NAVIGATION LAMPS WITH DIMMERS	
88	ENGINE ROOM AND BILGE LIGHTS	
89		
90	GENERAL OUTFITTING	
91	BOW THRUSTER	Electrical, Side Power 8 hp.
92	WINDLASS	Electrical Lofranz, 1500 w
93	ANCHOR & CHAIN	1*45 Kg, Dia 12 Chain 100m
94	STEERING CYLINDER AND PUMPS	2 Station And Single Cylinder

95	ELECTRICAL TOILET HEADS	Tecma 2 pieces
96	FIXED FIRE FIGHTING SYSTEM WITH REMOTE CONTROL & ALARMS	CO2 System
97	LIFERAFTS & LIFE BUOYS AND RINGS AIR CONDITIONING SYSTEM WITH ELECTRONIC CONTROLS AND CONSISTENT AIR GRILLS AND	Suitable For Ocean Crossing
98	HOSES	3 units Cruise air, toally 54.000 BTU
99	SEARCH LIGHT	JABSCO 1000 W
100	HORN	Marco - Dual
101	INTERCOM AND INTERNAL TELEPHONE NETWORK	Karel
102	TELEPHONES IN CABINS	Siemens(Console+Galley+Master Cabin+ Guest Cabins)
103	HELMSMAN SEATS IN MAIN CONSOLE	1 Inside +1 Stool Outside
104		
105	BATHROOM EQUIPMENT	
106	BATHROOM CLADDING BATHROOM WORKTOPS AND GALLEY WORKTOP	Natural stones and laquering
107	IN MARBLE ACCESSORIES (TOWEL RACKS, PAPER HOLDER, SOAP DISH, BRUSH HOLDER, GRIP HANDLE, GLASS HOLDER)	Night Sky natural stones HAFELE equipments.
108	MIRRORS	Including Wardrobe Full Height Mirrors
109	SHOWER TRAY & BATH TUB, SINKS CERAMIC	Ceramic sink and GRP tray
110	SHOWER PANELS WITH CLEAR GLASS	Alu Framing
111		
112		
113	GALLEY EQUIPMENT	
114	MICROWAVE OVEN	Bosch
115	ELECTRICAL OVEN	Bosch
116	FULL HEIGHT REFRIGERATOR	Bosch
117	EXTRACTOR FAN - INDUSTRIAL TYPE	Bosch
118	DISHWASHER	Bosch
119	WASHING MACHINE WIYH DRYER	Bosch
120	STAINLESS OR ACRYLIC SINK & TAP	
121	ICEMAKER	Bosch
122	WINE COOLER	For 6 bottles
123		
124	ELECTRONICS & NAVIGATION - 2 STATION	
125	AUTOPILOT	Simrad
126	RADAR, DEPTH SOUNDER, CHART PLOTTER	Garmin compact unit
127	RADAR ANTENNA 24 NM	Garmin
128	VHF - DUAL STATION	Simrad
129	MAGNETIC COMPASS -2	Ritchie Or Equivalent
130	CHART LIGHT	
131	ICOM SSB FOR OCEAN CROSSING	Option
132	INMARSAT -M MINI M	Option
133	SART & EPIRB (LIFE SAVING ELECTRONICS)	
134		
135	SALOON	
136	SOFA	Anegre and Vakko Cruise for 4 persons
137	TABLE	Anegre and palesenk with risible stainless leg
138	CEILING	Vakko Cruise with hand made marcutary art cotonpierre.
139	FLOORS	Varnished wood and decorative nonslippy carpets
140	FRIDGE	Bosch, 50 lt.
141	TV	Sony, 32 " plasma
142	DVD PLAYER	Sony
143	AMPLIFIER	Bose
144	SPEAKERS	6+subwoofer, home theatre system - BOSE
145	CD PLAYERS WITH RADIO IN EACH CABIN	Sony
146		
147	MASTER CABIN	
148	BED	King Size, Latex, round anegre and palesenk wood study with marcutary art head board.
149	TABLE	Anegre and palesenk with risible stainless leg
150	MAKE UP TABLE	Anegre and palesenk with marcutary art studies on them
151	WARDROPES	Anegre and palesenk with marcutary art studies on them Anegre wood with palesenk decorated and HAFELE accessories
152	CUPBOARDS	1 Pc., electronic and mechanic
153	SAFE	Vakko Cruise with hand made marcutary art cartonpierre and marcutary art central in the middle
154	CEILING	Varnished wood and decorative nonslippy carpets
155	FLOORS	Bosch, 35 lt.
156	FRIDGE	Sony, 21 " plasma with hidble automatic mechanism.
157	TV	Sony
158	DVD PLAYER	Bose
159	AMPLIFIER	4+subwoofer, surround system - BOSE
160	SPEAKERS	Sony
161	CD PLAYERS WITH RADIO	Natural stones and laquering
162	BATHROOM CLADDING BATHROOM WORKTOPS AND GALLEY WORKTOP	Night Sky natural stones
163	IN MARBLE ACCESSORIES (TOWEL RACKS, PAPER HOLDER, SOAP DISH, BRUSH HOLDER, GRIP HANDLE, GLASS HOLDER)	HAFELE equipments. Cyrstal
164	MIRRORS	Ceramic sink and GRP tray
165	SHOWER TRAY & BATH TUB, SINKS CERAMIC	Alu Framing
166	SHOWER PANELS WITH CLEAR GLASS	
167		
168		
169		
170	QUEST CABIN	
171	BEDS	2 X Single Latex
172	WARDROPES	Anegre and palesenk with marcutary art studies on them Anegre wood with palesenk decorated and HAFELE accessories
173	CUPBOARDS	Vakko Cruise
174	CEILING	Varnished wood and decorative nonslippy carpets
175	FLOORS	Sony, 16 " plasma
176	TV	Sony
177	DVD PLAYER	Bose
178	AMPLIFIER	2+subwoofer, surround system - BOSE
179	SPEAKERS	Sony
180	CD PLAYERS WITH RADIO IN EACH CABIN	playstation 3
181	PLAYSTATION	Natural stones and laquering
182	BATHROOM CLADDING BATHROOM WORKTOPS AND GALLEY WORKTOP	Night Sky natural stones
183	IN MARBLE ACCESSORIES (TOWEL RACKS, PAPER HOLDER, SOAP DISH, BRUSH HOLDER, GRIP HANDLE, GLASS HOLDER)	HAFELE equipments. Cyrstal
184	MIRRORS	Ceramic sink and GRP tray
185	SHOWER TRAY & BATH TUB, SINK	Alu Framing
186	SHOWER PANELS WITH CLEAR GLASS	
187		

SRB 95 F TRAWLER YACHT

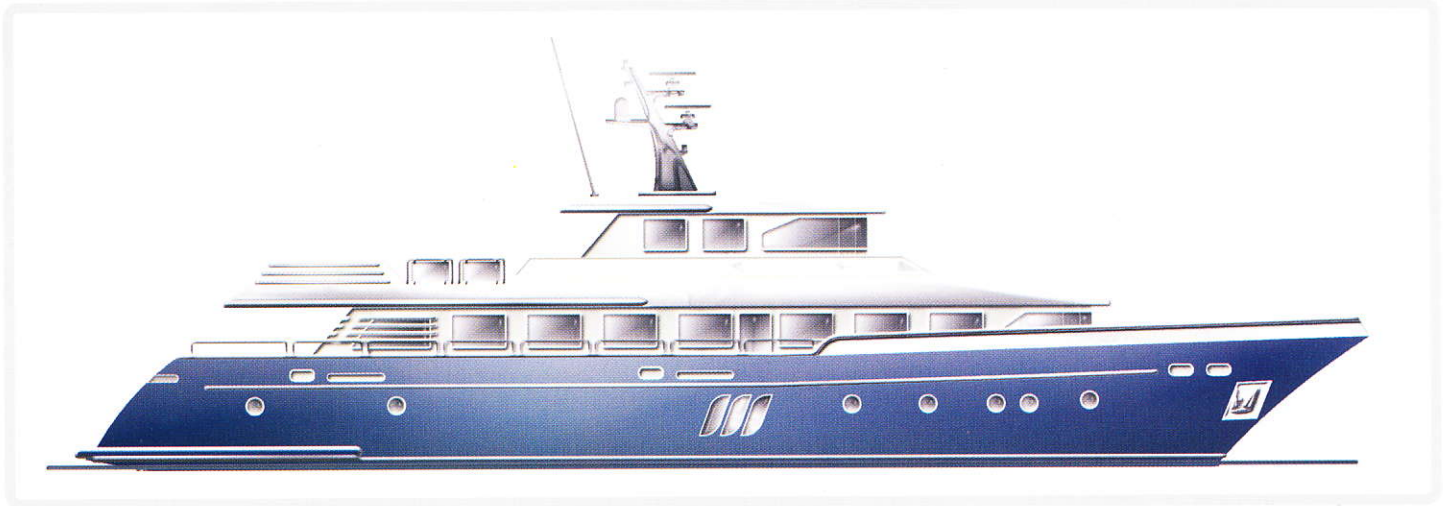

E SRB95 is a full functional de-lux trawler yacht .Her strong body is designed for luxury and comforting accomodations in any sea and wheather condition.

W SRB95 has an excellent design for a charter boat or any other conformable owner request.

C SRB95 has 7 guest cabins with upto 14 people accomodation and 2 cabins for a 3 membered crew.

I SRB95's interior is designed ideally for a 7 star hotel accomodation luxury. Best available elegant equipments are used for your and your guests cruising pleasure.

Our difference is relevant to your imagination. You imagine and we accomplish.

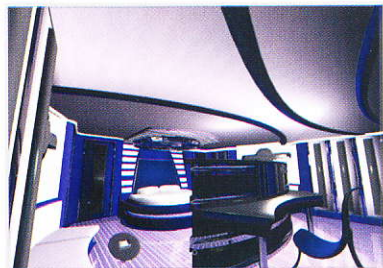
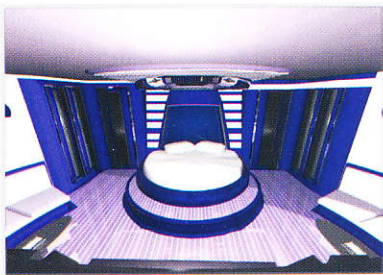

PROFILE

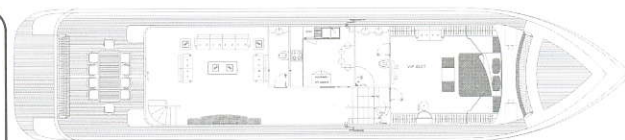

MAIN DECK



INTERIOR DECK

Length of overall	L _{OA} : 29,23 meters
Length water line	L _{WL} : 24,00 meters
Beam	B : 6,20 meters
Height	H : 8,20 meters
Deep	D : 4,91 meters
Draft	T : 2,00 meters
Displacement	V : 150,00 tones
Fuel tank capacity	: 22000 liters
Water tank capacity	: 5500 liters
Max number of people	: 14 + 5
Engine	: 2 X MAN 850 HP
Speed	: 17 Knots Max and 14 Knots Cruise

Designed By



www.saribey.com



NO	ITEM / DESCRIPTION	REMARK		
1	GENERAL DESIGN & MANAGEMENT			
2	DESIGN	Montana Design One Ship Building Engineer As Project Manager , Two Engineers For Site Surveys And Class Following		
3	PROJECT MANAGING			
4				
5	CLASSIFICATION			
6	CLASSIFICATION	Lloyd		
7	SURVEY, TEST & CERTIFICATE	RINA		
8				
9	HULL / DECK CONSTRUCTION			
10	MATERIAL	Marin grade steel for the hull and composite material for super structure		
11	WINDOWS	Tempered Glass And Marine Aluminium Frames		
12	DOORS AND OPENINGS	Composite and aluminium Doors And Aluminium Hatches		
13				
14	PAINT & FAIRING			
15	HULL INSIDE PAINT , PRIMER, EPOXY FAIRING 5 MM AVERAGE THICKNESS, TOP COAT PRIMER, TOP COAT PU	Jotun Paint Systems		
16	UNDERWATER COATING	Jotun Paint Systems		
17	INTERIOR			
18	PLYWOOD	Anegre and mahogany		
19	SOLID WOOD	Anegre		
20	STUDWORKS & TEMPORARY MATERIALS	HAFELE		
21	INSULATION BULKHEADS	70 M2, 30 MM Rockwool- A 60 Class		
22	GLUE, SCREW, BOLTS DOOR HANDLES, DOOR STOPS, LOCKS, GRILLS, TEFLON STRIPS, GENERAL FINISH ACCESSORY FITTINGS, LOCKER HANDLES, BARS, RAILS, SNAP ON FITTINGS	Stainless Steel And Sikaflex HAFELE door handles and connection accessories.		
23	FLOATING FLOOR MATERIALS & ELASTIC CUSHION	Sani Foam		
24				
25				
26	TEAK DECK			
27	CAPPING RAILS	40 Mm Thick		
28	DECKING	15 Mm Thick birmania teak		
29	SIKAFLEX, BONDING	Sikaflex		
30				
31	GENERAL MANUFACTURED OUTFITTING			
32	ALUMINUM FRAMED, SLIDING OPENING WINDOWS	8 OF 700X400		
33	PORTHOLES - CUSTOM MAKE 400X250 OVAL	24 + 2 CIRCULAR- 316 SS		
34	DECK HATCHES,	700X700 Mm		
35	STANCHIONS , 300 MM INTERVAL, DIA 32 316 SS			
36	DAVIT WITH MANUAL WINCH	Stainless Steel		
37	BOLLARDS	6, 600X250X300H, Stainless Steel		
38	FAIRLEADS	6, Of Double Sheave And Chafing		
39	SWIMMING LADDERS, SHIPTYPE WITH CONTROL P 2,	1of Each Side		
40	PASARELLA,	SS Framing,hydraulic, self pump Teak grating, 3.5M Long - folding in half, telescopic and 16degree vertical movement		
41	AFT TRANSOM WINDOWS	In stainless steel		
42	ANCHOR POCKETS & HAWSE PIPES IN SS316	To be inserted in hull shell		
43	FLAG POLE SS IN AFT DIA 60 MM	Stainless steel		
44	TABLE BASES	1 Fix in and out		
45	BIMINI TOP	Bimini top at flybridge		
46	BAR EQUIPMENT	1 in saloon and 1 in flybridge in the stack		
47	ENGINE ROOM			
48	MAIN ENGINE	2x 850 hp IVECO with ZF reduction gears		
49				
50	PROPULSION SYSTEM FOR ENGINE	Shafts 90MM, Rubber bearings - Brass Propeller		
51	EXHAUST SYSTEM	Silencer, Hoses, -clamps, expansion, insulation, hull fittings		
52	SEA WATER SYSTEM	Sea chest, water filter, fittings, hoses & clamps		
53	ENGINE CONTROL SYSTEM FOR DUAL STATION	Morse Single Control Handle With Conduit Wiring		
54	ENGINE CONTROL SYSTEM	Electronic, Morse Remote Shut Off Valve, Fuel Filter Racor Twin Cartridge, Fuel Hoses And Crimping, Valves & Fittings, Return Hoses And Crimping With Ss Fittings, Twin Filling Stations, Air Vent With Wire Mesh, Inspection Hatches, Paralel Line Outlets, Mechanical Level Gauges Fire Batt Rockwool, Sound Proofing Layer Insulation & Perforated Aluminum Surface Treatment.		
55	FUEL SYSTEM	One On Bow Bulkhead, one emergency to saloon.		
56	FUEL TANKS, INTEGRATED TO HULL STRUCTURE			
57	ENGINE ROOM INSULATION			
58	ENGINE ROOM WATERTIGHT DOORS			
59	PLUMBING			
60	FIRE & BILGE SYSTEM PIPING AND VALVES	Pvc- U		
61	DISCHARGE LINE FITTINGS AND PIPING	REINFORCED PLACTIC HOSE & SS CLAMPS		
62	FRESH & HOT WATER PIPING	Pe Piping With Brass Fittings		
63	TANK LEVEL GAUGES - VEMA SYSTEM	Fw, Gw, Bw, Fuel		
64	TANK LEVEL ALARMS	AYVAZ - LOW - HIGH		
65	BILGE ALARMS	Jabsco / Rule		
66	GENERAL CONSUMABLES	Sikaflex, Glue, Teflon Band Etc		
67	DECK WASH OUTLETS, DECK SHOWER OUTLETS			
68	ELASTIC HOSES AND SERVICE VALVES			
69	UV FILTERING			
70	WATER TANKS FILLERS, SERVICE HATCHES, AIR VENTS, FITTINGS, SUCTION HEADS			
71	INTEGRAL FRESH AND DIRTY WATER TANKS, WITH SPECIAL EPOXY COATINGS	2 Tons Of Water, 0.5 Tons Of Grey, 1.0 Tons Of Black Water		
72	CHAIN WASHING OUTLET & CONTROLS			
73				
74	ELECTRICAL			
75	GENERATOR SETS	2x Of Onan 50 kva		
76	FUEL, EXHAUST & SEA WATER SYS. FOR GEN SETS	(water & gas separation)		
77	BATTERY BANKS	Stationary Batteries 6x200ah		
78	START BATTERIES FOR MAIN ENGINE AND GENSE 1	4 OF 165 Ah		
79	24V/100 Ah BATTERY CHARGER, 2500 W INVERTER,	24/12 CONVERTER, 12 V BATTERY CHARGER 50 A		
80	DISTRIBUTION PANELS	24v /220 V At Console Main In E/R -3		
81	CABLE TRAYS & CABLES	Marine Grade		
82	SHORE CONNECTIONS	Marinco		
83	SWITCHES & PLUGS	VIMAR		
84	MAIN CONSOLE PANELS	Aluminum / Wood With Switches		
85	CEILING LIGHTS, DECORATIVE LAMPS,			
86	NAVIGATION LAMPS WITH DIMMERS	BCM and Centaluppi		
87	ENGINE ROOM AND BILGE LIGHTS			
88	GENERAL OUTFITTING			
89	BOW THRUSTER	Electrical, Side Power, 55 hp.		
90	WINDLASS	2x Electrical, Data, 3500 w		
91	ANCHOR & CHAIN	2x65 Kg, Dia 16 Chain 1x100m, 1x130 m.		
92	STEERING CYLINDER AND PUMPS	2 Station And Single Cylinder		
93	ELECTRICAL TOILET HEADS	Tecma 2 pieces		
94	FIXED FIRE FIGHTING SYSTEM WITH REMOTE CONTROL & ALARMS	CO2 System		
95	LIFERAFTS & LIFE BUOYS AND RINGS AIR CONDITIONING SYSTEM WITH ELECTRONIC CONTROLS AND CONSISTENT AIR GRILLS AND HOSES	Suitable For Ocean Crossing 3 units Marinair, totally 220,000 BTU		
96	SEARCH LIGHT	JABSCO 1000 W		
97	HORN	Marco - Dual		
98	INTERCOM AND INTERNAL TELEPHONE NETWORK			
99				
100	TELEPHONES IN CABINS		Siemens(Console+Galley+Master Cabin+ Guest Cabins)	
101	HELMSMAN SEATS IN MAIN CONSOLE		1 Inside +1 Stool Outside	
102				
103	BATHROOM EQUIPMENT			
104	BATHROOM CLADDING		Natural stones and laquering	
105	BATHROOM WORKTOPS AND GALLEY WORKTOP IN MARBLE		Night Sky natural stones	
106	ACCESSORIES (TOWEL RACKS, PAPER HOLDER, SOAP DISH, BRUSH HOLDER, GRIP HANDLE, GLASS HOLDER)		HAFELE equipments	
107	MIRRORS		Including Wardrobe Full Height Mirrors	
108	SHOWER TRAY & BATH TUB, SINKS CERAMIC		Ceramic sink and GRP tray	
109	SHOWER PANELS WITH CLEAR GLASS		Alu Framing	
110				
111	GALLEY EQUIPMENT			
112	MICROWAVE OVEN		Bosch	
113	ELECTRICAL OVEN		Bosch	
114	FULL HEIGHT REFRIGERATOR		Bosch	
115	EXTRACTOR FAN - INDUSTRIAL TYPE		Bosch	
116	DISHWASHER		Bosch	
117	WASHING MACHINE WIYH DRYER		Bosch	
118	STAINLESS OR ACRYLIC SINK & TAP			
119	ICEMAKER		Bosch	
120	WINE COOLER		For 12 bottles	
121				
122	ELECTRONICS & NAVIGATION - 2 STATION			
123	AUTOPILOT		Simrad	
124	RADAR, DEPTH SOUNDER, CHART PLOTTER		Simrad	
125	RADAR ANTENNA 24 NM		Simrad	
126	VHF - DUAL STATION		Simrad	
127	MAGNETIC COMPASS -2		Ritchie Or Equivalent	
128	CHART LIGHT			
129	ICOM SSB FOR OCEAN CROSSING		Option	
130	INMARSAT -M MINI M		Option	
131	SART & EPIRB (LIFE SAVING ELECTRONICS)			
132				
133	SALOON			
134	SOFA		Anegre and Vakko Cruise for 4 persons	
135	TABLE		Anegre and patesenk with riseble stainless leg	
136	CEILING		Vakko Cruise with hand made marcutary art cotonpiere,	
137	FLOORS		Varnished wood and decorative nonslipperycarpets	
138	FRIDGE		Bosch, 50 lt.	
139	TV		Sony, 42 " plasma	
140	DVD PLAYER		Sony	
141	AMPLIFIER		Bose	
142	SPEAKERS		5+subwoofer, home theatre system - BOSE	
143	CD PLAYERS WITH RADIO IN EACH CABIN		Sony	
144				
145	MASTER CABIN			
146	BED		King Size ,Latex, round anegre and mahogany wood study with marcutary art head board	
147	TABLE		Anegre and mahogany with riseble stainless leg	
148	MAKE UP TABLE		Anegre and mahogany	
149	WARDROPES		Anegre and mahogany	
150	CUPBOARDS		Anegre wood with mahogany decorated and HAFELE accessories	
151	SAFE		1 Pc., electronic and mechanic Vakko Cruise with hand made marcutary art cartonpiere and marcutary art central in the middle.	
152	CEILING		Varnished wood and decorative nonslipperycarpets	
153	FLOORS		Bosch, 35 lt.	
154	FRIDGE		Sony, 21 " plasma with hideble automatic mechanism.	
155	TV		Sony	
156	DVD PLAYER		Sony	
157	AMPLIFIER		Bose	
158	SPEAKERS		4+subwoofer, surround system - BOSE	
159	CD PLAYERS WITH RADIO		Sony	
160	BATHROOM CLADDING		Natural stones and laquering	
161	BATHROOM WORKTOPS AND GALLEY WORKTOP IN MARBLE		Night Sky natural stones	
162	ACCESSORIES (TOWEL RACKS, PAPER HOLDER, SOAP DISH, BRUSH HOLDER, GRIP HANDLE, GLASS HOLDER)		HAFELE equipments.	
163	MIRRORS		Crystal	
164	SHOWER TRAY & BATH TUB, SINKS CERAMIC		Ceramic sink and GRP tray	
165	SHOWER PANELS WITH CLEAR GLASS		Alu Framing	
166				
167				
168	QUEST CABINS AND CAPTAIN CABIN			
169	BEDS		Latex, round corners with mahogany arts around.	
170	WARDROPES		Anegre and mahogany	
171	CUPBOARDS		Anegre wood with mahogany decorated and HAFELE accessories	
172	CEILING		Vakko Cruise	
173	FLOORS		Varnished wood and decorative nonslipperycarpets	
174	TV		Sony, 16 " plasma	
175	DVD PLAYER		Sony	
176	AMPLIFIER		Bose	
177	SPEAKERS		2+subwoofer, surround system - BOSE	
178	CD PLAYERS WITH RADIO IN EACH CABIN		Sony	
179	BATHROOM CLADDING		Natural stones and laquering	
180	BATHROOM WORKTOPS AND GALLEY WORKTOP IN MARBLE		Night Sky natural stones	
181	ACCESSORIES (TOWEL RACKS, PAPER HOLDER, SOAP DISH, BRUSH HOLDER, GRIP HANDLE, GLASS HOLDER)		HAFELE equipments.	
182	MIRRORS		Crystal	
183	SHOWER TRAY & BATH TUB, SINK		Ceramic sink and GRP tray	
184	SHOWER PANELS WITH CLEAR GLASS		Alu Framing	
185				
186	CREW CABINS AND CREW SALOON			
187	BEDS		Latex	
188	WARDROPES		Anegre and mahAGONY	
189	CUPBOARDS		Anegre wood with mahogany decorated and HAFELE accessories	
190	CEILING		Vakko Cruise	
191	FLOORS		Varnished wood and decorative nonslipperycarpets	
192	BATHROOM CLADDING		Natural stones and laquering	
193	BATHROOM WORKTOPS AND GALLEY WORKTOP IN MARBLE		Night Sky natural stones	
194	ACCESSORIES (TOWEL RACKS, PAPER HOLDER, SOAP DISH, BRUSH HOLDER, GRIP HANDLE, GLASS HOLDER)		HAFELE equipments.	
195	MIRRORS		Crystal	
196	SHOWER TRAY & BATH TUB, SINK		Ceramic sink and GRP tray	
197	SHOWER PANELS WITH CLEAR GLASS		Alu Framing	
198	TV, CD PLAYER, DVD, AND GALLEY OUTFITTING			

SRB 110 MOTOR YACHT

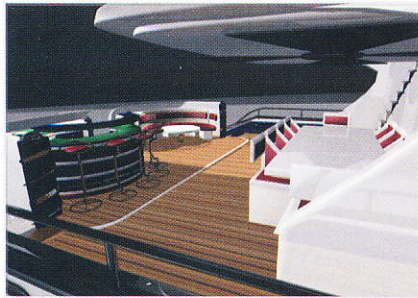
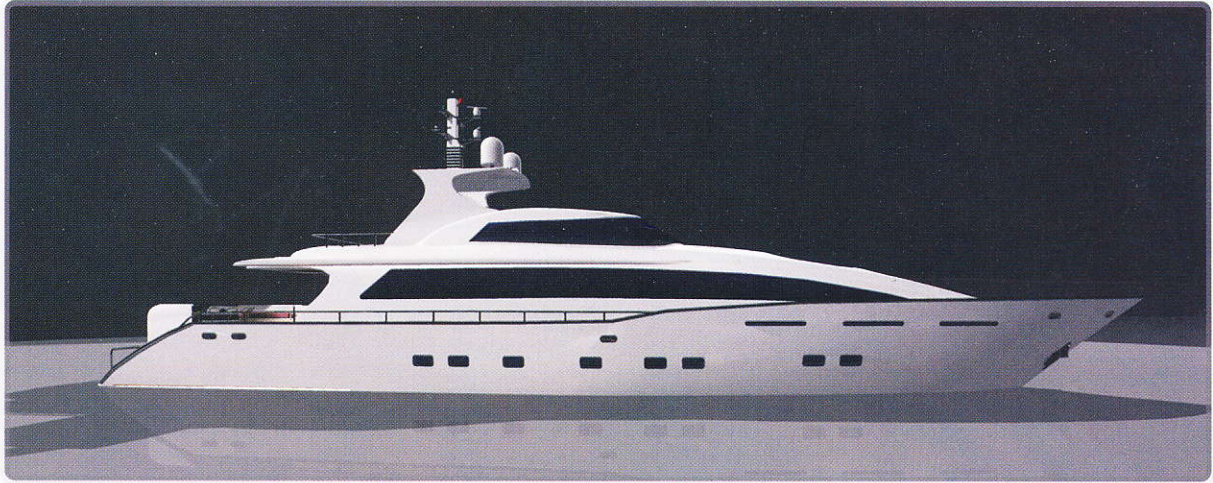

E SRB110 is a full functional de-lux motor yacht .Creative and functional designs make her a unique dream yacht for elite cruisers. (ex: convertible gaming table/sun deck)

W SRB110 is a state of quality motor yacht.

C SRB110 has 5 luxury guest cabins for 10 guests and 3 cabins for 5 crew members.

I SRB110's interior is designed for luxury and conforting cruising experiences. Guest cabins amenities are high-end modern equipment for best possible accomodation.

Our difference is relevant to your imagination. You imagine and we accomplish.

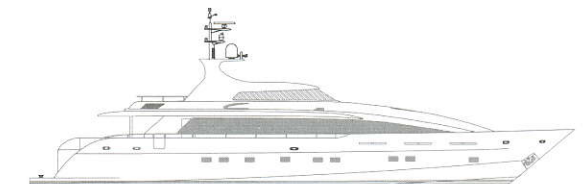
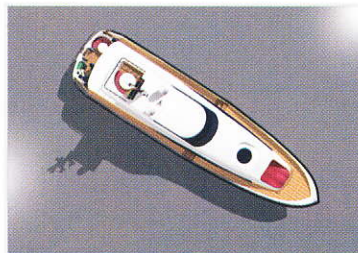

PROFILE

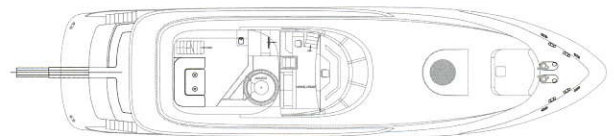

FLY DECK

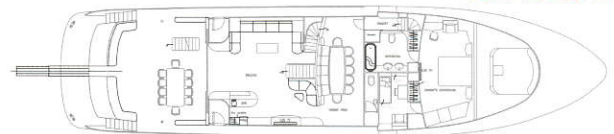

MAIN DECK

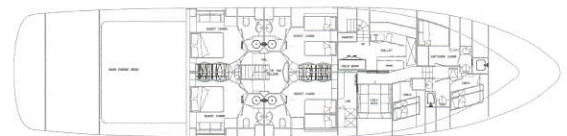

LOWER DECK

Length of overall	LOA : 33,70 meters
Length water line	LWL : 29.40 meters
Beam	B : 8,09 meters
Height	H : 9,30 meters
Deep	D : 3,70 meters
Draft	T : 1,50 meters
Displacement	V : 140,00 tones
Fuel tank capacity	: 27,000 liters
Water tank capacity	: 7070 liters
Max number of people	: 10 + 4
Engine	: 2 X DETROIT 1468 Hp
Speed	: 24 Knots max and 21 knots cruise

Designed By

SARIBEY

MARITIME



www.saribey.com



NO	ITEM / DESCRIPTION	REMARK
1	GENERAL DESIGN & MANAGEMENT	
2	DESIGN	Designed By Saribey Maritime One Ship Building Engineer As Project Manager , Two Engineers For Site Surveys And Class Following
3	PROJECT MANAGING	
4		
5	CLASSIFICATION	
6	CLASSIFICATION	Lloyd
7	SURVEY, TEST & CERTIFICATE	RINA
8		
9	HULL / DECK CONSTRUCTION	
10	MATERIAL	Epoxy- Fiber Composite
11	WINDOWS	Tempered Glass
12	DOORS AND OPENINGS	Aluminium and stainless steel
13		
14	PAINT & FAIRING	
15	HULL INSIDE PAINT , PRIMER, EPOXY FAIRING 5 MM AVERAGE THICKNESS, TOP COAT PRIMER, UNDERWATER COATING	Awlgrip Paint System Awlgrip Paint System
16		
17	INTERIOR	
18	PLYWOOD	Anegre And Palesenk
19	SOLID WOOD	Anegre
20	STUDWORKS & TEMPORARY MATERIALS	HAFELE
21	INSULATION BULKHEADS	70 M2, 30 MM Rockwool- A 60 Class
22	GLUE SCREW, BOLTS	Stainless Steel And Sikaflex
23	DOOR HANDLES, DOOR STOPS, LOCKS, GRILLS, TEFLON STRIPS, GENERAL FINISH ACCESSORY FITTINGS, LOCKER HANDLES, BARS, RAILS, SNAP ON FITTINGS	HAFELE door handles and connection accessories.
24	FLOATING FLOOR MATERIALS & ELASTIC CUSHION	Sani Foam
25		
26	TEAK DECK	
27	CAPPING RAILS	40 Mm Thick
28	DECKING	15 Mm Thick
29	BONDING	Sikaflex
30		
31	GENERAL MANUFACTURED OUTFITTING	
32	PORHOLE - CUSTOM MAKE 400X250 OVAL	24 + 2 CIRCULAR- 316 SS 700x700 Mm
33	DECK HATCHES	
34	STANCHIONS , 800 MM INTERVAL, DIA 32-316 SS	
35	DAVIT WITH MANUAL WINCH	Stainless Steel
36	BOLLARDS	6 600X250X300H, Stainless Steel
37	FAIRLEADS	6 Of Double Sheave And Chafing
38	SWIMMING LADDERS, SHIPTYPE WITH CONTROL P	2, 1of Each Side SS Framing hydraulic, self pump Teak grating, 2.5M Long- folding in half, telescopic
39	PASARELLA	In stainless steel
40	AFT TRANSOM WINDOWS	To be inserted in hull shell
41	ANCHOR POCKETS & HAWSE PIPES IN SS316	Stainless steel
42	FLAG POLE SS IN AFT DIA 60 MM	1 Fix in and out
43	TABLE BASES	Bimini top at flybridge
44	BIMINI TOP	1 in saloon and 1 in flybridge in the stack and one at aft deck
45	BAR EQUIPMENT	
46	ENGINE ROOM	
47	MAIN ENGINE	2x Detroit 16 V 92 TA, with ZF reduction gear
48		
49	PROPULSION SYSTEM FOR ENGINE	Shaft 90MM , Rubber bearings - Brass Propellers
50	EXHAUST SYSTEM	Silencer, Hoses, -clamps, expansion, insulation, hull fittings
51	SEA WATER SYSTEM	Sea chest, water filter, fittings, hoses & clamps
52	ENGINE CONTROL SYSTEM FOR DUAL STATION	Morse Single Control Handle With Conduit Wiring
53	ENGINE CONTROL SYSTEM	Electronic, Morse Remote Shut Off Valve, Fuel Filter Racor Twin Cartridge, Fuel Hoses And Crimping, Valves & Fittings, Return Hoses And Crimping With Ss Fittings, Twin Filling Stations, Air Vent With Wire Mesh, Inspection Hatches, Parallel Line Outlets, Mechanical Level Gauges
54	FUEL SYSTEM	Fire Batt Rockwool, Sound Proofing Layer Insulation & Perforated Aluminum Surface Treatment
55	FUEL TANKS, INTEGRATED TO HULL STRUCTURE	One On Bow Bulkhead, one emergency to saloon.
56	ENGINE ROOM INSULATION	
57	ENGINE ROOM WATERTIGHT DOORS	
58		
59	PLUMBING	
60	FIRE & BILGE SYSTEM PIPING AND VALVES	Cu-Ni
61	DISCHARGE LINE FITTINGS AND PIPING	Cu-Ni and fiber
62	FRESH & HOT WATER PIPING	Pe Piping With Brass Fittings
63	TANK LEVEL GAUGES - VEMA SYSTEM	Fw, Gw, Bw, Fuel
64	TANK LEVEL ALARMS	AYVAZ - LOW - HIGH
65	BILGE ALARMS	Jabsco / Rule
66	GENERAL CONSUMABLES	Sikaflex, Glue, Teflon Band Etc
67	DECK WASH OUTLETS, DECK SHOWER OUTLETS	
68	ELASTIC HOSES AND SERVICE VALVES	
69	UV FILTERING	
70	WATER TANKS FILLERS, SERVICE HATCHES, AIR VENTS, FITTINGS, SUCTION HEADS	
71	INTEGRAL FRESH AND DIRTY WATER TANKS, WITH SPECIAL EPOXY COATINGS	7Tons Of Water, 1.1 Tons Of Grey, 1.1 Tons Of Black Water
72	CHAIN WASHING OUTLET & CONTROLS	
73		
74	ELECTRICAL	
75	GENERATOR SETS	2 Of Northernlight 55 kva
76	FUEL, EXHAUST & SEA WATER SYS. FOR GEN SETS	(water & gas separation)
77	BATTERY BANKS	Stationary Batteries 8x200ah
78	START BATTERIES FOR MAIN ENGINE AND GENSET	4 OF 165 Ah
79	24V/100 Ah BATTERY CHARGER, 2500 W INVERTER, 24/12 CONVERTER, 12 V BATTERY CHARGER 50 A	
80	DISTRIBUTION PANELS	VICTRON 24v /220 V At Console Main In E/R -3
81	CABLE TRAYS & CABLES	Marine Grade
82	SHORE CONNECTIONS	Marinco
83	SWITCHES & PLUGS - VIMAR	
84	MAIN CONSOLE PANELS CEILING LIGHTS, DECORATIVE LAMPS, NAVIGATION LAMPS WITH DIMMERS	Aluminum / Wood With Switches BCM and Centaluppi
85	ENGINE ROOM AND BILGE LIGHTS	
86		
87		
88	GENERAL OUTFITTING	
89	BOW THRUSTER	Hydraulic, Tork Master, 32 hp
90	WINDLASS	Hydraulic, Data, 2x 2500 w
91	ANCHOR & CHAIN	2*55 Kg SS anchors , Dia 16, 1x Chain 100m, 1x130m
92	STEERING CYLINDER AND PUMPS	2 Station And Single Cylinder
93	ELECTRICAL TOILET HEADS	Tecma 6 pieces
94	CONTROL & ALARMS	System
95	LIFERAFTS & LIFE BUOYS AND RINGS AIR CONDITIONING SYSTEM WITH ELECTRONIC CONTROLS AND CONSISTENT AIR GRILLS AND HOOKS	Suitable For Ocean Crossing 3 units Cruise air, totally 54 000 BTU

97	SEARCH LIGHT	Sunshin 1200 w
98	HORN	Marco - Dual
99	INTERCOM AND INTERNAL TELEPHONE NETWORK	Karel
100	TELEPHONES IN CABINS	Siemens(Console+Galley+Master Cabin+ Guest Cabins)
101	HELMSMAN SEATS IN MAIN CONSOLE	1 Inside Besenzeni President +1 Stool Outside
102		
103	BATHROOM EQUIPMENT	
104	BATHROOM CLADDING	Natural stones and laquering
105	BATHROOM WORKTOPS AND GALLEY WORKTOP IN MARBLE	Night Sky natural stones
106	ACCESSORIES (TOWEL RACKS, PAPER HOLDER, SOAP DISH, BRUSH HOLDER, GRIP HANDLE, GLASS HOLDER)	HAFELE equipments
107	MIRRORS	Including Wardrobe Full Height Mirrors
108	SHOWER TRAY & BATH TUB, SINKS CERAMIC	Ceramic sink and GRP tray
109	SHOWER PANELS WITH CLEAR GLASS	Alu Framing
110		
111	GALLEY EQUIPMENT	
112	MICROWAVE OVEN	Bosch
113	ELECTRICAL OVEN	Bosch
114	FULL HEIGHT REFRIGERATOR	Bosch
115	EXTRACTOR FAN - INDUSTRIAL TYPE	Bosch
116	DISHWASHER	Bosch
117	WASHING MACHINE WIYH DRYER	Bosch
118	STAINLESS OR ACRYLIC SINK & TAP	
119	ICEMAKER	Bosch
120	WINE COOLER	For 12 bottles
121		
122	ELECTRONICS & NAVIGATION - 2 STATION	
123	AUTOPILOT	Sea ray
124	RADAR, DEPTH SOUNDER, CHART PLOTTER	Sea Ray
125	RADAR ANTENNA 3S NM	Sea Ray
126	VHF - DUAL STATION	Sea Ray
127	MAGNETIC COMPASS -2	Sea Ray
128	CHART LIGHT	Sea Ray
129	ICOM SSB FOR OCEAN CROSSING	Sea Ray
130	INMARSAT - M MINI M	Sea Ray
131	SART & EPIRB (LIFE SAVING ELECTRONICS)	Sea Ray
132		
133	SALOON	
134	SOFA	Anegre and Vakko Cruise for 10 persons
135	TABLE	Anegre and palesenk with riseble stainless leg
136	CEILING	Vakko Cruise with hand made marcutary art cotonpierre
137	FLOORS	Varnished wood and decorative nonslipperycarpets
138	FRIDGE	Bosch, 50 It
139	TV	Sony, 42 " plasma
140	DVD PLAYER	Sony
141	AMPLIFIER	Bose
142	SPEAKERS	5+subwoofer, home theatre system - BOSE
143	CD PLAYERS WITH RADIO IN EACH CABIN	Sony
144		
145	MASTER CABIN	
146	BED	King Size , Latex, round anegre and palesenk wood study with marcutary art head board.
147	TABLE	Anegre and palesenk with riseble stainless leg
148	MAKE UP TABLE	Anegre and palesenk with marcutary art studies on them
149	WARDROBES	Anegre wood with palesenk decorated and HAFELE accessories
150	CUPBOARDS	1 Pç., electronic and mechanic
151	SAFE	Vakko Cruise with hand made marcutary art cartonpierre and marcutary art central in the middle.
152	CEILING	Varnished wood and decorative nonslipperycarpets
153	FLOORS	Bosch, 35 It.
154	FRIDGE	Sony, 21 " plasma with hideble automatic mechanism.
155	TV	Sony
156	DVD PLAYER	Sony
157	AMPLIFIER	Bose
158	SPEAKERS	4+subwoofer, surround system - BOSE
159	CD PLAYERS WITH RADIO	Sony
160	BATHROOM CLADDING	Natural stones and laquering
161	BATHROOM WORKTOPS AND GALLEY WORKTOP IN MARBLE	Night Sky natural stones
162	ACCESSORIES (TOWEL RACKS, PAPER HOLDER, SOAP DISH, BRUSH HOLDER, GRIP HANDLE, GLASS HOLDER)	HAFELE equipments
163	MIRRORS	Crystal
164	SHOWER TRAY & BATH TUB, SINKS CERAMIC	Ceramic sink and GRP tray
165	SHOWER PANELS WITH CLEAR GLASS	Alu Framing
166		
167		
168	QUEST CABINS	
169	BEDS	2 X Single, 2X double Latex
170	WARDROBES	Anegre and palesenk with marcutary art studies on them
171	CUPBOARDS	Anegre wood with palesenk decorated and HAFELE accessories
172	CEILING	Vakko Cruise
173	FLOORS	Varnished wood and decorative nonslipperycarpets
174	TV	Sony, 16 " plasma
175	DVD PLAYER	Sony
176	AMPLIFIER	Bose
177	SPEAKERS	2+subwoofer, surround system - BOSE
178	CD PLAYERS WITH RADIO IN EACH CABIN	Sony
179	PLAYSTATION	playstation 3
180	BATHROOM CLADDING	Natural stones and laquering
181	BATHROOM WORKTOPS AND GALLEY WORKTOP IN MARBLE	Night Sky natural stones
182	ACCESSORIES (TOWEL RACKS, PAPER HOLDER, SOAP DISH, BRUSH HOLDER, GRIP HANDLE, GLASS HOLDER)	HAFELE equipments
183	MIRRORS	Crystal
184	SHOWER TRAY & BATH TUB, SINK	Ceramic sink and GRP tray
185	SHOWER PANELS WITH CLEAR GLASS	Alu Framing

Kalitest  *Kalitest*  *Kalitest*

ISO 9001 : 2000

ISO 14001

OHSAS 18001

SARIBEY

MARITIME

AYDINLI MAHALLESİ NİLÜFER SOKAK NO:16/2 TUZLA / İSTANBUL - TÜRKİYE
T: +90 216 393 18 10 F: +90 216 393 22 46 info@saribey.com ~ www.saribey.com