

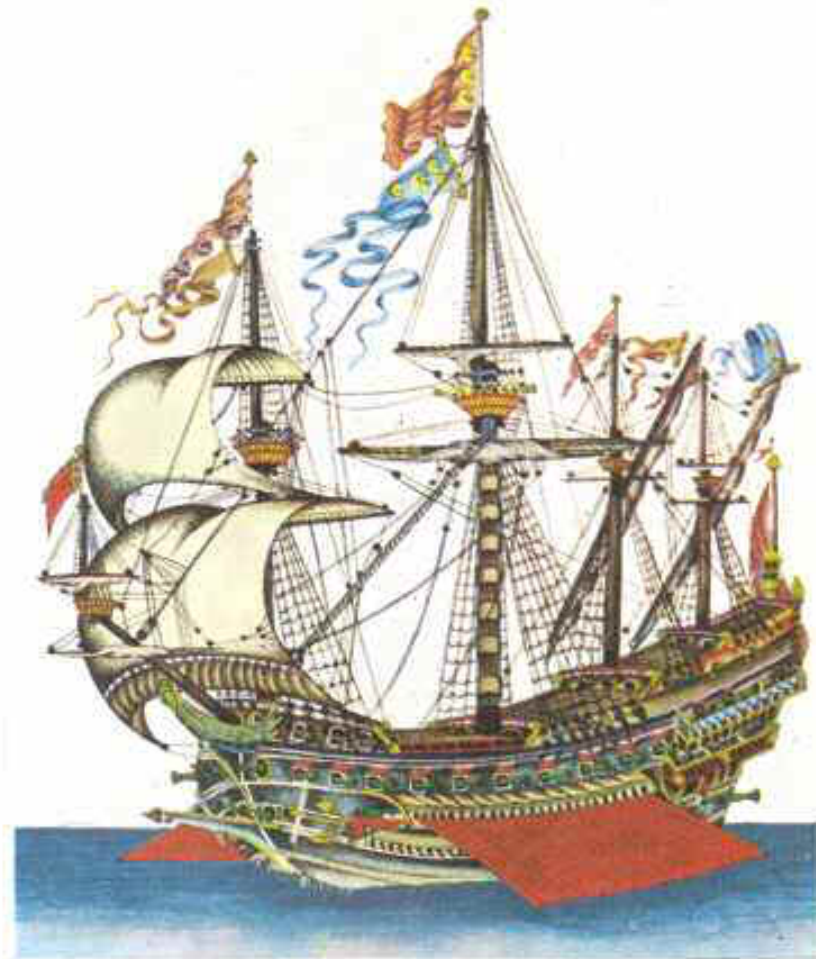

TAŞKIZAK NAVAL SHIPYARD



12 EKİM 1994



History

Taşkızak Shipyard was founded in 1455 by Fatih the Conqueror. In the following decades and centuries, through consistent progress, the yard reached the capability of building and maintaining most of the vessels in the Ottoman Navy.

Modernization began by early XIX. th century. In 1828, the first steamboat was built. And by 1886, the first Ottoman submarine had been realized.

After World War I, when Istanbul was announced a demilitarized zone, Taşkızak started working mainly on merchant vessels and most of the machinery and equipment, was transported to Gölcük, another military shipyard in the Sea of Marmara.

In 1941, Taşkızak was refounded. It employed virtually a handful of workers and a few engineers then and basically served the purpose of docking and repairing, besides building of small vessels.

Then started a period of growth. New workshops and building halls were erected and some of the old ones were restored. The Golden Horn was cleared for easier access to and from the sea.

All was set. Progress has gone on and on ever since.

Where are we today?

This booklet has been prepared to answer that question.

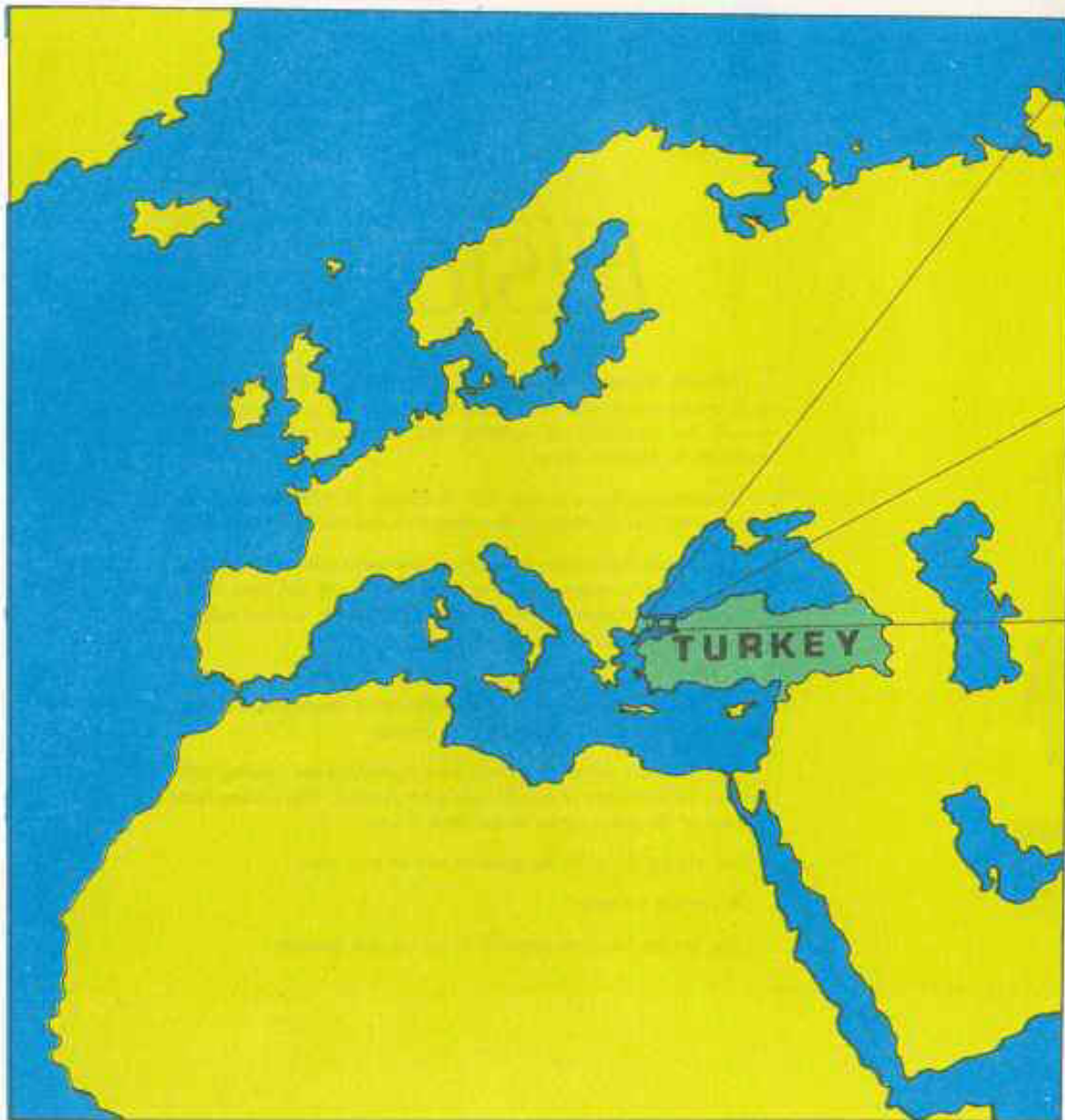

TASKIZAK NAVAL SHIPYARD
80480 HASKOY - ISTANBUL
TURKEY

Tel. : (90) - 212 - 254 54 44
Telex : 24 849 tk tk tr
Fax : (90) - 212 - 254 54 59

ORGANIZATION

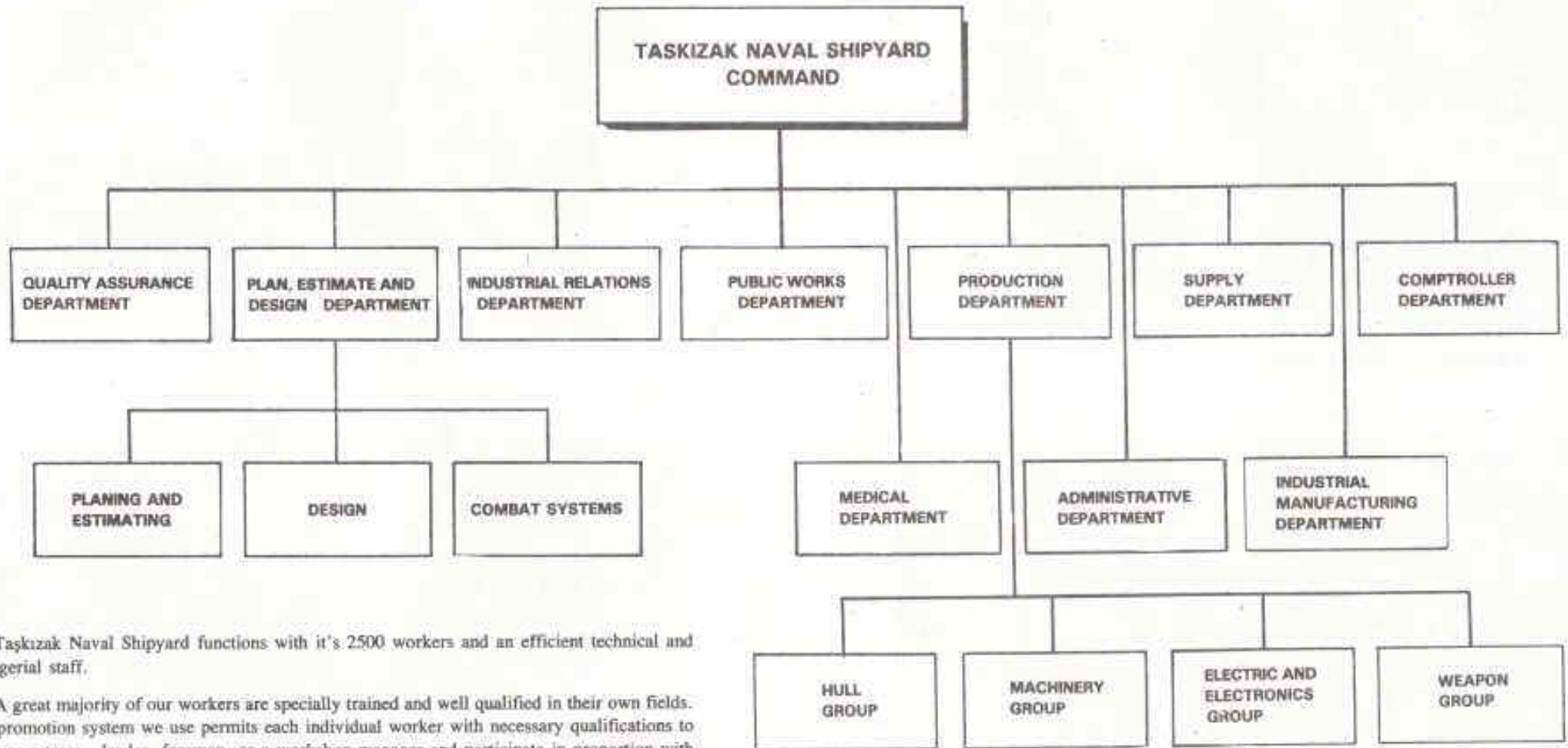

Taskizak Naval Shipyard functions with its 2500 workers and an efficient technical and managerial staff.

A great majority of our workers are specially trained and well qualified in their own fields. The promotion system we use permits each individual worker with necessary qualifications to serve as a team - leader, foreman, or a workshop manager and participate in proportion with his abilities for better production efficiency.

Taskizak's organization consists of 11 main departments. Those departments are jointly headed by a rear admiral and under his command about fifty officers from a core for decision - making and management of the yard.

MAIN ACTIVITIES



TWO FAST PATROL BOATS, A TUG BOAT AND A FLOATING DOCK PONTOON UNDER CONSTRUCTION



AN AUXILIARY SHIP ON A FLOATING DOCK

GENERAL

Taşkızak Naval Shipyard is located at a point virtually where the continents of Asia and Europe meet; on the Golden Horn which is an extension of the Sea of Marmara. In a way, this location symbolizes the merging of deeply rooted traditions and modern technology, and that of history and future.

Taşkızak Naval Shipyard is under the technical management of Turkish Naval Headquarters, Ankara. The functions we are involved with can be grouped in four basic sections :

(a) *New Construction*; which means designig, building, and outfitting of military and merchant vessels up to 10.000 DW tons.

(b) *Repair Work*; which includes the periodical maintenance, overhauling and repairing of about 160 ships, large and small, as per an annual plan; plus emergency repairs when needed.

(c) *Docking activities*; which consist of the planned dry - docking of the above mentioned ships. Taşkızak has two floating docks whose lifting capacities are 3000 tons and 2500 tons respectively, and an additional dry - dock for small vessels which brings the total docking capacity up to about 6000 tons.

(d) *Miscellaneous activities*; which cover all kinds of technical and practical assistance to military and industrial establishments in the area regarding any problems they might have with their mechanical, electric, and electronic equipment.



HULL REPAIR WORK ON THE FLOATING DRY DOCK



REPAIRING OF A ROTOR SHAFT



CONSTRUCTION AND TECHNICAL DRAWING OFFICE



DATA PROCESSING CENTER



SURVEYING THE UNDERWATER HULL OF A NAVAL VESSEL



RESEARCH AND DEVELOPMENT DEPARTMENT

PRODUCTION (C o n t)



UNDERWATER HULL CLEANING OF A FAST PATROL BOAT BY WATER JET



A DIESEL ENGINE ON THE TEST BENCH



WOOD WORKING



CONSTRUCTION OF A LST

QUALITY CONTROL, SUPPLY AND TRAINING



UNIVERSAL TESTING MACHINE



CHEMISTRY LABORATORY



TRAINING



A STORE OF SUPPLY DEPARTMENT

QUALITY CONTROL AND TRAINING PRODUCTION

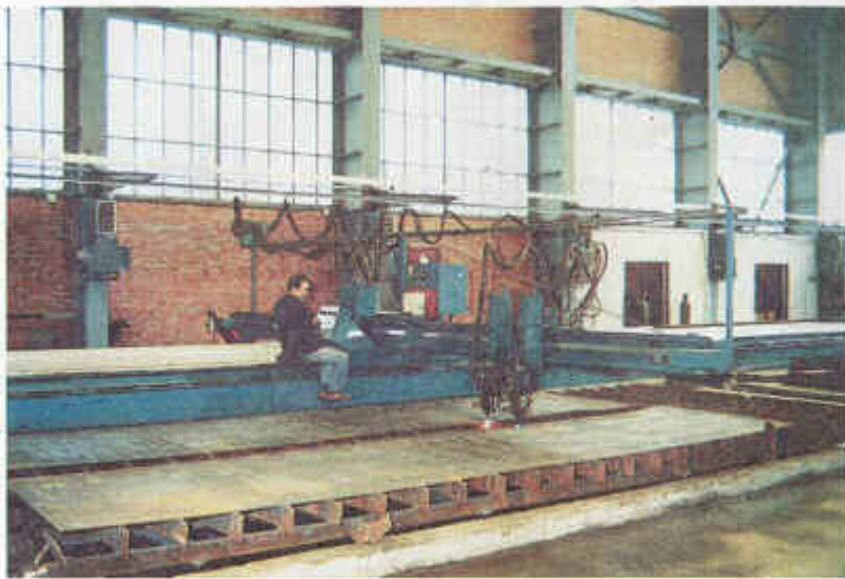

AUTOMATIC FLAME CUTTING



HYDRAULIC PRESS 300 TON CAPACITY



AN IMPELLER ON VERTICAL LATHE



FOUNDARY SHOP

A MILITARY SHIPYARD FIRST

Taşkızak, first of all, is a naval shipyard and construction of fast, modern naval vessels with relatively small tonnage and various types of modern landing vessels is our primary purpose and specialization.

Since 1941, we have completed about 140 ships, large and small. Among the naval vessels we have built are landing ships, patrol craft, coast - guard vessels, fast patrol boats, tankers, and coasters, floating docks, oceanography vessels.

Two of the most important projects we have now, are the fast patrol boats equipped with guided missiles and 4000 tons LST type landing ships.

Taşkızak uses the prefabricated - sections method for construction. Individual sections to from the hull are brought to the assembly area, when each section is completed. For the ships up to 400 displacement tons, we have a railed transport system. When the assembly of the hull and the super - structure is finished, the ship is placed on a special carriage. Upon completion of the outfitting, the ship is brought to the slipway via the rail system and launched.



FLOATING DOCK - PONTOON BEFORE LAUNCHING



SAR - 35 TYPE BOAT, BEING LAUNCHED

MERCHANT VESSELS TOO

The main slipway of the Taşkızak Naval Shipyard has an approximate length and breadth of 140 m. and 25 m. respectively. This enables us to construct ships up to 10.000 DW tons. In recent years, five tankers, 9500 DWT each - have been built in Taşkızak and put into service for Turkish Petroleum Office.

We also have built a 500 DWT cargo ship for Turkish Cargo Lines.

FROM FIBERGLASS BOATS TO FLOATING DOCKS

Taşkızak's considerably wide range of experience and technical potential enables it to build vessels varying from fiberglass sailboats to floating dry - dock which can lift ships of 2500 displacement tons. We should also note that our interest in fiberglass doesn't end with sailboats and that we have built large fiberglass vessels such as LCV type landing craft.

Among the other types of vessels we built, are yachts, motor boats, vessels for personnel transport, tug - boats, etc.



WOOD WORKING



CUSTOMS BOAT BUILT FOR MINISTRY OF CUSTOMS

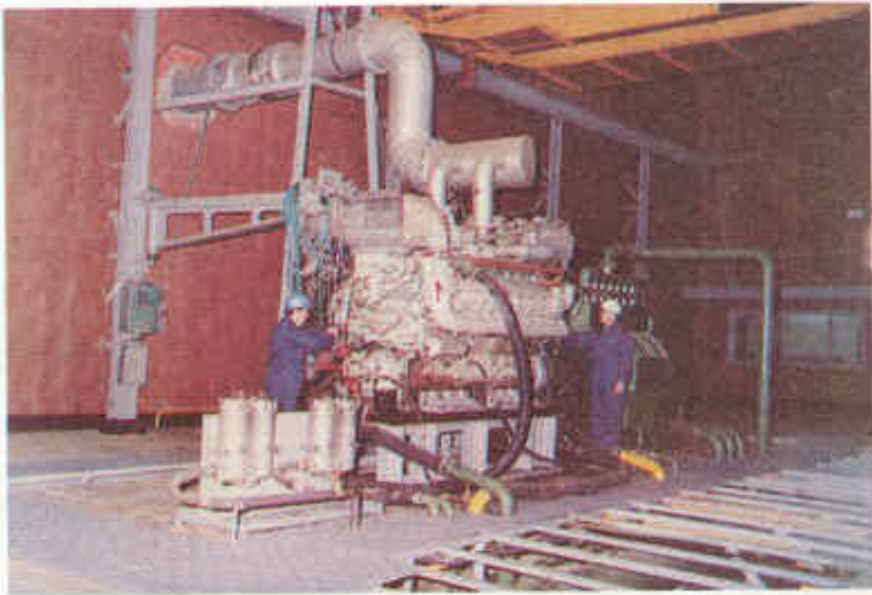

A DIESEL ENGINE ON TEST BENCH



CALENDERING PLANT



CARD TEST AND REPAIRING WORKSHOP ACTIVITIES



HEAT TREATMENT WORKSHOP



Since our shipyard was founded in 1455, more than 2500 vessels have been built and thousands of vessels in different types have been repaired.



We built very kind of vessels from tugs, crew and pilot boats to G/M fast attack boats, Patrol boats, Coast guard boats, Landing ships, Landing crafts, Tankers, Cargo ships, Oceanographic vessels, floating docks and floating cranes.



But you don't have to take our word for it. What we do can speak up for itself. In the following pages, you will find technical details and characteristics of various types of ships that have been and are being built in Taşkızak Naval Shipyard.

M O R E T H A N

2 5 0 0

V E S S E L S , W E H A V E B U I L T

- 1 - TCG RÜZGAR, FBP 57
- 2 - TCG Ç - 143, LANDING CRAFT TANK
- 3 - TCG SG 74, COASTGUARD BOAT TYPE SAR 35
- 4 - TCG GURBET, FPB 57
- 5 - TCG SARUCABEY, LANDING SHIP TANK
- 6 - FLOATING DOCK, 3500 t. LIFTING CAPACITY
- 7 - TCG DOGANARSLAN, TUG BOAT, 900 BHP
- 8 - TCG Ç - 145, LANDING CRAFT TANK
- 9 - TCG KARAMÜRSELBEY, LANDING SHIP TANK

FAST ATTACK BOAT

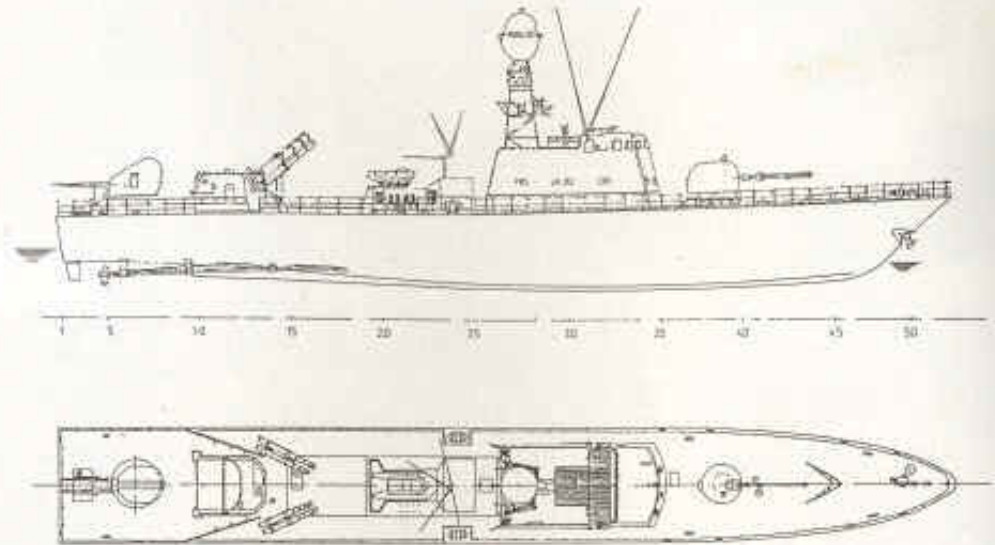

DOĞAN CLASS FAST ATTACK CRAFT

MAIN PARTICULARS :

LENGTH, OA	: 58.1 m.
LENGTH, WL	: 54.4 m.
BREADTH	: 7.62 m.
DEPTH	: 4.95 m.
DISPLACEMENT	: 400 TONS
MAIN ENGINES	: 4 - 16 CLY MTU DIESELS, 18.000 HP, 38 KNOTS
WEAPONS	: 8 - HARPOON GUIDED - MISSILES, 1 - 76 mm. OTOMELARA; 2 - 35 mm (TWIN) OERLIKON

COASTGUARD

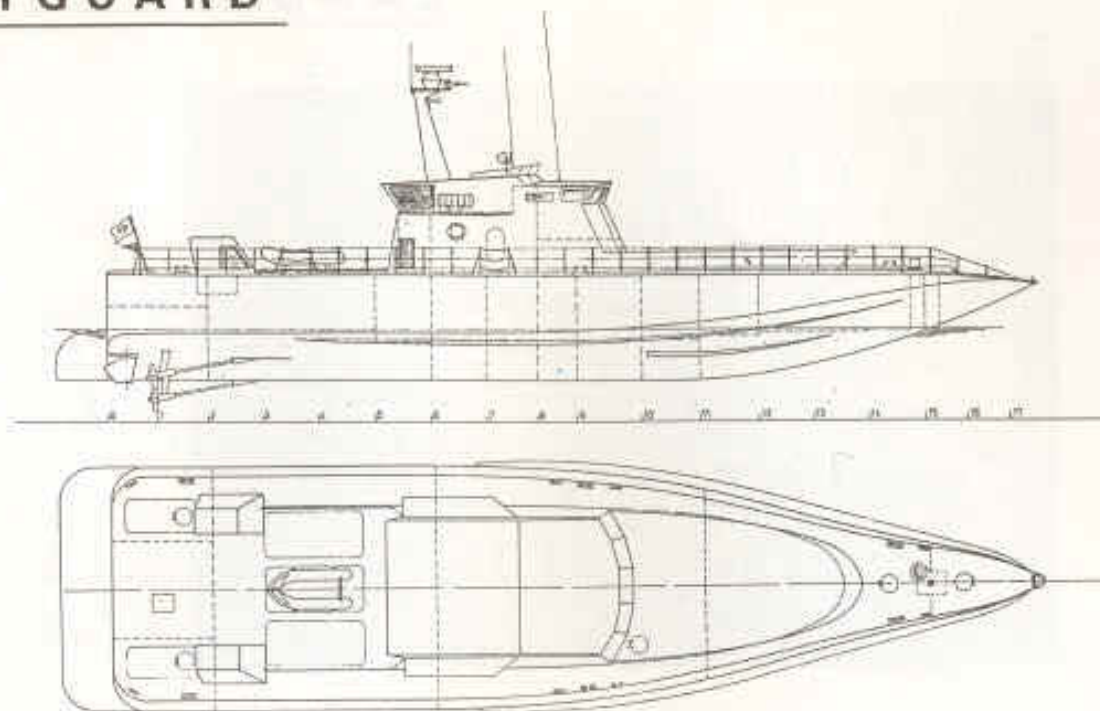

SAR - 33 TYPE FAST PATROL BOAT

MAIN PARTICULARS :

LENGTH, OA	: 34.8 m.
LENGTH, WL	: 29.5 m.
BREADTH	: 8.6 m.
DEPTH	: 3.7 m.
DISPLACEMENT	: 170 TONS
MAIN ENGINES	: 3 SACM DIESELS, 12000 HP, 38 KNOTS
WEAPONS	: 2 - 40 mm. BOFORS OR 1 - 35 mm (TWIN) OERLIKON OR 1 - 76 mm. OTOMELARA AND 4 PENGUIN SURFACE TO - SURFACE MISSILES

LANDING SHIP MEDIUM

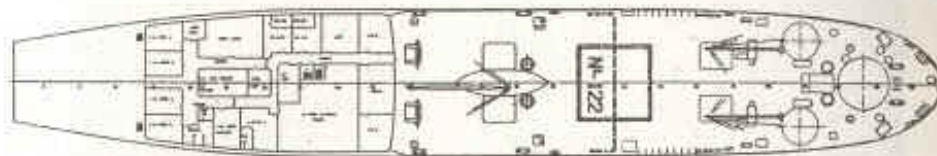
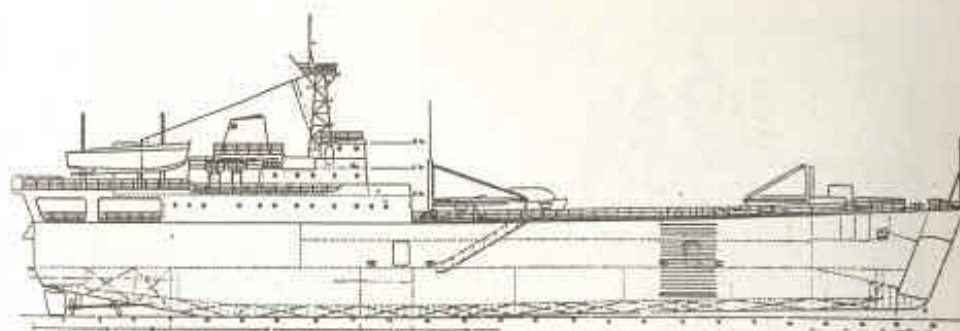

LSM TYPE LANDING SHIP AND MINELAYER

MAIN PARTICULARS :

LENGTH, OA	: 77.3 m.
LENGTH, WL	: 74.3 m.
BREADTH	: 12.0 m.
DEPTH	: 7.8 m.
DISPLACEMENT	: 1600 TONS
MAIN ENGINES	: 3 DIESELS, 4500 HP, 14 KNOTS
WEAPONS	: 3 - 40 mm. BOFORS, 2 - 20 mm. (TWIN) OERLIKON
ADDITIONAL FEATURES :	HELICOPTER PLATFORM 150 MINES, 9 M48 TANKS, 400 TROOPS, 10 JEEPS, 2 LCVP'S

LANDING SHIP TANK

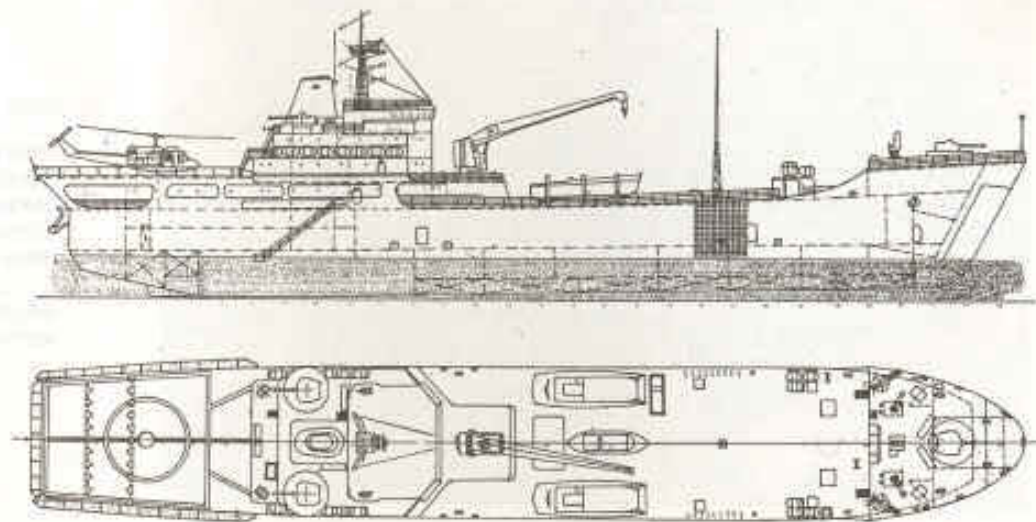

LANDING SHIP TANK (LST TYPE)

MAIN PARTICULARS :

LENGTH, OA	: 92.30 m.
LENGTH, WL	: 80.50 m.
BREADTH	: 14.00 m.
DEPTH	: 8.00 m.
DISPLACEMENT	: 3250 TONS
SPEED	: 12 KNOTS
CAPACITY	: 11 M48 TANKS or, 8 M35 TRUCKS 12 JEEPS 1 AB 212 ASW Helicopter

LANDING CRAFTS



LCT TYPE LANDING SHIP

MAIN PARTICULARS :

LENGTH, OA : 56.6 m.
BREADTH : 11.6 m.
DEPTH : 3.2 m.
DISPLACEMENT : 600 TONS (FULL LOAD)
MAIN ENGINES : 3 x GM DIESELS, 900 HP, 10 KNOTS
WEAPONS : 2 - 20 mm. OERLIKON
ADDITIONAL FEATURES : 5 - M48 TANKS, 100 TROOPS

LCU TYPE LANDING CRAFT

MAIN PARTICULARS :

LENGTH, OA : 44.3 m.
LENGTH, WL : 40.8 m.
BREADTH : 8.8 m.
DEPTH : 2.7 m.
DISPLACEMENT : 320 TONS (LIGHT SHIP)
 405 TONS (FULL LOAD)
MAIN ENGINES : 2 GM DIESELS, 600 HP, 10 KNOTS
WEAPONS : 2 - 20 mm. OERLIKON

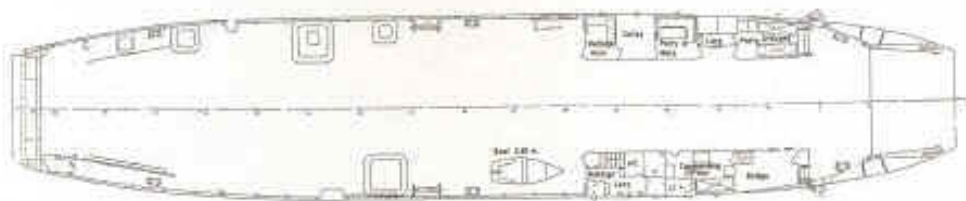
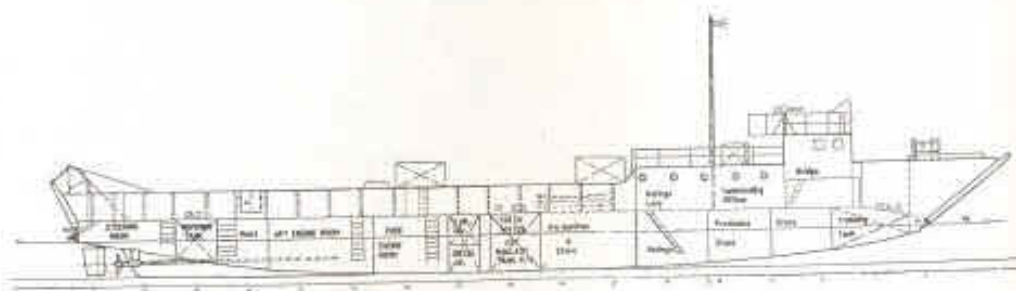
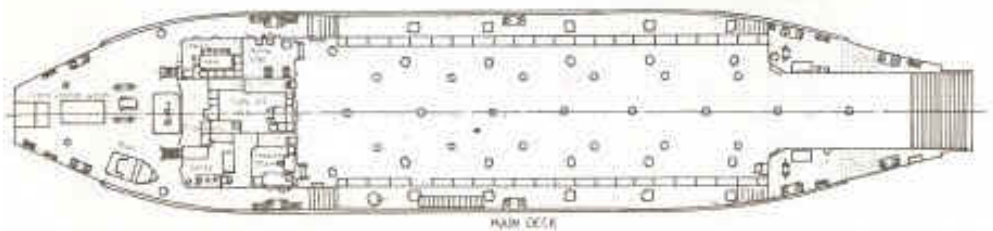
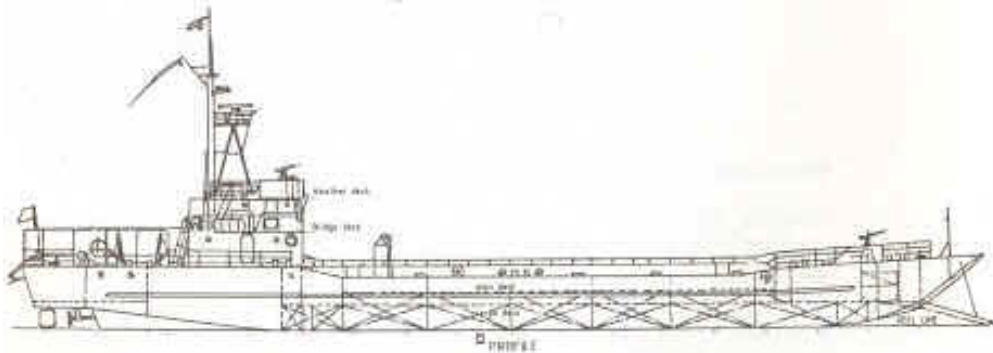

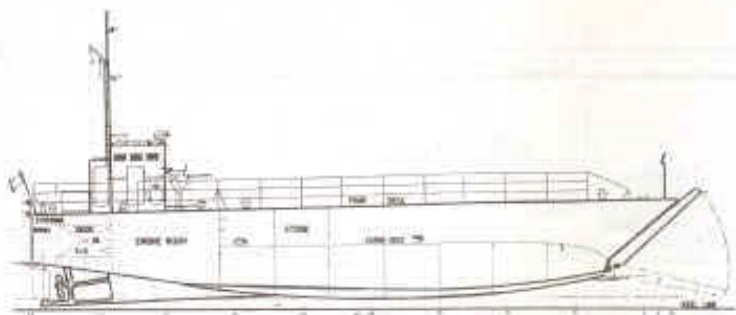

LCM 8 TYPE LANDING CRAFT

MAIN PARTICULARS :

LENGTH, OA	: 22.34 m.
BREADTH	: 6.39 m.
DEPTH	: 2.87 m.
DISPLACEMENT	: 113,390 TONS (FULL LOAD)
MAIN ENGINES	: 2 x 450 HP, 10 KNOTS

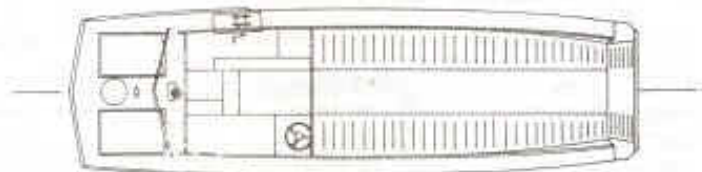
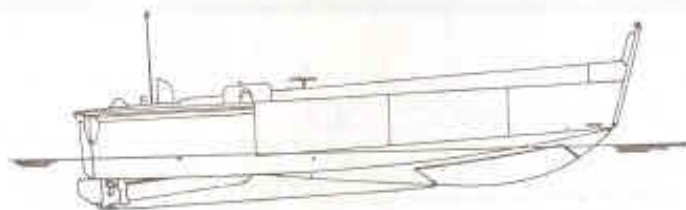

LCVP TYPE LANDING CRAFT

MAIN PARTICULARS :

LENGTH, OA	: 10.43 m.
BREADTH	: 3.21 m.
DEPTH	: 1.83 m.
DISPLACEMENT	: 10 TONS
MAIN ENGINES	: 95 HP, 10 KNOTS
FEATURE	: 1 JEEP AND 4 TROOPS

FLOATING DOCKS

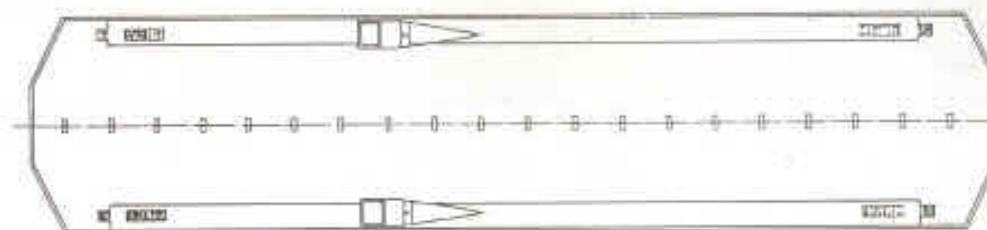
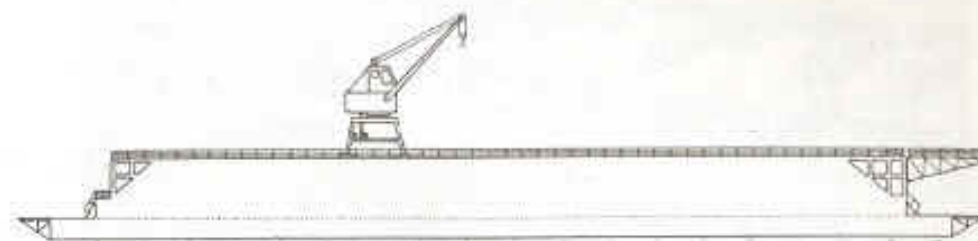

FLOATING DRY DOCK I

MAIN PARTICULARS	:
LENGTH, OA	: 110.00 m.
INNER BREADTH	: 16.18 m.
OUTER BREADTH	: 21.8 m.
DEPTH	: 10.50 m.
LIFTING CAPACITY	: 2500 TON

FLOATING DRY DOCK II

MAIN PARTICULARS	:
LENGTH, OA	: 116.48 m.
INNER BREADTH	: 21.20 m.
OUTER BREADTH	: 26.378 m.
DEPTH	: 10.00 m.
LIFTING CAPACITY	: 3000 TON

FLOATING DRY DOCK III

MAIN PARTICULARS	:
LENGTH, OA	: 115.95 m.
INNER BREADTH	: 24.15 m.
OUTER BREADTH	: 30.15 m.
DEPTH	: 11.25 m.
LIFTING CAPACITY	: 3500 TON

TUG BOATS

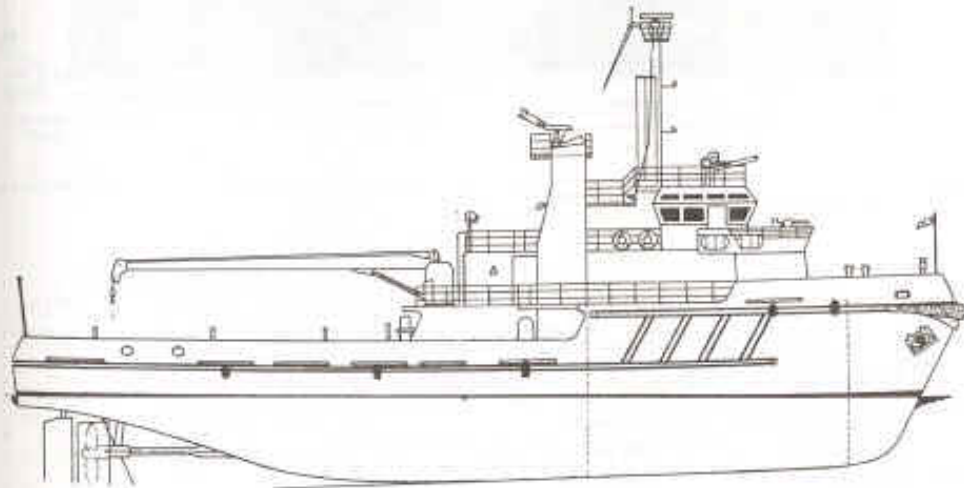

TUG/TORPEDO RETRIEVER

MAIN PARTICULARS :

LENGTH, OA	: 40.87 m.
LENGTH, WL	: 39.18 m.
BREADTH	: 9.8 m.
DEPTH	: 5.00 m.
SPEED	: 14 KNOTS
PULLING CAPACITY	: 30 TONS

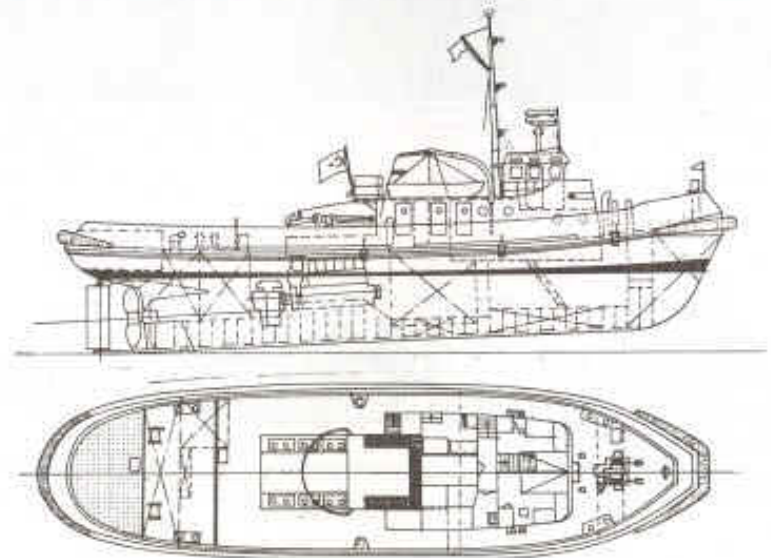

HARBOUR TUG

MAIN PARTICULARS :

LENGTH, OA	: 26.15 m.
LENGTH, WL	: 24.35 m.
BREADTH	: 6.70 m.
DEPTH	: 4.08 m.
SPEED	: 12 KNOTS
PULLING CAPACITY	: 10 TONS

PATROL/COASTGUARD BOAT

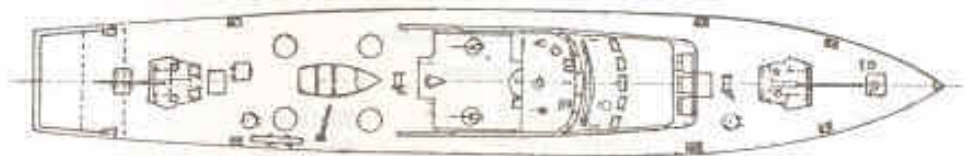

AB AND J TYPE PATROL CRAFT

MAIN PARTICULARS :

LENGTH, OA	: 40.4 m.
BREADTH	: 6.4 m.
DEPTH	: 3.9 m.
DISPLACEMENT	: 162 TONS
MAIN ENGINES	: 2 DIESELS, 3200 HP, 22 KNOTS OR 2 DIESELS, 4800 HP, 26 KNOTS
WEAPONS	: 2 - 40 mm. BOFORS, 2 - 50 CAL. MACHINE GUN, DEPTH CHARGE

OCEANOGRAPHIC VESSEL

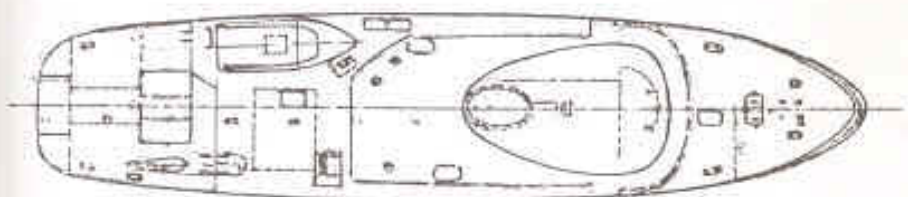
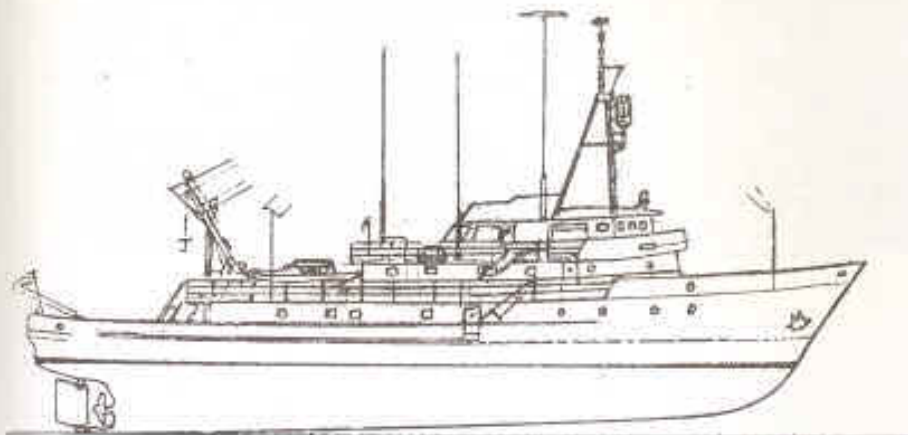

OCEANOGRAPHIC RESEARCH VESSEL

MAIN PARTICULARS :

LENGTH, OA : 40.4 m.
LENGTH, WL : 36.4 m.
BREADTH : 9.6 m.
DEPTH : 4.4 m.
DISPLACEMENT : 512 TONS
MAIN ENGINES : 1 MVM DIESELS, 820 HP.

COASTAL CARGO SHIP

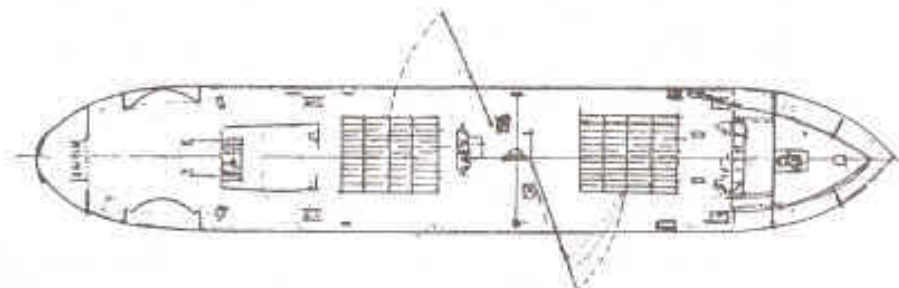
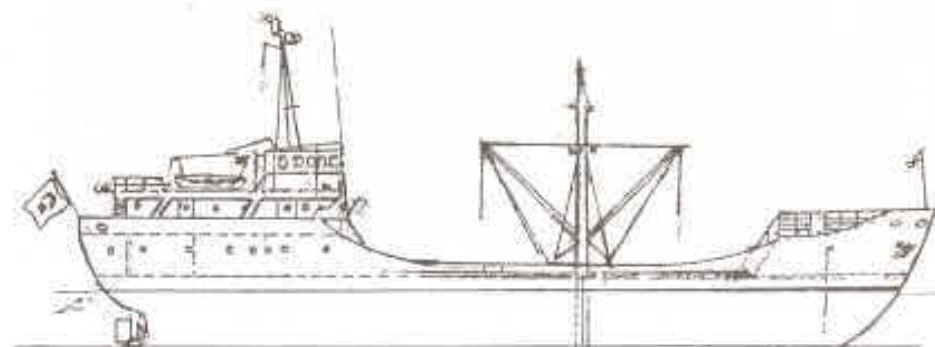
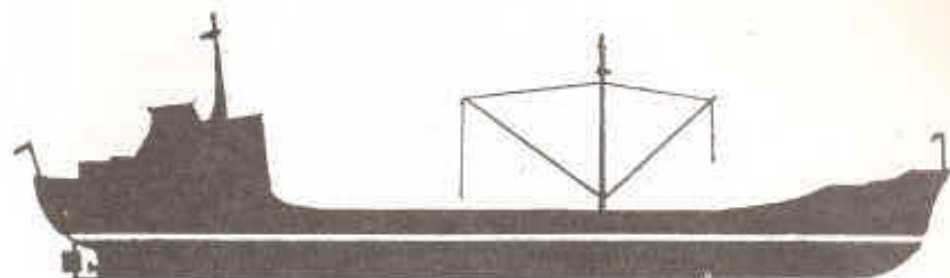

500 DWT COASTER

MAIN PARTICULARS :

LENGTH, OA : 50.7 m.
LENGTH, WL : 47.4 m.
BREADTH : 8.0 m.
DEPTH : 3.6 m.
DISPLACEMENT : 823 TONS (FULL LOAD)
MAIN ENGINES : DIESEL 1440 HP, 12 KNOTS

TANKERS

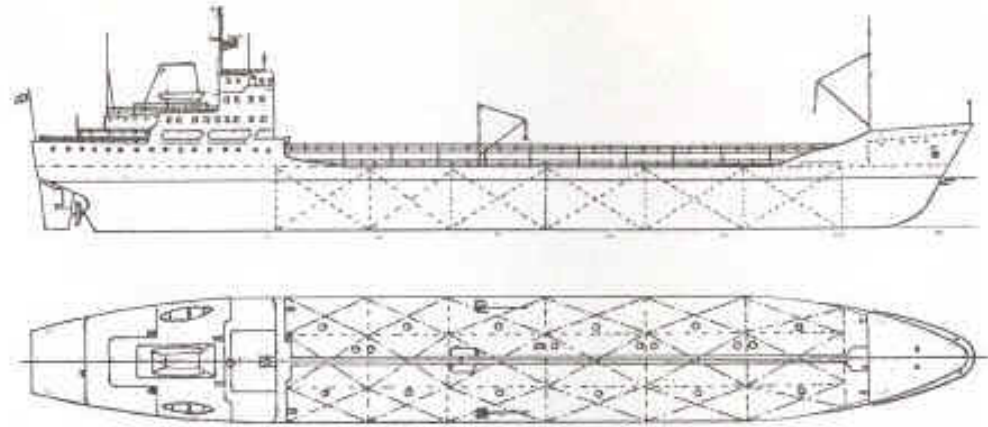

6000 DWT TANKER

MAIN PARTICULARS :

LENGTH, OA	: 111.1 m.
LENGTH, WL	: 108.7 m.
BREADTH	: 16.1 m.
DEPTH	: 8.2 m.
DISPLACEMENT	: 7700 TONS (FULL LOAD)
MAIN ENGINES	: DIESELS 4800 HP, 13.5 KNOTS

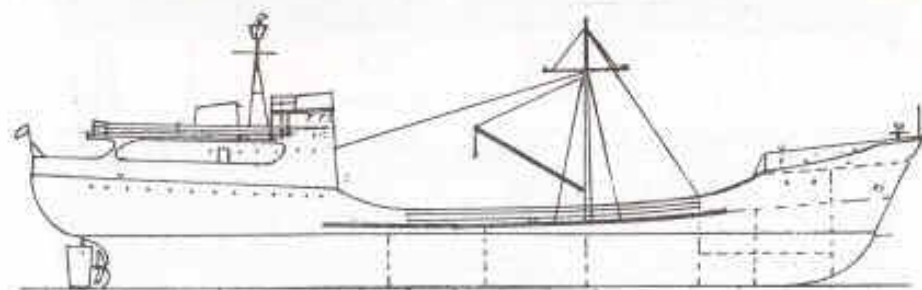
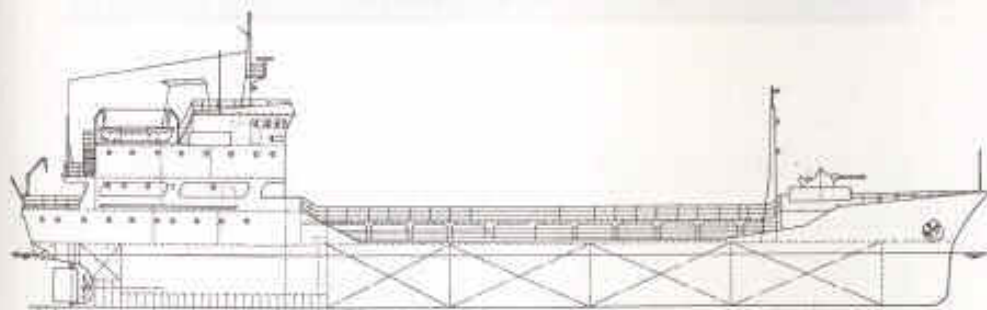

1000 DWT TANKER

MAIN PARTICULARS :

LENGTH, OA : 64.60 m.
LENGTH, WL : 61.20 m.
BREADTH : 9.40 m.
DISPLACEMENT : 1400 TONS
MAIN ENGINES : DIESEL - 1440 BHP, 14 KNOTS

530 DWT WATER TANKER

MAIN PARTICULARS :

LENGTH, OA : 51.8 m.
LENGTH, WL : 46.8 m.
BREADTH : 8.1 m.
DEPTH : 3.6 m.
DISPLACEMENT : 850 TONS (FULL LOAD)
MAIN ENGINES : DIESEL, 480 HP, 10 KNOTS

CARGO SHIP

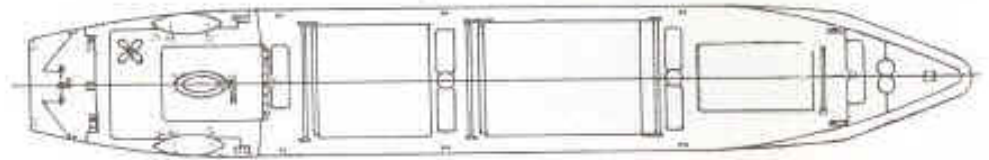
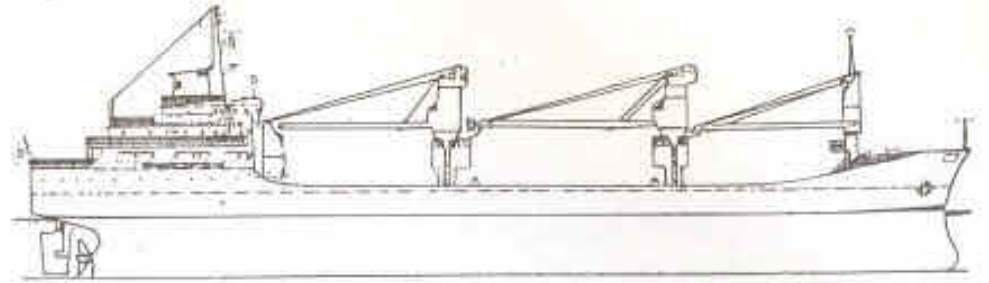

5500 DWT CARGO SHIP

MAIN PARTICULARS :

LENGTH, OA	: 108.7 m.
LENGTH, WL	: 102.4 m.
BREADTH	: 17.0 m.
DEPTH	: 9.4 m.
DISPLACEMENT	: 8500 TONS (FULL LOAD)
MAIN ENGINES	: DIESEL, 5400 HP, 15 KNOTS

SMALL CRAFTS

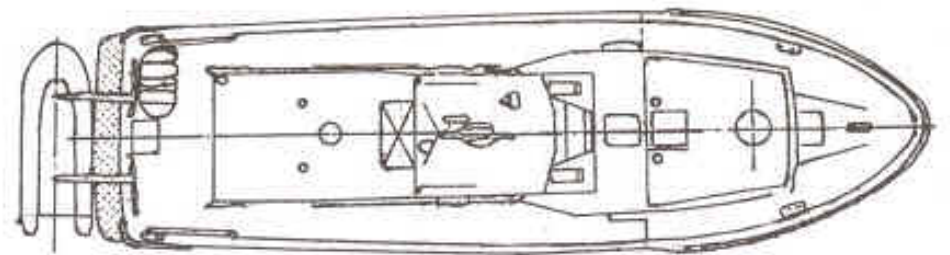
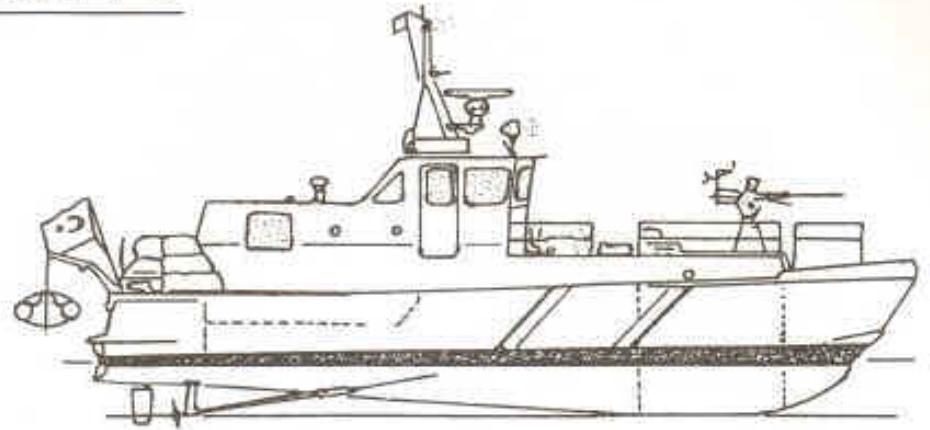

MAIN PARTICULARS

LENGTH OVERALL	: 14.80 m.
LENGTH WATERLINE	: 13.70 m.
BREADTH	: 4.20 m.
DRAFT	: 1.20 m.
DISPLACEMENT (LIGHT SHIP)	: 25 - 10 t.
DISPLACEMENT (FULL LOAT)	: 14 - 16 KNOTS
CREW	: 6 PERSON

